

PROPOSED NAHARGARH BIOLOGICAL PARK, JAIPUR (RAJASTHAN)

SCALE:- 1:4000

AREA :- 720 Hactares

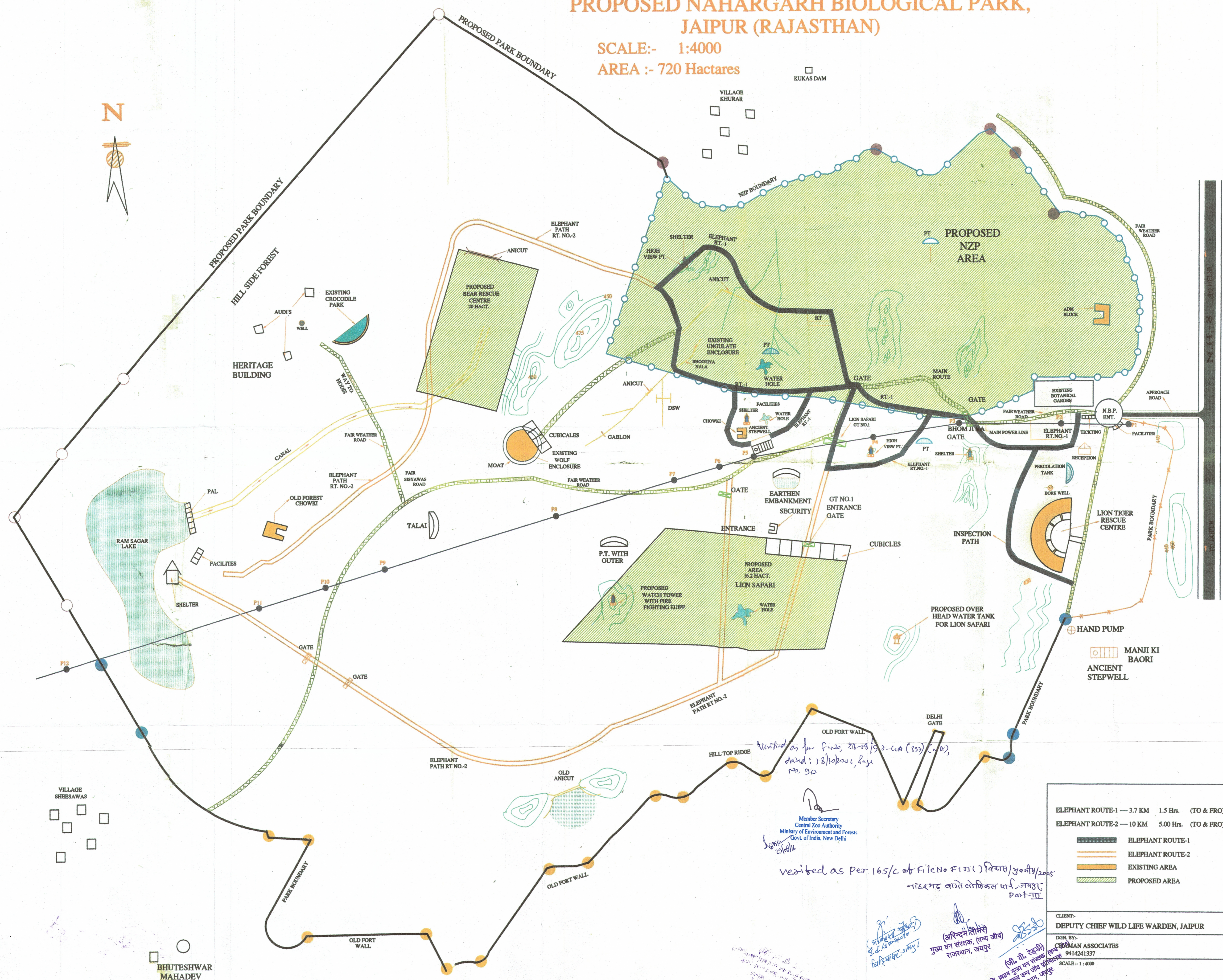
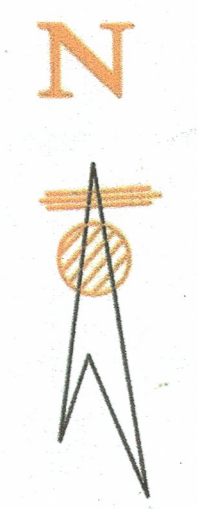

Member Secretary
Central Zoo Authority
Ministry of Environment and Forests
Govt. of India, New Delhi

Verified as per 165/C of File No F177(1) वि.रा.प./2005
नाहरगढ़ बायो लोफिकल पार्क, जयपुर
Part-II

ELEPHANT ROUTE-1 — 3.7 KM	1.5 Hrs.	(TO & FRO)
ELEPHANT ROUTE-2 — 10 KM	5.00 Hrs.	(TO & FRO)
	ELEPHANT ROUTE-1	
	ELEPHANT ROUTE-2	
	EXISTING AREA	
	PROPOSED AREA	
CLIENT:- DEPUTY CHIEF WILD LIFE WARDEN, JAIPUR		
DGN. BY:- S. K. MANI S. K. MANI ASSOCIATES 9414241337		
SCALE:- 1:4000		

BHUTESHWAR
MAHADEV