

# JUNGLEMAHAL ZOOLOGICAL PARK, JHARGRAM

## REVISED MASTER LAYOUT PLAN

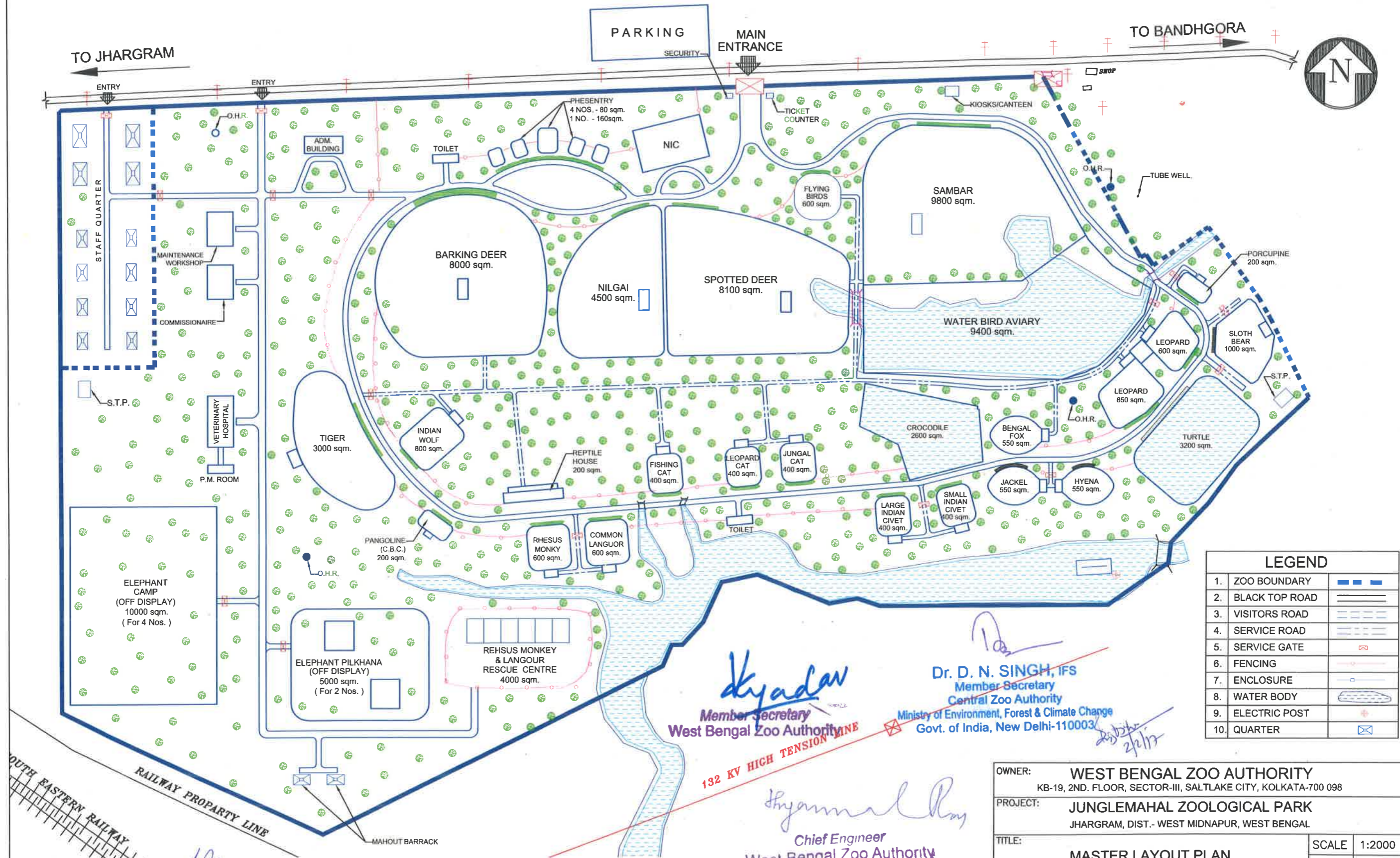

LEGEND		
1.	ZOO BOUNDARY	— — — — —
2.	BLACK TOP ROAD	=====
3.	VISITORS ROAD	-----
4.	SERVICE ROAD	- - - - -
5.	SERVICE GATE	⊗
6.	FENCING	⋯⋯⋯
7.	ENCLOSURE	□
8.	WATER BODY	~~~~~
9.	ELECTRIC POST	+
10.	QUARTER	⊞

  
**Dr. D. N. SINGH, IFS**  
 Member Secretary  
 Central Zoo Authority  
 Ministry of Environment, Forest & Climate Change  
 Govt. of India, New Delhi-110003

  
**Chief Engineer**  
 West Bengal Zoo Authority

**ZOO AREA - 22.488 HECTARE (55.570 ACRES)**

  
**Sub - Assistant Engineer**  
 West Bengal Zoo Authority

OWNER:		<b>WEST BENGAL ZOO AUTHORITY</b>	
		KB-19, 2ND. FLOOR, SECTOR-III, SALT LAKE CITY, KOLKATA-700 098	
PROJECT:		<b>JUNGLEMAHAL ZOOLOGICAL PARK</b>	
		JHARGRAM, DIST.- WEST MIDNAPUR, WEST BENGAL	
TITLE:		<b>MASTER LAYOUT PLAN</b>	
		SCALE	1:2000
		DATE	22.12.15
APPROVE BY	DRAWN BY	DRG. NO.	SHEET REV
	A. KHAN	WBZA/DE/D7/MLP	1 OF 1 1

Master (Layout) Plan of Junglemahal Zoological Park, Jhargram was approved by the Technical Committee of