

Pimpri Chinchwad Municipal Corporation



NISARGAKAVI
BAHINABAI CHOUDHARY
PRANISANGRAHALAY

Sambhaji Nagar, Chinchwad, Pune - 411 019

ANNUAL REPORT
2019-20





Pimpri Chinchwad Municipal Corporation



NISARGAKAVI BAHINABAI CHAUDHARY PRANISANGRAHALAY

Sambhaji Nagar, Chinchwad, Pune - 411 019

Maharashtra, India

E-MAIL: zoo@pcmcindia.gov.in

WEBSITE: www.pcmcindia.gov.in

ANNUAL REPORT 2019-20



PREFACE

Pimpri Chinchwad is commonly known for automobile and industrial hub. The growth of population and emerging IT hub has compelled to develop many other projects in respect to education, research, culture and entertainment fields. Considering the needs of the time, the zoo in city which is working from 1989 is being modified to requirements of the modern era. Nisargakavi Bahinabai Choudhary Pranisangrahalay or previously 'Snake Park and Aviary' is one such project.

PCMC zoo has developed an all-of-Zoo operation plan reflecting work in all aspects of Zoo operation. Creation and conservation of urban green-scapes has been given priority in its planning. Nisargakavi Bahinabai Choudhary Pranisangrahalay (PCMC Zoo) has been a small category zoo owing to its finite area of 7.05 Acres. Recent Central Zoo Authority guidelines have clearly instructed area of requirements for housing of various collections. It has been a challenge to fit a theme that considers geographical area, guidelines and attraction for the visitors. All these factors have been aptly considered in deciding the theme as "REPTILES AND AVIARY". The proposed facility is expected to house 31 species of snakes, 2 species of monitor lizard, 13 species of turtles and tortoises, 2 varieties of crocodiles and 14 species of wetland birds.

This zoo aims to develop as one of the world's best small zoo, leading the way in animal care, conservation work, community and school education programs and environmental management. Pimpri Chinchwad Municipal Corporation is committed to indulge in wildlife conservation and awareness.



Shri. Santosh Patil

Additional Commissioner

Pimpri Chinchwad Municipal Corporation

Management Personnel of the zoo

It gives us great pleasure to bring forth the annual report for the year 2019-20. Our dedicated colleagues in Pimpri Chinchwad Municipal Corporation have been working hard to develop this facility for the benefit of public and animals as well. We are indebted to all of them. We express our gratitude to the following officials and dignitaries of the Pimpri-Chinchwad Municipal Corporation, without the help of whom this zoo would never have taken shape.

Mrs. Ushatai Dhore, Mayor

Mr. Shravan Hardikar, I.A.S., Commissioner

Mr. Santosh Patil, Additional Commissioner

Mr. Dattatray Gaikwad, Chief Garden Superintendent

Mr. Tushar Hinge, Deputy Mayor, PCMC

Mrs. Mangala Kadam, Hon. Corporator & Ex. House Leader, PCMC

Mrs. Anuradha Gorakhe, Hon. Corporator

Mr. Keshav Gholave, Hon. Corporator

Mr. Sunil Waghunde, Executive Engineer Garden (Civil)

Dr. Arun Dagade, Veterinary Officer

We are also thankful to the Central Zoo Authority, Maharashtra State Zoo Authority, Zoological Survey of India, Zoo Outreach Organization, Department of Animal Husbandry (Govt. of Maharashtra) and the State Forest Department, for regular co-operation, help, guidance, assistance and encouragement rendered by them.

REPORT OF OFFICER-IN-CHARGE

Basic Information about the Zoo

S.No.	Particulars	Information
1	Name of the Zoo	Nisargakavi Bahinabai Choudhary Pranisangrahalay, Sambhaji Nagar, Chinchwad, Pune -411019
2	Year of Establishment	1 st January 1990
3	Address of the Zoo	Nisargakavi Bahinabai Choudhary Pranisangrahalay, Sambhaji Nagar, Chinchwad, Pune -411019
4	State	Maharashtra
5	Telephone Number	020-27371036
6	Fax Number	--
7	E-mail address	zoo@pcmcindia.gov.in
8	Website	www.pcmcindia.gov.in
9	Distance from nearest	Airport: Pune Airport - 18 km
		Railway Station: Chinchwad Railway Station - 5 km
		Bus Stand: Sambhaji Nagar Bus Stand - 300 mtrs
10	Recognition Valid up to (Date)	28-09-2019
11	Category of zoo	Small Zoo
12	Area (in Hectares)	2.85 Ha
13	Number of Visitors (Financial Year)	Currently Zoo is closed for Renovation.
14	Visitors' Facilities Available in Zoo	Currently Zoo is closed for Renovation. Visitor facilities include resting shades, drinking water, wheel-chair, first-aid, etc.
15	Weekly Closure Day of the Zoo	Tuesday

Management Personnel of the zoo

Management Personnel of the zoo		
16	Name with designation of the Officer in-charge	Mr.Dattatray N. Gaikwad, HOD, Garden department
	Name of the Curator (Director In-charge)	Dr. Chaitrali Ashok Avhad
	Name of the Veterinary Officer	Dr. Ghanshyam M. Pawar
	Name of the Biologist	--
	Name of the Education Officer	--
	Name of the Compounder / Lab Assistant	--
Owner / Operator of the Zoo		
17	*Name of the Operator	The Municipal Commissioner, Pimpri Chinchwad Municipal Corporation, Pimpri, Pune - 411018
18	Address of the Operator	The Municipal Commissioner, Pimpri Chinchwad Municipal Corporation, Old Mumbai-Pune Highway Pimpri, Pune - 411018
19	Contact details/Phone number of Operator	020 - 39 33 11 17
20	E-mail address of Operator	commissioner@pcmcindia.gov.in



INTRODUCTION

Nisargakavi Bahinabai Choudhary Pranisangrahalay, previously known as Snake Park & Aviary, is a Small Zoo established by Pimpri Chinchwad Municipal Corporation recognized by the Central Zoo Authority. It was inaugurated on 30th December 1989 and officially declared open to public on 1st January 1990. This zoo has witnessed continuously increasing visitor ship since then. Zoo has got approval for Master Development Plan 2015-25 and the subsequent development is under progress accordingly. The master plan has been approved by CZA vide letter no F.N. -19/727/93-CZA (180) (VOL.III) 815/2016 dated June 02, 2016. The administration has approved the necessary budget provisions and zoo is under reformation. The necessary civil changes as per approved Master Lay Out for phase I have been completed and development under phase II and Phase III are in progress simultaneously.

The upcoming Zoo facility is being developed on theme of “Reptiles and Aviary” specialized Zoo. Accordingly, the Central Zoo Authority has approved the collection on theme of Reptiles of Northern Western Ghats and Wetland Aviary in approved Master Development Plan.



LOCATION

A total 7.05 Acre land has been earmarked for this project. It caters for the Twin City of Pimpri - Chinchwad and surrounding rural areas, developed mainly due to rapid urbanization and industrial growth.

This township is extended towards north of Pune City along the National Highway No.4, joining Pune and Mumbai. It is situated 4 km Eastwards from Akurdi railway station, 5 km Northeast from Chinchwad railway station, 7 km West from Pune Nashik Highway, Bhosari and 6 km North of Pimpri.



Approved layout plan for proposed development

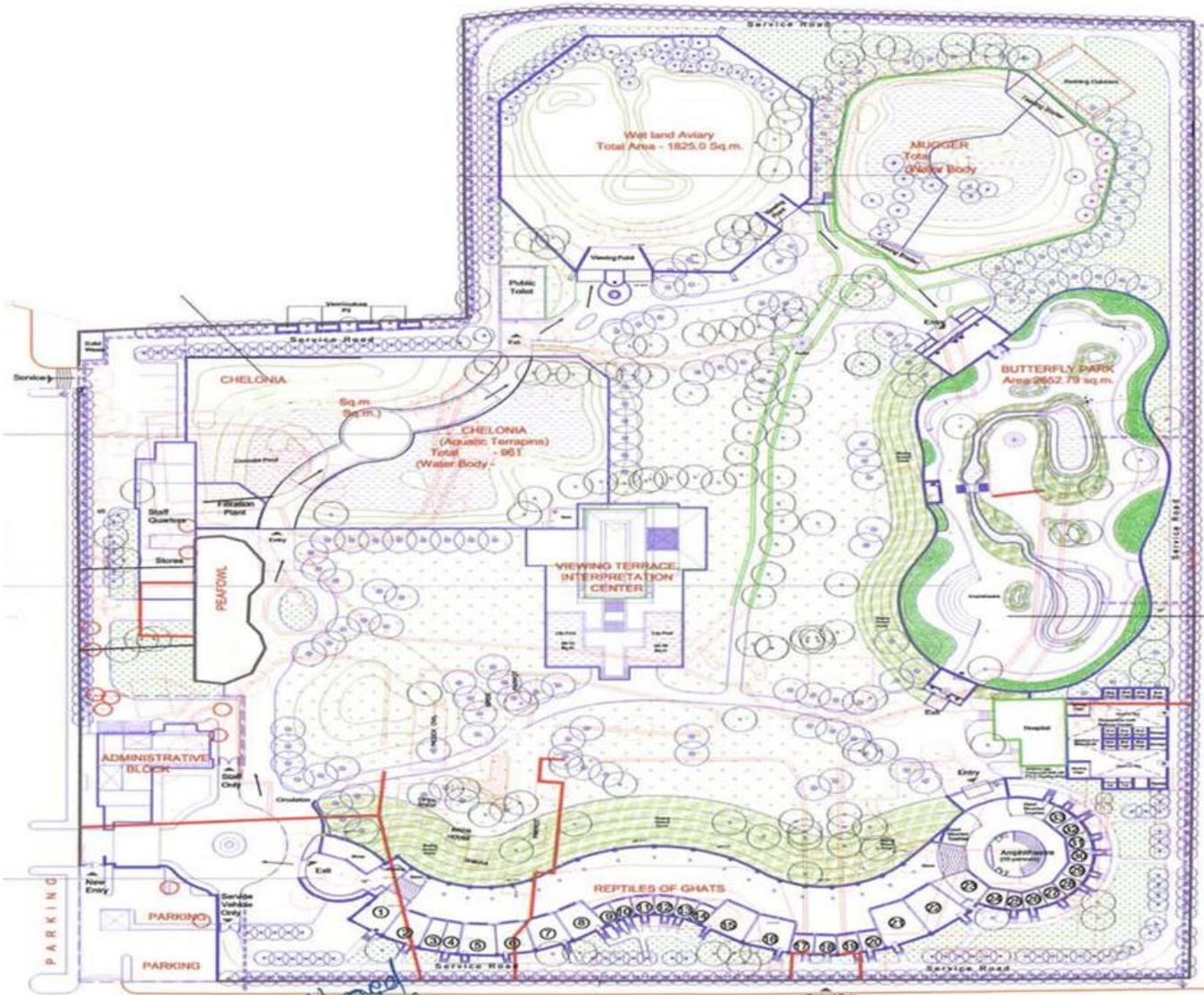

MISSION, VISION AND OBJECTIVES OF THE ZOO

MISSION

To be an epitome center for conservation of endemic Herpetofauna and Avifauna found in the region.

VISION

To make it the best small category zoo by theme-based development for exhibition and education to the visitors about the endemic reptiles of the Western Ghats.)

OBJECTIVES

The proposed zoo development is in accordance with approved theme 'Reptiles of Ghats and Aviary'. With this unique theme, the zoo envisions collection of rare and endemic variety of Reptiles found in Western Ghats along with diversity of wetland birds. Considering the theme of zoo, it has following objectives.

- To educate students and visitors about importance of wildlife and emphasize the need for conservation of nature and natural resources.
- To rescue snakes, birds and sometimes other animals that enter into human habitation and release them back in the wild. Releasing activity is performed with the permission of Forest Office after receiving transit passes.
- To undertake Conservative breeding programs of different snake species which are endangered and release the offspring back into areas where population is declining
- To organize guided tours for school children and provide necessary information lectures, demonstrations, slide shows and related printed material with audio-visual media.
- To disseminate the current information on Biodiversity amongst the general public.
- To create proper enrichment in every enclosure as per requirement of the species considering the environmental changes.

ZOO ADMINISTRATION

Zoo Director / Curator	Education Officer / Biologist
	Office Clerk Booking Clerk
	Driver, Gardener & Laborer
	Security Officer Security Guards
Veterinary Officer	Head Animal Keeper Animal Keepers

HUMAN RESOURCES

Sr. No.	Designation	Number of sanctioned posts	Posts filled	Names of the incumbent
1	Curator (Director In-charge)	1	1 Contractual	Dr. Chaitrali A. Avhad
2	Veterinarian	1	1 Contractual	Dr. Ghanshyam M. Pawar
3	Biologist / Education Officer	1	1 Contractual	--
4	Head Animal Keeper	1	---	---
5	Animal Keeper	2	2 (Labour)	Mr. Anil P. Raut Smt. Jayashree D. Madane
6	Assistant Animal Keeper	6	---	---
	Total	12	5	4

CAPACITY BUILDING OF ZOO PERSONNEL

- In- house training programs are organized periodically for zoo staff and volunteers.
- Various training programs attended by zoo staff whenever invited and organized by The Central Zoo Authority of India.
- The zoo is in discussion for long term collaboration with Department of Environmental Sciences, University of Pune and Department of Biodiversity, Abasaheb Garware College.
- Subject concerned expertises are invited to deliver lectures at zoo to educate staff and targeted audience on celebration events.

ADVISORY COMMITTEES

ZOO ADVISORY COMMITTEE

Zoo advisory committee has been reformed to observe the ongoing developmental activities in the Zoo.

Date of constitution: 20th March, 2017

Members: The committee constitutes of the following members.

Zoo Advisory Committee Members

1	Mr. Santosh Patil	Additional Commissioner	Chairman
2	Mr. Sunil Waghunde	Executive Engineer	Member Secretary
3	Dr. Arun Dagade	Municipal Veterinary Officer	Coordinator
4	Mrs. Mangala Kadam	Corporator	Member
5	Mrs. Anuradha Gorakhe	Corporator	Member
6	Mr. Tushar Hinge	Deputy Mayor	Member
7	Mr. Keshav Gholave	Corporator	Member
8	Mr. Dattatray Gaikwad	Chief Garden Superintendent	Member
9	Mr. Pankaj Jain	Zoo Architect	Member
10	Mr. Anuj Khare	State Wildlife Advisory Board	Member
11	Dr. Rahul Marathe	Renowned Entomologist	Member
12	Dr. Rajkumar Jadhav	Director, RGZP	Member
13	Dr. Mayuri Panse	Educationalist	Member
14	Miss. Shreelaxmii Annabathula	DCF, Pune	Member
15	Mr. Umesh Vaghela	NGO, Representative	Member
16	Mr. Kedar Bhide	Renowned Herpetologist	Member

ZOO ADVISORY COMMITTEE MEETINGS

Zoo advisory committee meetings are regularly held for discussions on Zoo Development related issues. Addl. Commissioner is the chairman of this committee. Under his committed leadership the development is acclaimed. The committee is represented by higher authorities in Municipal Corporation, representatives of local electoral members, eminent wildlife experts and a member from State Wildlife Board.

Zoo advisory committee meeting

The committee has been formulated considering the role of Zoo's in conservation. Due to varied expertise and holistic development approach the committee is of opinion that the Zoo shall focus on conservation and display of lesser known small fauna. The committee is also considering conservation breeding of native fishes and amphibians as a priority.

Dates on which meetings held during the year:

1. 20-03-2017
2. 22-09-2017
3. 12-01-2018
4. 19-12-2018
5. 19-07-2019
6. 15-02-2020

HEALTH ADVISORY COMMITTEE

Health advisory committee for PCMC Zoo was proposed in January 2018 Zoo Advisory Meeting. The committee has accepted the proposal to constitute the same. The constitution of this committee is under process.

FOOD, HEALTH, HYGIENE AND SAFETY MEASURES

The Zoo administration is committed for animal welfare and wildlife conservation. Health and hygiene of animals are given highest priority in its management. For psychological health of Zoo inmates the new facility emphasizes naturalistic habitat enrichment in every enclosure. Use of live plantations prioritizing native plant varieties are being used in upcoming development.

Following are the routine practices for monitoring health of animals and safety of staff and visitors undertaken in the Zoo:

- De-worming and vaccination is scheduled periodically.
- De-beaking and nail clipping of birds is a periodic practice.
- Perching are repaired or replaced with new ones regularly. In new enclosures emphasis has been given to produce natural perching on live plants.
- Animal waste, food wastage, leaf litter and other biodegradable wastes are recycled to produce compost. No chemical fertilizers or pesticides are used in Zoo campus.
- Exhibit substrates /furnishings are modified or changed totally whenever necessary. Hiding places and escape refuges are maintained to reduce stress levels.
- Heat convectors, air coolers, humidifiers and are used during climatic extremities.
- Volunteers and staff control the vandalism.
- Food and drinking water is regularly examined.
- Plastic Carry bags are banned in the zoo. Necessary signages are displayed to prevent vandalism.

ANIMAL AND BIRD HEALTH CHECKUP AND TREATMENTS ON REGULAR BASIS



FEEDING PROTOCOL / SCHEDULE

HERBIVORE

Sr. No.	Name	Feed Item	Approx. Quantity (Per animal) (Gms)	Day of fasting
1	Indian Peafowl	Mixed Vegetables- Leafy Vegetables-Mixed Grains	100-100-150	---
2	Budgerigar	Coriander-Millet-Sprouts	10-20-10	---
3	Cockatiel	Coriander-Millet-Sprouts	20-40-20	---
4	Alexandrine Parakeet	Mixed Fruits-Coriander- Sprouts-Oilseeds	20-10-10-50	---
5	Rose-ringed Parakeet	Mixed Fruits-Coriander- Sprouts-Oilseeds	20-10-10-50	---
6	Plum-headed Parakeet	Mixed Fruits-Coriander- Sprouts-Oilseeds	20-10-10-50	---
7	Spot-billed Duck	Mixed Vegetables- Leafy Vegetables-Mixed Grains	50-50-100	---
8	Starred Tortoise	Mixed Vegetables-Mixed Fruits-Dry Prawns	150-50-10	---



CARNIVORE

Sr. No.	Name	Feed Item	Approx. Quantity (Per animal) (Gms/Units)	Feeding Frequency
1	Common Cobra	Mice	2	Once a week
2	Russell's Viper	Mice	2	Once a week
4	Dhaman	Mice	2	Once a week
5	Checkered Keelback	Mice/Live Fish	1/2	Once a week
6	Trinket	Mice	1	Once a week
7	Sand Boa	Mice	1	Once a week
8	Earth Boa	Mice	1	Once a week
9	Banded Racer	Mice	1	Once a week
10	Wolf Snake	Mice	1	Once a week
11	Grass Snake	Mice/ Live Fish	1/1	Once a week
12	Common Krait	Mice	2	Once a week
13	Wall's Sind Krait	Mice	2	Once a week
14	Bamboo Pit Viper	Mice	1	Once a week
15	Marsh Crocodile* (Adult)	Beef/Chicken	1500-2000	Twice a week (Summer) Once a week (Winter)
	Marsh Crocodile* (Sub Adult)	Beef/Chicken	700-1000	Twice a week
	Marsh Crocodile* (Baby)	Beef/Chicken/Fish	100-200	Thrice a week
16	Flap-shelled Turtle	Beef/Chicken	40	Thrice a week
		Dry Prawns	10	
		Coriander	20	
17	Indian Black Turtle	Beef/Chicken	40	Thrice a week
		Dry Prawns	10	
		Coriander	20	
18	Deccan Soft-shell Turtle	Beef/Chicken	80	Thrice a week
19	Red-eared Terrapin	Beef/Chicken	30	Thrice a week
		Dry Prawns	10	
		Coriander	20	
20	Pariah Kite	Beef/Chicken	150	Daily (Except Sunday)

VACCINATION SCHEDULE

The vaccination is performed SOS on warnings from State Animal Husbandry and Central Zoo Authority.

DE-WORMING SCHEDULE

De-worming is carried out in every quarter for birds.

Sr. No.	Species	Drug used	Month
1	Indian Peafowl	Albendazole	May, Aug, Nov, Feb
2	Budgerigar	Albendazole	May, Aug, Nov, Feb
3	Cockatiel	Albendazole	May, Aug, Nov, Feb
4	Alexandrin Parakeet	Albendazole	May, Aug, Nov, Feb
5	Rose-ringed Parakeet	Albendazole	May, Aug, Nov, Feb
6	Plum-headed Parakeet	Albendazole	May, Aug, Nov, Feb
7	Black kite	Albendazole	May, Aug, Nov, Feb
8	Spot-billed Duck	Albendazole	May, Aug, Nov, Feb
9	Starred Tortoise	Albendazole	May, Aug, Nov, Feb

DISINFECTION SCHEDULE

Since, the zoo is under renovation, enclosure locations and surface soil has been changed recently. Otherwise, the surface soil and perches are disinfected periodically using suitable media. Cage resting and solar exposure is performed routinely to avoid chances of infection.

HEALTH CHECK-UP OF EMPLOYEES FOR ZONOTIC DISEASES

Every year in month of June employees undergo health check-up for zoonotic diseases. No suspect was found in the current year. At the time of inspection employees were vaccinated with Anti-Rabies and Tetanus. This year, employees are also periodically screened for COVID-19 pandemic disease.



SEASONAL MANAGEMENT PRACTICES

- During summer afternoons, water is sprinkled in bird enclosures.
- For reptiles, desert coolers are installed to regulate temperature during peak summer time.
- Incandescent light bulbs are used as heating source in snake boxes during winter season.



Snake boxes with incandescent light bulb heaters

DEVELOPMENT ACTIVITIES

A small zoo focusing on Reptiles and Bird collection was envisioned in 1989 to enlighten city dwellers about the biological heritage of the region. It was only 3rd Reptile specialized zoo in the country at that time. Though the facility was attracting large number of visitors, the need of upgrading the facility to latest trends in the field was imperative.

Accordingly, the Master Development Plan for Nisargakavi Bahinabai Choudhary Pranisangrahalay was prepared and approved by the Central Zoo Authority. The zoo is spread in 7.05 acres and is surrounded by residential zone. The theme selected in approved master plan is 'Reptiles and Aviary'. The proposed facility is expected to house 31 species of snakes, 2 species of monitor lizard, 13 species of turtles and tortoises, 2 varieties of crocodiles and 14 species of wetland birds.

The Zoo Master Development Plan has been approved by the Central Zoo Authority in year 2014-15. The development is focused on creating naturalistic environments for all inmates. The zoo landscape is also planned to complement natural environment and emphasis is given to promote native plants.

Technical posts recommended by CZA in Master Plan have been included in PCMC's proposed RR structure.

The civil works proposed in the development are under progress. Phase I of the development was completed in 2017. In First phase construction of Compound wall, peripheral underground water and drainage line, new toilet block and peripheral pathway, civil construction of reptile, bird aviary, chelonian section and mugger section were completed. Phase II including quarantine section, enrichment works of various enclosures are undertaken simultaneously to conclude the developments in stipulated time.

ZOO ENTRANCE



PROPOSED ENTRANCE GATE
(THEMATIC REPRESENTATION)



ENTRANCE AND NEWLY PROPOSED
ADMINISTRATIVE BLOCK (INSIDE VIEW)
(THEMATIC REPRESENTATION)



CURRENT STATUS OF ENTRANCE GATE

CHELONIA SECTION



3D VIEW OF CHELONIA
(THEMATIC
REPRESENTATION)

CURRENT STATUS OF CHELONIA SECTION



WETLAND AVIARY



3D VIEW OF WETLAND AVIARY (THEMATIC REPRESENTATION)



CURRENT STATUS OF AVIARY SECTION

MUGGAR AND GHARIAL SECTION



3D VIEW OF MUGGAR AND GHARIAL ENCLOSURE (THEMATIC REPRESENTATION)



CURRENT STATUS OF MUGGAR AND GHARIAL SECTION



REPTILES OF GHATS SECTION



AERIAL VIEW OF REPTILES OF GHATS (THEMATIC REPRESENTATION)



CURRENT STATUS OF REPTILES OF GHATS

QUARANTINE SECTION



CURRENT STATUS OF QUARANTINE SECTION

VISITS BY DIGNITARIES

Shri. SANTOSH PATIL, ADDITIONAL COMMISSIONER, PCMC, VISITED ZOO FOR
REVIEWING OF CURRENT STATUS OF ZOO DEVELOPMENT WORK



WILDLIFE WEEK CELEBRATION - 2019

We celebrated Wildlife Week between 1st October to 8th October. Though the zoo is closed due to renovation work we planned to take various awareness programmes at different institutes and local schools.

1. Subodh Vidyalaya, Sambhajinagar, Chinchwad (Drawing competition with the theme of Wildlife protection)



2. Nutan Vidyamandir, Chinchwad (Wildlife Awareness through fun activities)



3. Blind and Deaf Organization (Informative lecture on how to identify snakes with their sounds and protection measures)



VISIT BY CENTRAL ZOO AUTHORITY REPRESENTATIVE FOR RENEWAL OF RECOGNITION OF ZOO

Delhi) visited and evaluated zoo for renewal of recognition of zoo on dated 29-01-2020.



ANIMAL INVENTORY

CURRENT STOCK

INVENTORY CLOSING ON MARCH 2020

[A] REPTILES						
Sr. No.	COMMON NAME	SCIENTIFIC NAME	M	F	U	TOTAL
1	Common Cobra	<i>Naja n. naja</i>	2	6	0	8
2	Russell's Viper	<i>Vipera russelli</i>	2	2	0	4
3	Dhaman	<i>Ptyas mucosa</i>	2	6	0	8
4	Checkered Keelback	<i>Xenochrophis piscator</i>	3	3	0	6
5	Marsh Crocodile	<i>Crocodylus palustris</i>	1	1	1	3
6	Flap-shelled Turtle	<i>Lissemys punctata</i>	0	2	10	12
7	Trinket	<i>Coelognathus helena</i>	1	3	0	4
8	Sand Boa	<i>Eryx conicus</i>	1	2	0	3
9	Earth Boa	<i>Eryx johnii</i>	1	2	1	4
10	Banded Racer	<i>Argerogena fasciolatus</i>	1	1	0	2
11	Wolf Snake	<i>Lycodon aulicus</i>	1	1	0	2
12	Grass Snake	<i>Macropisthodon plumbicolor</i>	0	0	2	2
13	Starred Tortoise	<i>Geochelone elegans</i>	3	4	6	13
14	Common Krait	<i>Bungarus caeruleus</i>	2	2	0	4
15	Wall's Sind Krait	<i>Bungarus sindanus walli</i>	0	2	0	2
16	Indian Black Turtle	<i>Melanochelys trijuga</i>	0	1	2	3
17	Deccan Softshell Turtle	<i>Nilsonia leithii</i>	0	0	2	2
18	Bamboo Pit Viper	<i>Trimersurus gramenus</i>	0	0	2	2
19	Red-eared Terrapin	<i>Trachemys scripta</i>	7	11	0	18
		Total	27	49	26	102

[B] BIRDS

Sr. No.	COMMON NAME	SCIENTIFIC NAME	M	F	U	TOTAL
1	Indian Peafowl	<i>Pavo cristatus</i>	6	1	0	7
2	Budgerigar	<i>Melopsittacus undulates</i>	15	11	10	36
3	Cockatiel	<i>Nymphicus hollandicus</i>	11	8	8	27
4	Alexandrine Parakeet	<i>Psittacula eupatria</i>	4	1	1	6
5	Rose ringed Parakeet	<i>Psittacula krameri</i>	3	5	0	8
6	Plum-Headed Parakeet	<i>Psittacula cynocephala</i>	1	0	0	1
7	Spotbill Duck	<i>Anas poecilorhyncha</i>	0	1	0	1
8	Pariah Kite	<i>Milvus migrans</i>	0	0	4	4
		Total	40	27	23	90

SUMMARY OF DEATH REPORT

Date	Species	Sex	Cause of Death	Method of Disposal
06-06-2019	Spotted Black Terrapin	U	Urinary tract infection	Burial
25-09-2019	Marsh Crocodile	U	Peptic ulcer	Incineration
15-10-2019	Plum-headed Parakeet	M	Anemia and cardiac arrest	Burial

STOCK POSITION

Category	Closing stock of previous year (2018-19)	Births	Acquisition	Death (April 2019-March 2020)	Disposal (April 2019-March 2020)	Closing stock of this year (2019-20)
Birds	91	-	-	01	01	90
Reptiles	104	-	-	02	02	102
Total	195	-	-	03	03	192

PROPOSED COLLECTION

[A] REPTILES

Sr. No.	COMMON NAME	SCIENTIFIC NAME	Proposed Collection			
			M	F	U	T
1	Common Kukri snake	<i>Oligodon arnensis</i>	2	2	0	4
2	Python Indian	<i>Python molurus</i>	2	2	0	4
3	Python Reticulated	<i>Python reticulatus</i>	2	2	0	4
4	Anaconda	<i>Eunectes murinus</i>	2	2	0	4
5	Yellow Monitor	<i>Varanus salvater</i>	2	2	0	4
6	Monitor Lizard	<i>Varanus bengalensis</i>	2	2	0	4
7	Green Iguana	<i>Iguana iguana</i>	2	2	0	4
8	Indian Chameleon	<i>Chameleon zeylonicus</i>	3	3	0	6
9	Whitaker's Boa	<i>Gongylophis whitekarii</i>	2	2	0	4
10	Montane Trinket	<i>Coelognathus helena monticollaris</i>	3	3	0	6
11	Ornamental Snake	<i>Chrysopelia ornata</i>	2	2	0	4
12	Bronze-back Tree Snake	<i>Dendrolephis tristis</i>	2	2	0	4
13	Royal Snake	<i>Spalerosophis atriceps</i>	2	2	0	4
14	Banded Krait	<i>Bungarus fasciatus</i>	2	2	0	4
15	Cat Snake Common	<i>Boiga trigonata</i>	3	3	0	6
16	Cat Snake Forsten's	<i>Boiga forstenii</i>	2	2	0	4
17	Cobra Monocled	<i>Naja kaouthia</i>	2	2	0	4
18	Saw-scaled Viper	<i>Echis carinatus</i>	2	2	0	4
19	Sand Boa	<i>Gongylophis conicus</i>	2	2	0	4
20	Earth Boa	<i>Eryx johnii</i>	2	2	0	4
21	Wolf snake	<i>Lycodon aulicus</i>	2	2	0	4
22	Yellow spotted wolf snake	<i>Lycodon flavomaculatus</i>	2	2	0	4
23	Cobra common	<i>Naja naja</i>	5	5	0	10
24	Dhaman	<i>Ptyas mucosa</i>	5	5	0	10
25	Banded racer	<i>Argyrogena fasciolatusz</i>	3	3	0	6
26	Grass snake	<i>Macropisthodun plumbicolor</i>	3	3	0	6
27	Trinket	<i>Coelognathus helena</i>	5	5	0	10
28	Bamboo pit viper	<i>Trimerasurus graminus</i>	3	3	0	6
29	Checkered keelback	<i>Xenochrophis piscator</i>	10	20	0	30
30	Russell's Viper	<i>Daboia russelli</i>	5	5	0	10

31	Wall's sind krait	<i>Bungarus s.walli</i>	2	2	0	4
32	Striped keelback	<i>Amphiesma stolatum</i>	1	2	0	3
33	Krait common	<i>Bungarus ceruleus</i>	2	2	0	4
34	Elongated Tortoise	<i>Indotestudo elongata</i>	2	4	0	6
35	Travancore Tortoise	<i>Indotestudo travancorica</i>	2	4	0	6
36	Spotted Terrapin	<i>Geoclamys hamiltonii</i>	4	8	0	12
37	Eastern Hill Terrapin	<i>Melanochelys tricarinata</i>	4	8	0	12
38	Indian Terrapin	<i>Melanochelys trijuga</i>	3	6	0	9
39	Deccan Flapshell Turtle	<i>Nilsonia leithii</i>	2	4	0	6
40	Tent Terrapin	<i>Pangushura tecta</i>	6	12	0	18
41	Narrow-mouthed Softshell Turtle	<i>Chitra indica</i>	4	4	0	8
42	Indian Roofed Turtle	<i>Pangushura tenctoria</i>	6	12	0	18
43	Assam Roofed Turtle	<i>Pangshura sylhetensis</i>	5	5	0	10
44	Red eared turtle	<i>Trachemys scripta</i>	6	12	0	18
45	Flapshell turtle	<i>Lessymis punctata</i>	3	6	0	9
46	Starred tortoise	<i>Geochelone elegans</i>	8	12	0	20
47	Marsh crocodile	<i>Crocodylus palustris</i>	2	4	0	6
48	Gharial	<i>Gavialis gangeticus</i>	2	4	0	6

[B] BIRDS

Sr. No.	COMMON NAME	SCIENTIFIC NAME	Proposed Collection			
			M	F	U	T
1	Pelican	<i>Pelecanus onocrotalus</i>	3	3	0	6
2	White Ibis	<i>Threskiornis melanocephalus</i>	3	3	0	6
3	Grey Heron	<i>Ardea cineraria</i>	2	2	0	4
4	Painted Stork	<i>Mycteria leucocephala</i>	3	3	0	6
5	Spoonbill	<i>Platalea leucorodia</i>	3	3	0	6
6	Comb Duck	<i>Sarkidiornis melanotos</i>	5	5	0	10
7	White-breasted Waterhen	<i>Amaurornis phoenicurus</i>	3	3	0	6
8	Dabchick	<i>Tachybaptus ruficollis</i>	5	5	0	10
9	Black-necked Stork	<i>Ephippiorhynchus asiaticus</i>	2	2	0	4
10	Night Heron	<i>Nycticorax nycticorax</i>	5	5	0	10
11	Large Egret	<i>Ardea alba</i>	2	2	0	4
12	Common Teal	<i>Anas crecca</i>	5	5	0	10
13	Shoveller	<i>Anas clypeata</i>	5	5	0	10
14	Ruddy Shelduck	<i>Tadorna ferruginea</i>	5	5	0	10

INCOME, EXPENSES AND VISITORSHIP

The zoo remains closed for visitors from 25th December 2017 to till date.

BUDGET AND FINANCES

Budget Year	Budget allotted	Expenditure
2016-2017	2 Crore	1.92 Crore
2017-2018	7.50 Crore	7.20 Crore
2018-2019	5 Crore	4.90 Crore
2019-2020	1.25 Crore	1.17 Crore

COMPLIANCE REPORT

(Ref: Letter No. 19-127/93-CZA(180)(Vol. III)(NS) dated 03.01.2019 subjected as Renewal of recognition to Nisargakavi Bahinabai Choudhary Pranisangrahalaya, Pimpri Chinchwad, Maharashtra under Section 38H of the Wildlife (Protection) Act, 1972 beyond the period 28.09.2019)

Sr. No.	Norm. No	Condition Stipulated	Time period to Comply	Present Status	Remark
1. General Requirements					
1.	10.1(2)	The zoo should plant native trees and bushes as screening and buffer all around the boundary wall especially at the entrance of the zoo area towards adjacent temple.	Immediately	Native tree plantation is done.	
2.	10.1(6)	It has been observed that one residential house has been existing inside the zoo campus, which is not separated by the boundary wall of two meters height. The entry and exit of the house is also from the zoo campus only. As per the approved master (layout) plan it was proposed to demolish the structure to construct a butterfly park. However, same has not been complied so far.	Immediately	To be carried out in future.	
2. Administrative & staffing pattern					
3.	10.2(1)	The zoo should appoint a whole time well qualified Officer-in-charge having appropriate knowledge of Wildlife management. At present, it has been observed that Officer-in-charge and other important staff like Veterinarian and Biologist are appointed only for short term duration with up to six month duration. The Officer-in-charge should have delegated adequate financial and administrative powers for taking immediate decisions concerning health and welfare of the captive wild animals.	Immediately	Direct recruitment is not done. All posts (Officer-in-charge, Veterinarian and Biologist) are on honorarium basis.	Direct recruitment should be done.
3. Development and planning					

4.	10.3(5)	The construction work of the zoo is going on. The zoo should take care of natural landscapes of the zoo and animal enclosures should not be masked and the cleanliness and hygiene of the zoo should not affect.	Immediately	Under renovation	Phase-II enrichment work is in progress.
4. Animal housing, display of animals and animal enclosures					
5.	10.4(1)	The new enclosure being constructed should be nature immersing since the zoo is housing reptiles, so to take care of sufficient sunlight, the temperature controlling devices and equipments should be placed for the safety of animals.	Immediately	Under renovation	
6.	10.4(2)	The construction work of the zoo is going on since long. The animals of the zoo are temporarily housed in small enclosures which do not meet the design and dimension prescribed by the CZA for housing these animals. The work of the new enclosure should be done on pace and should complete at the earliest. In the mean time zoo should take care of the animal housed and ensure that they do not get stressed due to housing in small enclosures.	Immediately	Under renovation	
7.		On the left side of the entrance of the zoo, there is an old abandoned enclosure. As per the master (layout) plan peacock enclosure is approved on this location. The old enclosure is not in bad shape; hence it is suggested to modify the enclosure in place of demolishing the same after approval of the design from CZA. The design should be submitted to the CZA for approval.	Immediately	Under renovation	
8.	10.4(6)	The zoo should provide species specific enrichment artifacts to meet the behavioral needs of the animals in the enclosures.	Immediately	Under renovation	

9.	10.4(9)	The live hedge should be developed between the viewing area and standoff barrier in the newly constructed enclosures.	Immediately	Under renovation	
10.	10.4(10)	The zoo should place appropriate bilingual signage's (Hindi as primary language) displaying adequate detailed scientific information about species.	Immediately	Under renovation	
5. Upkeep and health care of animals					
11.	10.5(5)	The provision of footbath should be made at the entry and exit point of each enclosure which is being constructed. Further, the footbath should have provision of proper disinfectant.	Immediately	Under renovation	
12.	10.5(6)	The food and water samples should be tested periodically for microbiological, toxicological and any other contaminants at recognized laboratory.	Immediately as not done in the past.	Periodically samples are checked.	
13.	10.5(8)	The vaccination and de-worming is being done, however, the schedule for the same should be prepared and displayed at the enclosure and strictly be followed.	Immediately	After completion of enrichment, the schedules will be strictly displayed at the enclosures.	
14.	10.5(9)	The zoo staff handling the animals should be screened against zoonotic diseases at least once in a year and the record should be maintained.	Immediately	Zoo staff will be screened periodically against zoonotic diseases.	
15.	10.5(10)	The keeper's diary, daily reports, animal history cards and treatment cards should be prepared as per the specified standards / format of the CZA.	Immediately	All reports are maintained.	
6. Veterinary and infrastructure facilities					
16.	10.6 (1)	The zoo should take up the modification/ construction of the zoo hospital unit as per approval of the CZA.	Six months	Under renovation	
17.	10.6 (5)	A zoo should depute a Veterinary support staff as whole time employee.	Immediately	Whole time veterinary support staff deputed.	

7. Postmortem and disposal of carcass of animals

18.	10.7 (2)	The finding of the post-mortem examination should be recorded in the CZA prescribed format and records should be maintained for atleast six years.	Immediately	All records are maintained	
19.	10.7 (2)	The zoo should also install an incinerator for disposal of animal carcasses in a manner that does not have any adverse impact on the hygiene and cleanliness of zoo.	Six months	Incinerator is available at PCMC Veterinary department.	

10. Research activities

20.	10.10 (1)	There are numbers of education institute in the Pune city. The zoo should encourage local students of these educational institutions to take up research studies.	Six months	Under renovation	
-----	-----------	---	------------	------------------	--

11. Education and outreach activities

21.	10.11 (1)	The zoo should develop an annual calendar to take up educational activities for the awareness and conservation of wildlife to general public and students etc. the objective can be achieved through by involving local educational institutions or with the help of educated volunteers. The various environment and wildlife days should be celebrated at the zoo by inviting the school students.	Immediately	Zoo celebrated Wildlife Week during October 2019 in blind and deaf organization and local educational institutes.	
-----	-----------	--	-------------	---	--

12. Visitor Facilities					
22.	10.12 (1)	The zoo should have the facility of cloak rooms and kiosk for the visitors.	One year	Under renovation	
23.	10.12 (3)	The zoo should also make provision of the wheelchair and ramps for providing the access of better viewing of the animals by the 'Divyangjan'.	Immediately	Wheel-chair is available. Ramps are under renovation stage.	



Curator, NBCP



Veterinary officer, PCMC



Chief Garden Superintendent



Executive Engineer (Garden Civil)



Additional Commissioner, PCMC



Commissioner, PCMC

FREE RANGING WILDLIFE

LIST OF MAMMALS

Sr. No.	English Name	Marathi Name	Scientific name
1	Common Mongoose	Mungus	<i>Herpestes edwardsi</i>
2	Palm Squirrel	Khar	<i>Funambulus palmarum</i>
3	Flying Fox	Watvaghul	<i>Pteropus giganteus</i>
4	Rat	Umdir	<i>Rattus rattus</i>

LIST OF BIRDS

No.	Vernacular Name (Marathi)	Common English Name	Scientific Name
1	Ghar	Pariah Kite	<i>Milvus migrans</i>
2	Shikra	Shikra	<i>accipiter badius</i>
3	Titvi	Red-wattled Lapwing	<i>Vanellus indicus</i>
4	Parva	Blue Rock Pigeon	<i>Columba livia</i>
5	Hola	Little Brown Dove	<i>Streptopelia senegalensis</i>
6	Popat	Rose-ringed Parakeet	<i>Psittacula krameri</i>
7	Kokila	Koel	<i>Eudynamys colopacea</i>
8	Bharadwaj	Crow Pheasant	<i>Centropus sinensis</i>
9	Gavhani Ghubad	Barn Owl	<i>Tyto alba</i>
10	Pingalya	Spotted Owlet	<i>Athene burma</i>
11	Pakoli	House swift	<i>Apus affinis</i>
12	Khandya	White-breasted kingfisher	<i>Halcyon smyrnensis</i>
13	Bandya	Small Blue kingfisher	<i>Alcedo atthis</i>
14	Veda Raghu	Green Bee-eater	<i>Merops orientalis</i>
15	Shingchocha	Grey Hornbill	<i>Tocus birostris</i>
16	Tambat	Coppersmith Barbet	<i>Megalaima haemacephala</i>
17	Pakoli	Dusky Crag Martin	<i>Hirunda concolor</i>
18	Bhingari	Red-rumped Swallow	<i>Hirundo rustica</i>
19	Tarvali Bhingari	Wire-tailed Swallow	<i>Hirundo smithii</i>
20	Haladya	Golden Oriole	<i>Oriolus oriolus</i>
21	Khatik	Rufous-backed Shrike	<i>Lanus schach</i>
22	Kotwal	Black Drongo	<i>Dicrurus adsimilis</i>
23	Salunkhi	Common Myna	<i>Acridotherus tristis</i>
24	Bhoradi	Brahmini Myna	<i>Sturnus pagodarum</i>
25	Kawla	House Crow	<i>Corvus splendens</i>
26	Domkawala	Jungle Crow	<i>Corvus macrorhynchos</i>
27	Subhag	Iora	<i>Aegithina tiphia</i>
28	Bulbul	Red-vented Bulbul	<i>Pynonotus cafer</i>
29	Satbhai	Large Grey Babbler	<i>Turdoides malcolmi</i>
30	Nachara	White-browed Fantail	<i>Rhipidura aureola</i>

31	Vatvatya	Ashy Prinia	<i>Prinia socialis</i>
32	Vatvatya	Plain Warbler	<i>Plain subflava</i>
33	Shimpi	Tailor Bird	<i>Orthotomus sutorius</i>
34	Dayal	Magpie Robin	<i>Copsychus saularis</i>
35	Chirak	Indian Robin	<i>Saxicoloides fulicata</i>
36	Thirthira	Black Redstart	<i>Phaenicurus ochruros</i>
37	Fultochoya	Tickel's Flowerpecker	<i>Dicaeum erythrorhynchos</i>
38	Gangara	Great Tit	<i>Parus major</i>
39	Karada Dhobi	Grey Wagtail	<i>Motacilla cinerea</i>
40	Pandhara Dhobi	White Wagtail	<i>Motacilla alba</i>
41	Shinjir	Purple Sunbird	<i>Nectarinia asiatica</i>
42	Shinjir	Purple-rumped Sunbird	<i>Nectarinia zeylonica</i>
43	Chimani	House Sparrow	<i>Passer domesticus</i>
44	Chashmewala	White-eye	<i>Zosterops palpebrosa</i>
45	Sugaran	Baya Weaver Bird	<i>Ploceus phillippinus</i>
46	Munia	Spotted Munia	<i>Lonchura punctulata</i>
47	Chanderi Munia	Silverbill	<i>Lonchura malabarica</i>

LIST OF REPTILES AND AMPHIBIANS

Sr. No.	English Name	Marathi Name	Scientific name
1	Indian Rat Snake	Dhaman	<i>Ptyas mucosa</i>
2	Trinket Snake	Taskar	<i>Coelognathus helena</i>
3	Wolf Snake	Kavdya	<i>Lycodon aulicus</i>
4	Common Kukri Snake	Kukri	<i>Oligodon arnensis</i>
5	Striped Keelback	Naneti	<i>Amphiesma stolatum</i>
6	Worm Snake	Wala	<i>Indotyphlops braminus</i>
7	House Gecko	Pal	<i>Hemidactylus flaviviridis</i>
8	Brook's Gecko	Pal	<i>Hemidactylus brookii</i>
9	Bark Gecko	Pal	<i>Hemidactylus leschenaultii</i>
10	Common Skink	Sapsuruli	<i>Eutropis carinata</i>
11	Common Toad	Bhek	<i>Duttaphrynus melanostictus</i>
12	Cricket Frog	Beduk	<i>Fejervarya sp.</i>
13	Ornate Frog	Beduk	<i>Microhyla ornata</i>
14	Common Tree Frog	Beduk	<i>Polypedates maculatus</i>
15	Indian Skittering Frog	Beduk	<i>Euphlyctis cyanophlyctis</i>

LIST OF TREES

Sr. No.	English Name	Marathi Name	Scientific name
1	Indian lilac/ Neem	Neem	<i>Azadirachta indica</i>
2	Sisam	Sisam	<i>Dalbergia sisoo</i>
3	Soapnut	Ritha	<i>Sapindus laurifolia</i>
4	Spathodia	Pichkari	<i>Spathodia campanulata</i>
5	Eucalyptus	Nilgiri	<i>Eucalyptus sp.</i>
6	Plumeria	Chapha	<i>Plumeria alba</i>
7	Silk Cotton Tree	Kate Sawar	<i>Bombax ceiba</i>
8	Night-Flowering Jasmine	Parijat	<i>Nyctanthes arbor-tristis</i>
9	Tikoma	Songhanti	<i>Tecoma stans</i>
10	Banyan	Vad	<i>Ficus benghalensis</i>
11	Variegated Banyan	Variegated Vad	<i>Ficus benghalensisvar.</i>
12	Curry leaf	Kadipatta	<i>Murraya koenigii</i>
13	Acacia	Hivar	<i>Acacia leucophloea</i>
14	Peepal	Pimpal	<i>Ficus religiosa</i>
15	Silver Oak	Suru	<i>Grevillea robusta</i>
16	Bottle Palm	Bottle Palm	<i>Roystonea regia</i>
17	Areka Palm	Supari	<i>Areca sp.</i>
18	Coconut	Naral	<i>Cocos nucifera</i>
19	Mast Tree	Ashok	<i>Polyalthia longifolia</i>
20	Weeping Fig	Pimparni	<i>Ficus benjamina</i>
21	Indian laurel	Nandrukh	<i>Ficus microcarpa</i>
22	Rubber tree	Rubber tree	<i>Ficus elastica</i>
23	Golden Bamboo	Pivla Bamboo	<i>Bambusa aurnatiana</i>
24	Green Bamboo	Kalak	<i>Bambusa vulgaris</i>
25	Coral tree	Pangara	<i>Erythrina indica</i>
26	Verigated Pangara	Pangara	<i>Erythrina variegata</i>
27	Gulmohar	Gulmohor	<i>Delonix regia</i>
28	Rain Tree	Vilayati Shirish	<i>Samanea saman</i>
29	Indian Cork	Buch	<i>Millingtonia hortensis</i>
30	Casurina	Suru	<i>Casuarina equisetifolia</i>
31	Indian Tulip Tree	Bhend	<i>Thespesia populnea</i>
32	Bottle Brush	Bottle Brush	<i>Callistemon lanceolatus</i>
33	Copper Pod	Tambra-Shingi	<i>Peltophorum ferrugineum</i>
34	Camel's Foot Tree	Kanchan	<i>Bauhinia sp.</i>
35	Christmas Tree	Silver Oak	<i>Araucaria sp.</i>
36	Sandalwood	Chandan	<i>Santalum album</i>
37	Black Acacia	Khair	<i>Acacia catechu</i>
38	Jamun	Jambul	<i>Syzygium cuminii</i>
39	Singapore Cherry	Cherry	<i>Muntingia calabura</i>
40	Guava	Peru	<i>Psidium guajava</i>
41	Mango	Amba	<i>Mangifera indica</i>
42	Custard Apple	Sitafal	<i>Annona squamosa</i>

43	Papaya	Papai	<i>Carica papaya</i>
44	Bel Tree	Bel	<i>Aegle marmelos</i>

LIST OF BUSHES

Sr. No.	English Name	Marathi Name	Scientific name
1	China Rose	Jaswand	<i>Hibiscus sp.</i>
2	Nerium	Kaner	<i>Nerium odorum</i>
3	Jasmanum	Mogra	<i>Jasminum sp.</i>
4	Cana	Kardal	<i>Canna sp,</i>
5	Vinca	Sadafuli	<i>Vincarosea</i>
6	Thuja	Morpankhi	<i>Thujaoccidentalis</i>
7	Holy Basil	Tulas	<i>Ocimum sanctum</i>
8	Cycas palm	Cycas	<i>Cycas sp.</i>



Nisargakavi Bahinabai Choudhary Pranisangrahalay

SAMBHAJI NAGAR, 'G' BLOCK, CHINCHWAD, PUNE - 411 019.

Contact No.: 020 2437 1036

E-mail: zoo@pcmcindia.gov.in

