

The drawings of the Dhole enclosure to be constructed at the Thrissur Zoological Park, Puthur, Kerala were approved by the 84th Meeting of the Expert Group on Zoo Designing of the Central Zoo Authority held on 07.05.2019, subject to conditions laid by the Central Zoo Authority vide its letter No. 19-113/92-CZA(140)(Vol I)(PKR)/827/2019, dated 20.05.2019.



THRISSUR ZOOLOGICAL PARK
Wildlife Conservation & Research Centre, Puthur

DPR -STAGE 3:
DRAWINGS FOR STATUTORY APPROVAL
EXHIBIT NAME:
DHOLE
DRAWING TITLE:
EXHIBIT PLAN
DRAWING NO: DATE: REVISION:

DPR/S3/DHL/02 20.12.2018
SCALE:
2 0 2 4 10M
1:400 (A3)

- LEGEND:
- (135) EXISTING CONTOUR LEVEL
 - +127 PROPOSED LEVEL
 - (DH) SECTION NAME
 - PROPOSED LOW PLANTING
 - PROPOSED PLANTING
 - PROPOSED ROCK
 - FENCE
 - EXISTING BAMBOO CLUMPS

COLLECTION PLAN:

| MALE | FEMALE | TOTAL |
|------|--------|-------|
| 2 | 3 | 5 |

AREA STATEMENT:

| | |
|-----------------------------------|--------------|
| DHOLE EXHIBIT | 1335.05 Sq.m |
| KRAAL [OFF EXHIBIT HOLDING AREAS] | 250.48 Sq.m |

CONSULTANTS:
Jon Coe Design - Idea Design Consortium
Jon Coe Design Pty Ltd. Idea Design
250 Mt. Riddell Road 30/15/16-D, Narayanan Austin Road
Healerville, VIC 3777 Vyttila, Cochin, India - 682019
Australia Phone: +91 484 4036526, 4046526
Email: jon@jorcoedesign.com Email: matt@ideadesign.org

Jon Charles Coe, AILA, PASLA, ARA2PA
Jon Coe Design Pty Ltd., Australia.
Biley E Menon, M Arch, AIA, AIUD
Idea Design, Cochin.
Chitra Hilley, B Arch, MLA, AISOLA
Idea Design, Cochin.
Michael Little, MLA
Idea Design, Bangalore
Felix Varkeykunju, M Tech
Spolion Engineering Software Services, Emakulam

PROJECT BY:
KERALA FOREST DEPARTMENT
GOVERNMENT OF KERALA
FOREST HEADQUARTERS, VAZHUTHACAUD
THIRUVANANTHAPURAM - 695012
Kerala, India
Deputy Conservator of Forests & Special Officer
Thrissur Zoological Park, Puthur
Chief Conservator of Forests
Central Circle & Special Officer
Thrissur Zoological Park

| DHOLE EXHIBIT AREA | |
|--------------------------------|--|
| EXHIBIT AREA | 1335.05 SQ.M. |
| FRONT BARRIER | V SHAPED (FLAT BOTTOMED) DRY MOAT 5M WIDTH, 2.6 M DEPTH AND INCLINED OVERHANG FENCE WITH 3 STRANDS OF HOT WIRE |
| REAR AND SIDE BARRIER | CHAIN LINK MESH FENCE TOTAL 3M HEIGHT - -2.5M HIGH GALVANIZED CHAIN LINK MESH FENCE, 5CM x 5CM x 8 G (4mm) FIXED ON EPOXY COATED MILD STEEL RECTANGULAR HOLLOW SECTIONS FOR STRUCTURAL STEEL POST, -ADDITIONAL OVER HANG 1M WIDE CHAIN LINK FENCE AND THREE STRINGS OF BARBED WIRE FIXED ON THE TOP OF THE FENCE INCLINED AT AN ANGLE OF 120° TO THE VERTICAL STRUCTURAL STEEL POST |
| CHAIN LINK MESH FIXING DETAILS | CHAIN LINK FENCE SHALL BE PLACED ON THE INNER SIDE OF THE STRUCTURAL POST AND SHALL BE EMBEDDED IN THE MASONRY BASE SLOPED BOTH WAYS TO PREVENT ACCUMULATION OF WATER AND URINE. |
| ENRICHMENT FEATURES | DEAD WOOD LOGS, NATURAL STONE BOULDERS, TREES SHRUBS ETC. |
| SERVICE ACCESS | ACCESS FOR SERVICE VEHICLES INTO THE EXHIBIT THROUGH A SERVICE GATE |
| OFF EXHIBIT HOLDING AREAS | |
| TOTAL AREA | 250.48 SQ.M. |
| EXERCISE YARD | 104.00 SQ.M. (TOP SHOULD BE OPEN) |
| KRAAL BUILDING | 121.98 SQ.M. |
| FEEDING CUBICLES | 6 NUMBERS, EACH OF MIN. SIZE 1.5M X 2M X 2.5M HEIGHT |
| ISOLATION AREA | ONE CUBICLE AND AN ISOLATION YARD (24.5 SQM) FOR SICK / INJURED ANIMALS |
| ACCESS | THE CUBICLES SHALL DIRECTLY OPEN IN TO THE EXHIBIT AREA |
| ENRICHMENT FEATURES | DEAD WOOD LOGS AND NATURAL STONE BOULDERS ETC |
| SERVICE ACCESS | ACCESS FOR SERVICE VEHICLES INTO THE KRAAL THROUGH A SERVICE GATE (2.5M WIDE), KEEPER ROOM (6.4 SQM), UTILITY ROOM (7.65 SQM) AND KEEPER AISLE (2.5M WIDE) |



COLLECTION PLAN as per CZA approved Master Plan of THRISSUR ZOOLOGICAL PARK dated 28.08.2012
List of CZA publications referred to for Exhibit and Barrier Standards

| ITEM | PUBLICATION NAME | PAGE NO. |
|------------------------|--|----------|
| Exhibit Area Standards | 1. Guidelines on Minimum Dimensions of Enclosures for Housing Exotic Animals of Different Species 2012 | 7 |
| | 2. Designing of Enclosures for Indian Zoos 2014 | 40,41 |
| Barrier Design | 1. Designing of Enclosures for Indian Zoos 2014 | 40,41 |
| | 2. Designing of Enclosures for Indian Zoos 2014 | 6 |
| Kraal details | 1. Guidelines on Minimum Dimensions of Enclosures for Housing Exotic Animals of Different Species 2012 | 40,41 |
| | 2. Designing of Enclosures for Indian Zoos 2014 | 40,41 |

Principal Chief Conservator of Forests (Wildlife) & Chief Wildlife Warden, Kerala

Deputy Conservator of Forests & Special Officer
Thrissur Zoological Park, Puthur
Chief Conservator of Forests
Central Circle & Special Officer
Thrissur Zoological Park

The drawings of the Dhole enclosure to be constructed at the Thrissur Zoological Park, Puthur, Kerala were approved by the 84th Meeting of the Expert Group on Zoo Designing of the Central Zoo Authority held on 07.05.2019, subject to conditions laid by the Central Zoo Authority vide its letter No. 19-113/92-GZA(140) Vol. I)(PKR)/827/2019, dated 20.05.2019.

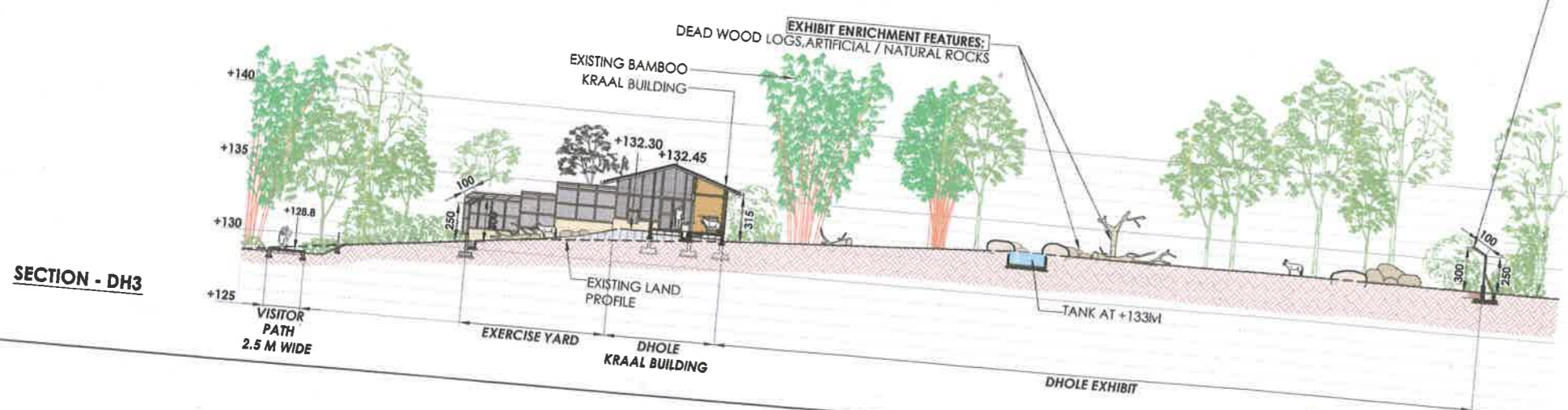
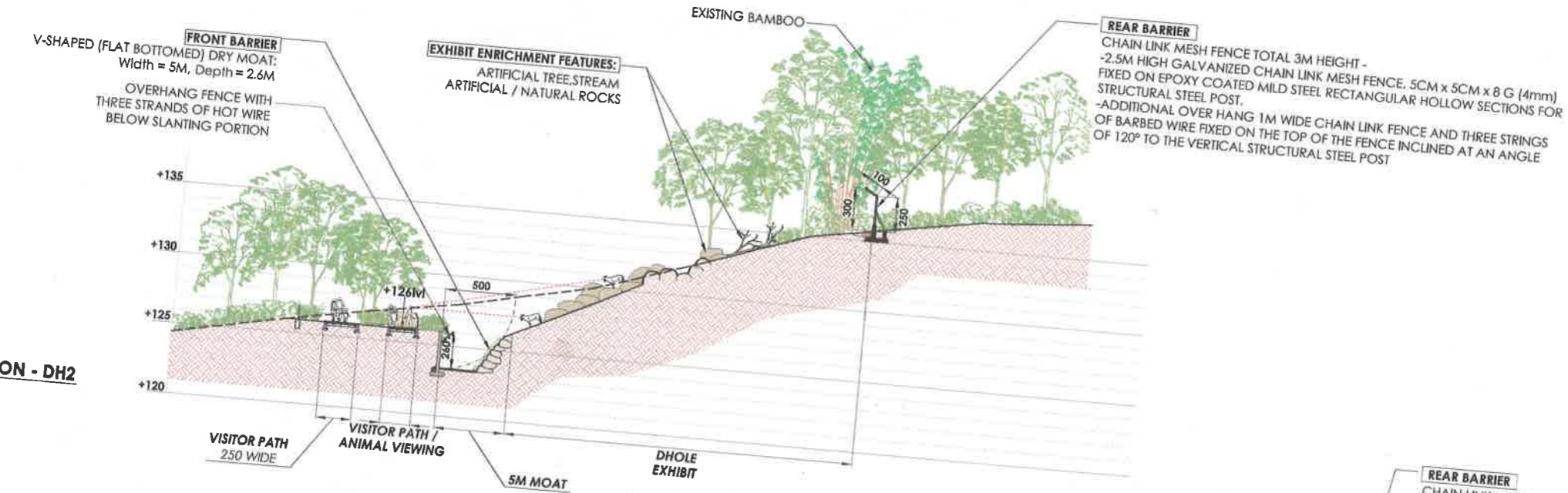
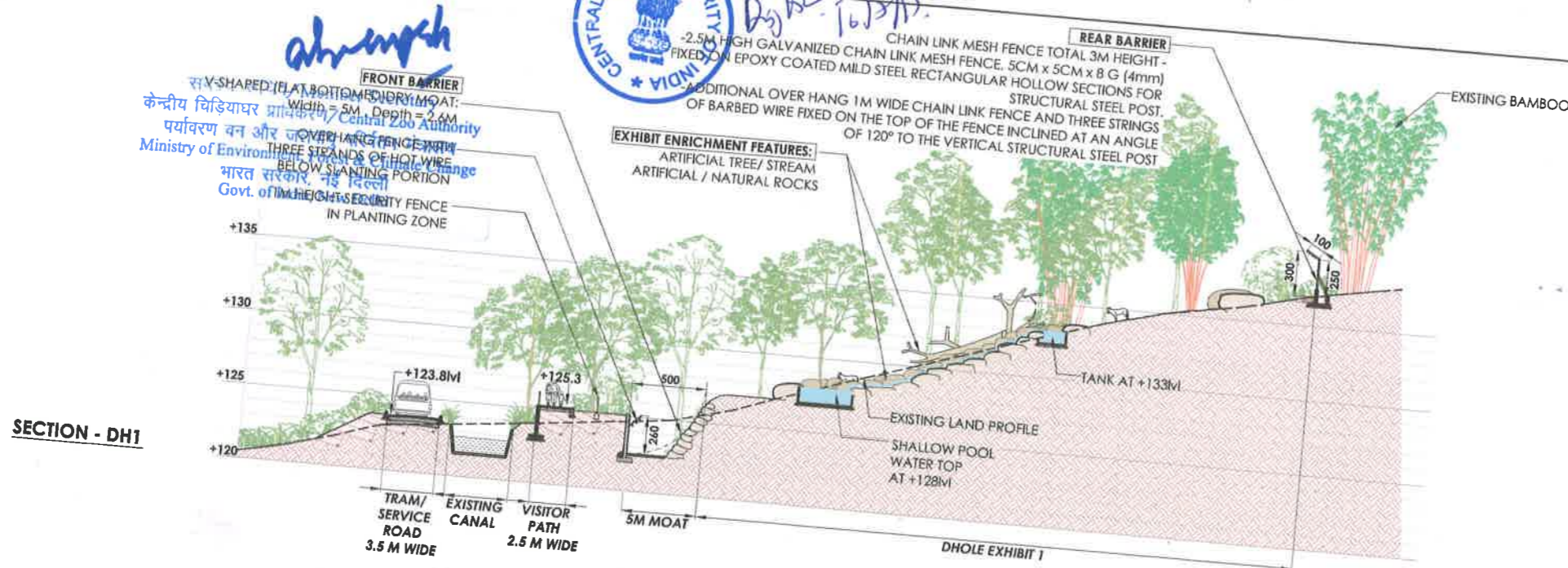

THRISSUR ZOOLOGICAL PARK
Wildlife Conservation & Research Centre, Puthur

DPR - STAGE 3:
DRAWINGS FOR STATUTORY APPROVAL

EXHIBIT NAME:
DHOLE

DRAWING TITLE:

EXHIBIT SECTION:

| | | |
|-------------------------------------|----------------------------|------------------|
| DRAWING NO: DPR/S3/DHL/04 | DATE: 20.12.2018 | REVISION: |
|-------------------------------------|----------------------------|------------------|

SCALE:
1:400 (A3)



REAR BARRIER
CHAIN LINK MESH FENCE TOTAL 3M HEIGHT -
-2.5M HIGH GALVANIZED CHAIN LINK MESH FENCE,
5CM x 5CM x 8 G (4mm) FIXED ON EPOXY COATED
MILD STEEL RECTANGULAR HOLLOW SECTIONS FOR
STRUCTURAL STEEL POST.
-ADDITIONAL OVER HANG 1M WIDE CHAIN LINK FENCE
AND THREE STRINGS OF BARBED WIRE FIXED ON THE
TOP OF THE FENCE INCLINED AT AN ANGLE
OF 120° TO THE VERTICAL STRUCTURAL STEEL POST

CONSULTANTS:
Jon Coe Design - Idea Design Consortium

Jon Coe Design Pty Ltd, Idea Design
250 Mt. Riddell Road
Healesville, VIC 3777
Australia
Email: jon@jonedesign.com Email: mail@ideadesign.org

Jon Charles Coe, AILA, PASLA, ARAZPA
Jon Coe Design Pty Ltd., Australia.

Biley E Menon, M Arch, AILA, ARUD
Idea Design, Cochin.

Chitra Biley, B Arch, MLA, AERCLA
Idea Design, Cochin.

Michael Little, MLA
Idea Design, Bangalore

Felix Varkeykunju, M.Tech
Spoton Engineering Software Services, Ernakulam

PROJECT BY:

Deputy
Deputy Conservator of Forests &
Special Officer
Thrissur Zoological Park, Puthur

Principal Chief Conservator of Forests

Ramm
KERALA FOREST DEPARTMENT,
GOVERNMENT OF KERALA
FOREST OFFICE, VAZHUPATHUR
THIRUVANANTHAPURAM