

The drawings of the Sloth bear enclosure to be constructed at the Thrissur Zoological Park, Puthur, Kerala were approved by the 84<sup>th</sup> Meeting of the Expert Group on Zoo Designing of the Central Zoo Authority held on 07.05.2019, subject to conditions laid by the Central Zoo Authority vide its letter No. 19-113/92-CZA(140)(Vol. I)(PKR)/827/2019, dated 20.05.2019.

*changed*

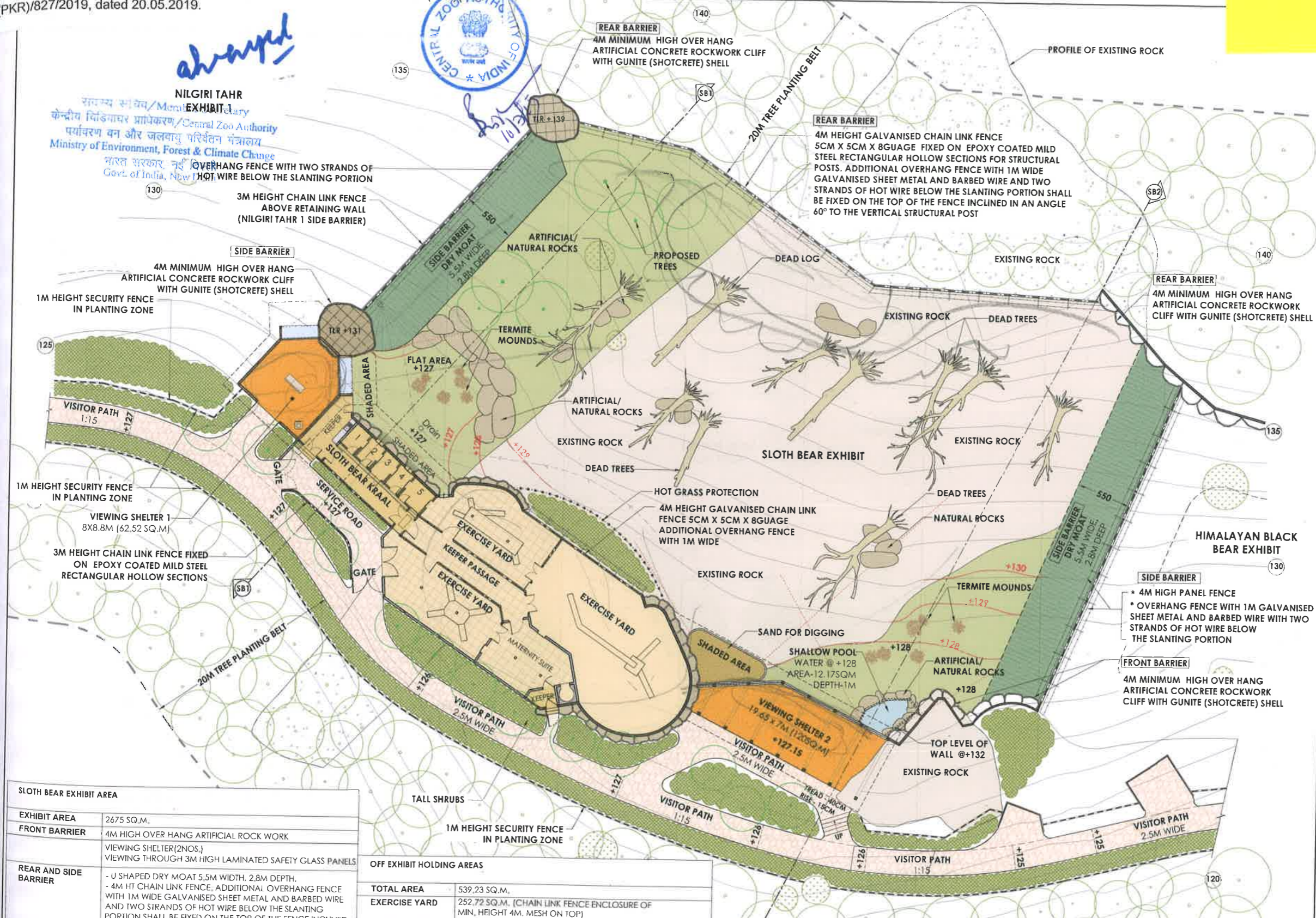

**NILGIRI TAHR**  
 EXHIBIT 1  
 संयुक्त संघ/Ministry of Environment, Forest & Climate Change  
 केन्द्रीय विज्ञान आयोग/Central Zoo Authority  
 पर्यावरण वन और जलवायु परिवर्तन मंत्रालय  
 Ministry of Environment, Forest & Climate Change  
 भारत सरकार, नई दिल्ली  
 Govt. of India, New Delhi



**THRISSUR ZOOLOGICAL PARK**  
 Wildlife Conservation & Research Centre, Puthur

DPR - STAGE 3:  
 DRAWINGS FOR STATUTORY APPROVAL  
 EXHIBIT NAME:  
 SLOTH BEAR  
 DRAWING TITLE:  
 EXHIBIT PLAN  
 DRAWING NO: DPR/S3/SB/02  
 DATE: 20.12.2018  
 REVISION:  
 SCALE:  
 1:400 (A3)

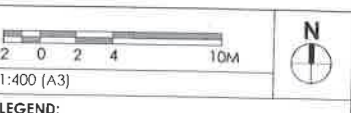

- LEGEND:**
- (130) EXISTING CONTOUR LEVEL
  - +127 PROPOSED LEVEL
  - TLR+130 TOP LEVEL OF ROCK
  - OVERHEAD MESH
  - (SB1) SECTION NAME
  - PROPOSED LOW PLANTING
  - PROPOSED PLANTING
  - PROPOSED ROCK
  - EXISTING ROCK
  - EXISTING BAMBOO
  - FENCE

**COLLECTION PLAN:**

MALE	FEMALE	TOTAL
1	2	3

**AREA STATEMENT:**

SLOTH BEAR EXHIBIT	2675 Sq.m
KRAAL (OFF EXHIBIT HOLDING AREAS)	539.23 Sq.m

**CONSULTANTS:**  
**Jon Coe Design - Idca Design Consortium**  
 Jon Coe Design Pty Ltd, Idca Design  
 250 Mt. Kildell Road, 301396-D, Narayan Assn Road  
 Healesville, VIC 3777, Vythira, Cochin, India - 685019  
 Australia Phone: +91 484 4036526, 4016526  
 Email: jon@jocodesign.com Email: mail@idcadesign.org

Jon Charles Coe, AILA, FASLA, ARAZPA  
 Jon Coe Design Pty Ltd, Australia.  
 Biley E Menon, M Arch, AIA, AICD  
 Idca Design, Cochin.  
 Chitra Biley, M Arch, MIA, AISOA  
 Idca Design, Cochin.  
 Michael Little, MIA  
 Idca Design, Bangalore  
 Felix Varkeykunjju, M Tech  
 Spotion Engineering Software Services, Ernakulam

**PROJECT BY:**  
 KERALA FOREST DEPARTMENT  
 GOVERNMENT OF KERALA  
 FOREST HEADQUARTERS, VAZHUTHIACAUD,  
 THIRUVANANTHAPURAM 695014,  
 KERALA, INDIA

**SLOTH BEAR EXHIBIT AREA**

EXHIBIT AREA	2675 SQ.M.
FRONT BARRIER	4M HIGH OVER HANG ARTIFICIAL ROCK WORK
REAR AND SIDE BARRIER	VIEWING SHELTER(2NOS.) VIEWING THROUGH 3M HIGH LAMINATED SAFETY GLASS PANELS
CHAIN LINK MESH FIXING DETAILS	- U SHAPED DRY MOAT 5.5M WIDTH, 2.8M DEPTH. - 4M HT CHAIN LINK FENCE, ADDITIONAL OVERHANG FENCE WITH 1M WIDE GALVANISED SHEET METAL AND BARBED WIRE AND TWO STRANDS OF HOT WIRE BELOW THE SLANTING PORTION SHALL BE FIXED ON THE TOP OF THE FENCE INCLINED IN AN ANGLE 60° TO THE VERTICAL STRUCTURAL POST - 4M MIN. HIGH OVERHANG ARTIFICIAL CONCRETE ROCK WORK CLIFF
ENRICHMENT FEATURES	CHAIN LINK FENCE SHALL BE PLACED ON THE INNER SIDE OF THE STRUCTURAL POST AND SHALL BE EMBEDDED IN THE MASONRY BASE SLOPED BOTH WAYS TO PREVENT ACCUMULATION OF WATER AND URINE. DEAD WOOD LOGS, DEAD TREES, ARTIFICIAL ROCK WORK ETC

**OFF EXHIBIT HOLDING AREAS**

TOTAL AREA	539.23 SQ.M.
EXERCISE YARD	252.72 SQ.M. (CHAIN LINK FENCE ENCLOSURE OF MIN. HEIGHT 4M, MESH ON TOP) 194.73 SQ.M. (OPEN ABOVE)
KRAAL BUILDING	91.78 SQ.M. (TOP COVERED)
FEEDING CUBICLES	5 NUMBERS, EACH OF MIN. SIZE 1.8M X 2.5M X 2.5M HEIGHT
CUBBING DEN	WITH 1.5M Ø CONCRETE PIPE AND CCTV FACILITY
ACCESS	THE CUBICLES SHALL DIRECTLY OPEN IN TO THE EXHIBIT AREA
ENRICHMENT FEATURES	DEAD WOOD LOGS, ROPES HUNG FROM THE ROOF SUPPORTS, PLATFORMS ETC
SERVICE ACCESS	ACCESS FOR SERVICE VEHICLES INTO THE KRAAL THROUGH A SERVICE GATE (3M WIDE) AND KEEPER AISLE (2.5M WIDE)

COLLECTION PLAN as per CZA approved Master Plan of THRISSUR ZOOLOGICAL PARK dated 28.08.2012  
 List of CZA publications referred to for Exhibit and Barrier Standards

ITEM	PUBLICATION NAME	PAGE NO.
Exhibit Area Standards	1. Guidelines on Minimum Dimensions of Enclosures for Housing Exotic Animals of Different Species 2012	7
	2. Designing of Enclosures for Indian Zoos 2014	45,46
Barrier Design	1. Barrier Designs for Zoos 2008	34, 35, 60
	2. Designing of Enclosures for Indian Zoos 2014	45,46
Kraal details	1. Guidelines on Minimum Dimensions of Enclosures for Housing Exotic Animals of Different Species 2012	5
	2. Designing of Enclosures for Indian Zoos 2014	45,46

Principal Chief Conservator of Forests (Wildlife) &  
 Chief Wildlife Warden, Kerala

Deputy Chief Conservator of Forests  
 Special Officer  
 Thrissur Zoological Park, Puthur  
 Chief Conservator of Forests  
 Central Circle & Special Officer  
 Thrissur Zoological Park



**THRISSUR ZOOLOGICAL PARK**  
Wildlife Conservation & Research Centre, Puthur

DPR - STAGE 3:

DRAWINGS FOR STATUTORY APPROVAL

EXHIBIT NAME:

SLOTH BEAR

DRAWING TITLE:

EXHIBIT SECTIONS

DRAWING NO: DATE: REVISION:

DPR/S3/SB/03 20.12.2018

SCALE:



1:400 (A3)

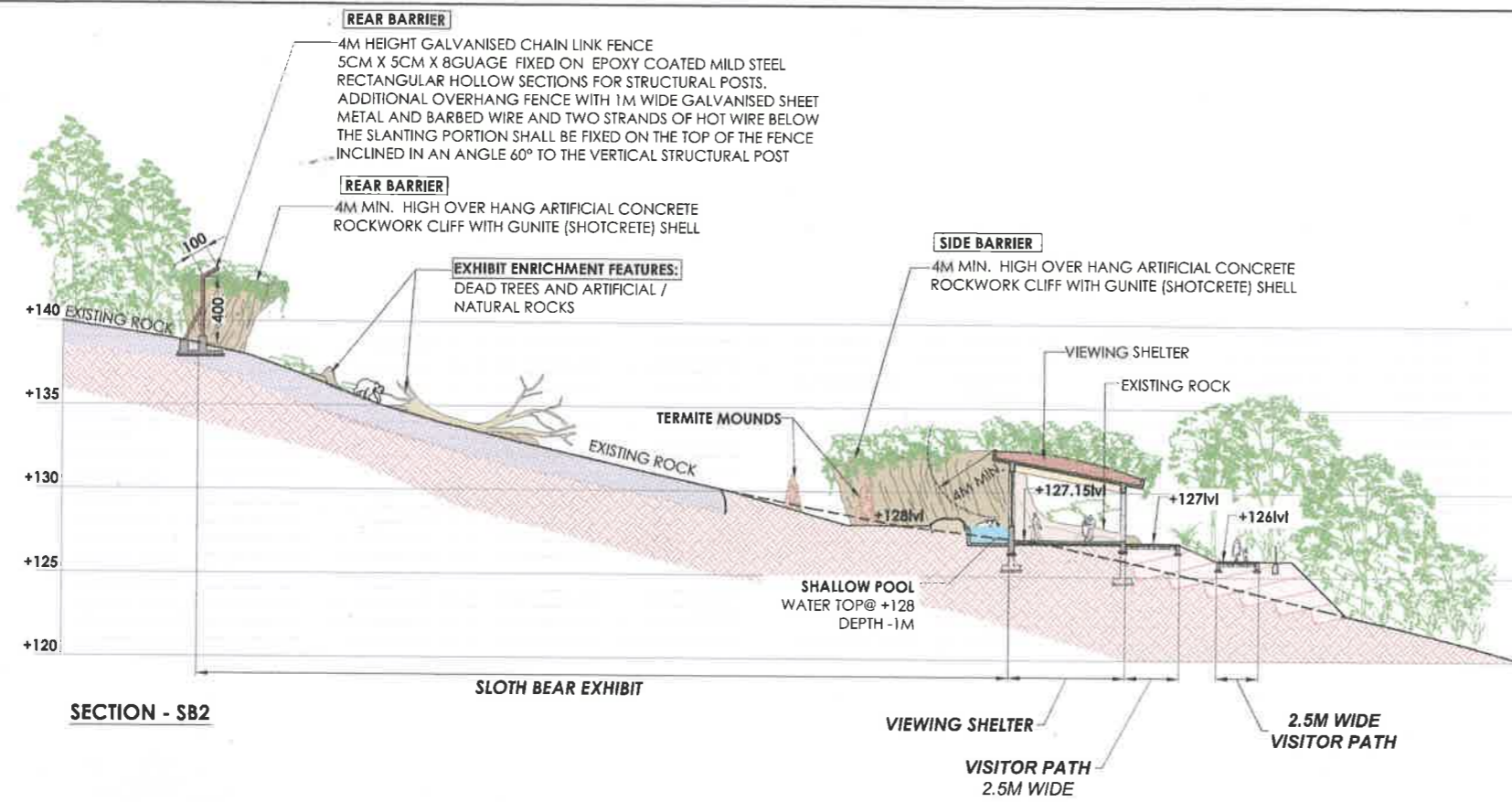

SECTION - SB2

SLOTH BEAR EXHIBIT

VIEWING SHELTER

VISITOR PATH  
2.5M WIDE

2.5M WIDE  
VISITOR PATH

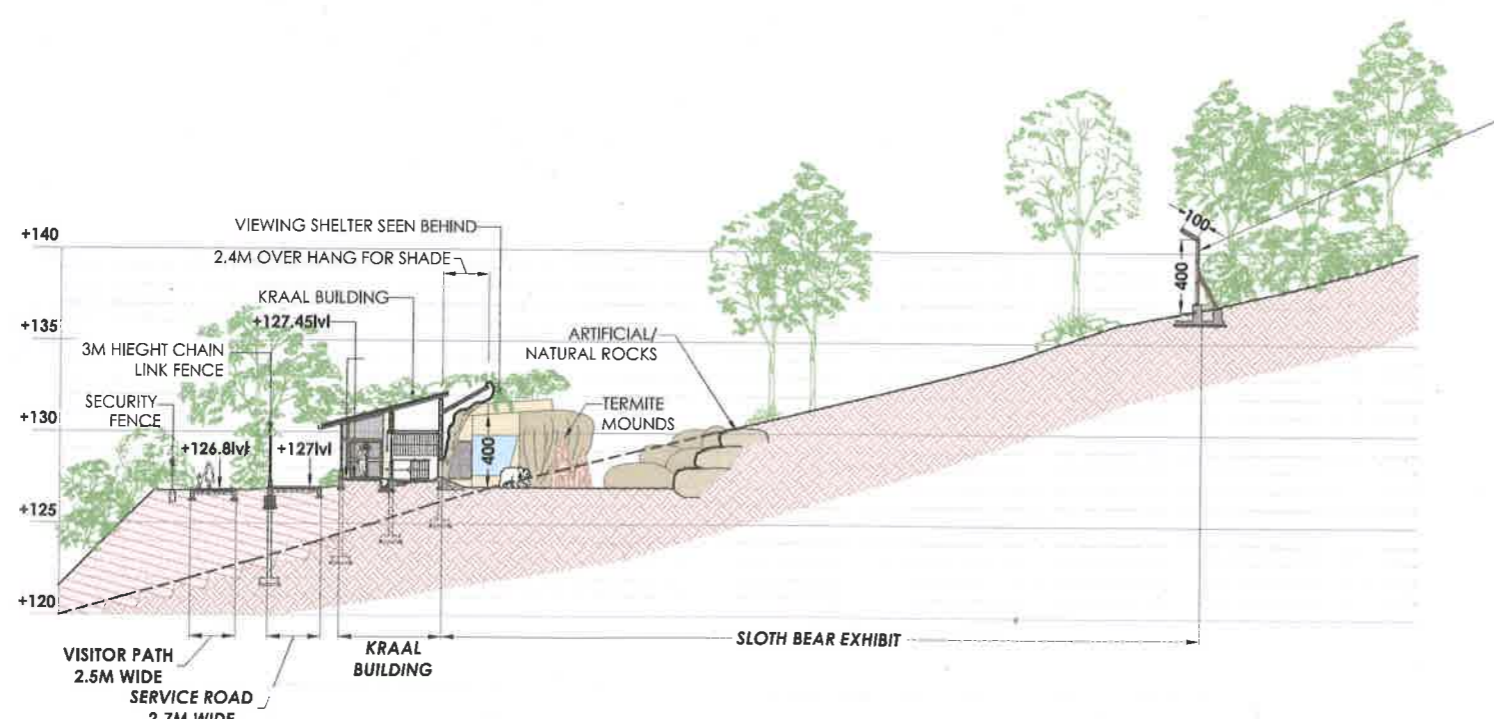

SECTION - SB1

The drawings of the Sloth bear enclosure to be constructed at the Thrikkur Zoological Park, Puthur, Kerala were approved by the 84<sup>th</sup> Meeting of the Expert Group on Zoo Designing of the Central Zoo Authority held on 07.05.2019, subject to conditions laid by the Central Zoo Authority vide its letter No. 19-113/92-CZA(140)(Vol. I)(PKR)/827/2019, dated 20.05.2019.

सदस्य सचिव/Member Secretary  
केन्द्रीय विज्ञानकार प्राधिकरण/Central Zoo Authority  
पर्यावरण वन और जलवायु परिवर्तन मंत्रालय  
Ministry of Environment, Forest & Climate Change  
भारत सरकार, नई दिल्ली  
Govt. of India, New Delhi



Principal Chief Conservator of Forests (Wildlife) &  
Chief Wildlife Warden, Kerala

Deputy Conservator of Forests  
Special Officer  
Thrikkur Zoological Park

KERALA FOREST DEPARTMENT  
GOVERNMENT OF KERALA  
FOREST HEADQUARTERS, VAZHUTHACAUD,  
THIRUVANANTHAPURAM - 695014  
KERALA, INDIA

Chief Conservator of Forests  
Central Circle & Special Officer  
Thrikkur Zoological Park