

# ASIATIC LION ENCLOSURE

The drawing of the Asiatic Lion enclosure to be constructed at the Shaheed Ashfaq Ullah Khan Zoological Park, Gorakhpur, Uttar Pradesh was approved by the Expert Group on Zoo Designing of the Central Zoo Authority in its 80<sup>th</sup> Meeting held on 26.12.2018 vide Agenda Item No. 3(VIII)(a) subject to conditions laid by the Central Zoo Authority vide letter dated F. No. 20-4/2008-CZA(Vol. III)(NS)/078/2019, dated 15.01.2019.

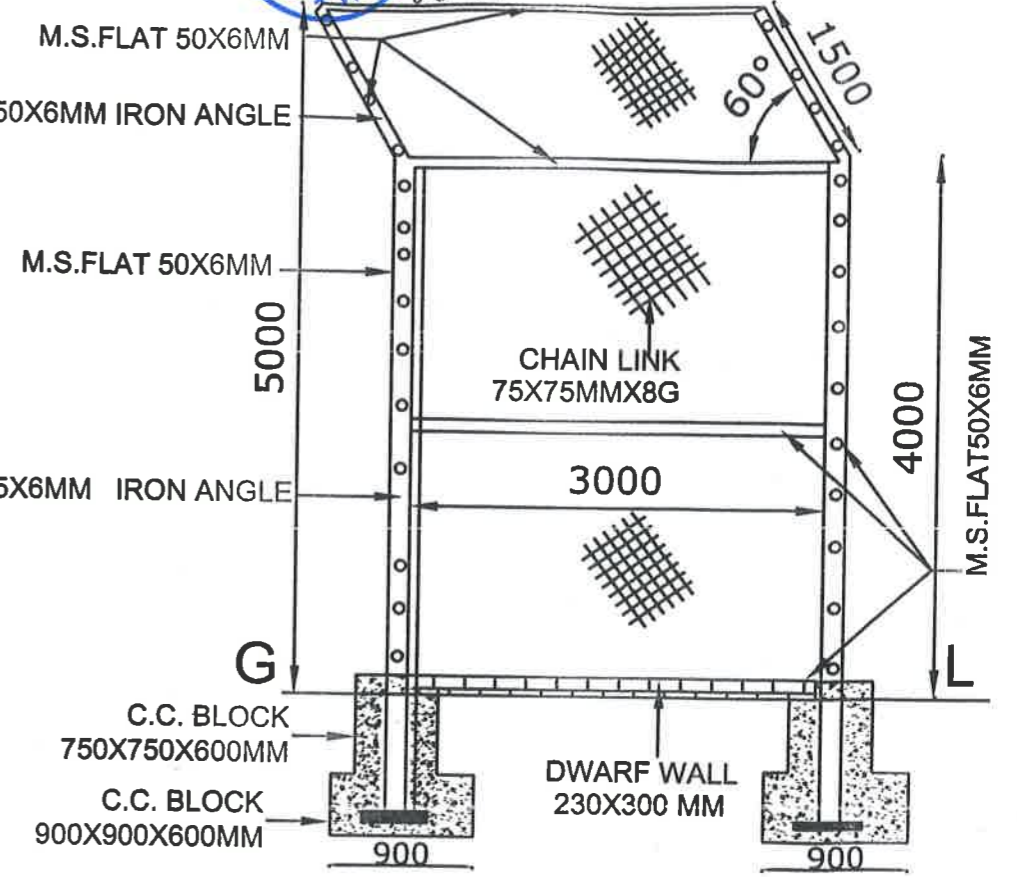

## CHAIN LINK FENCING

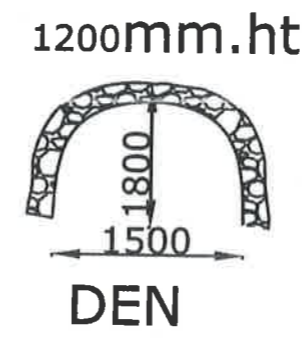
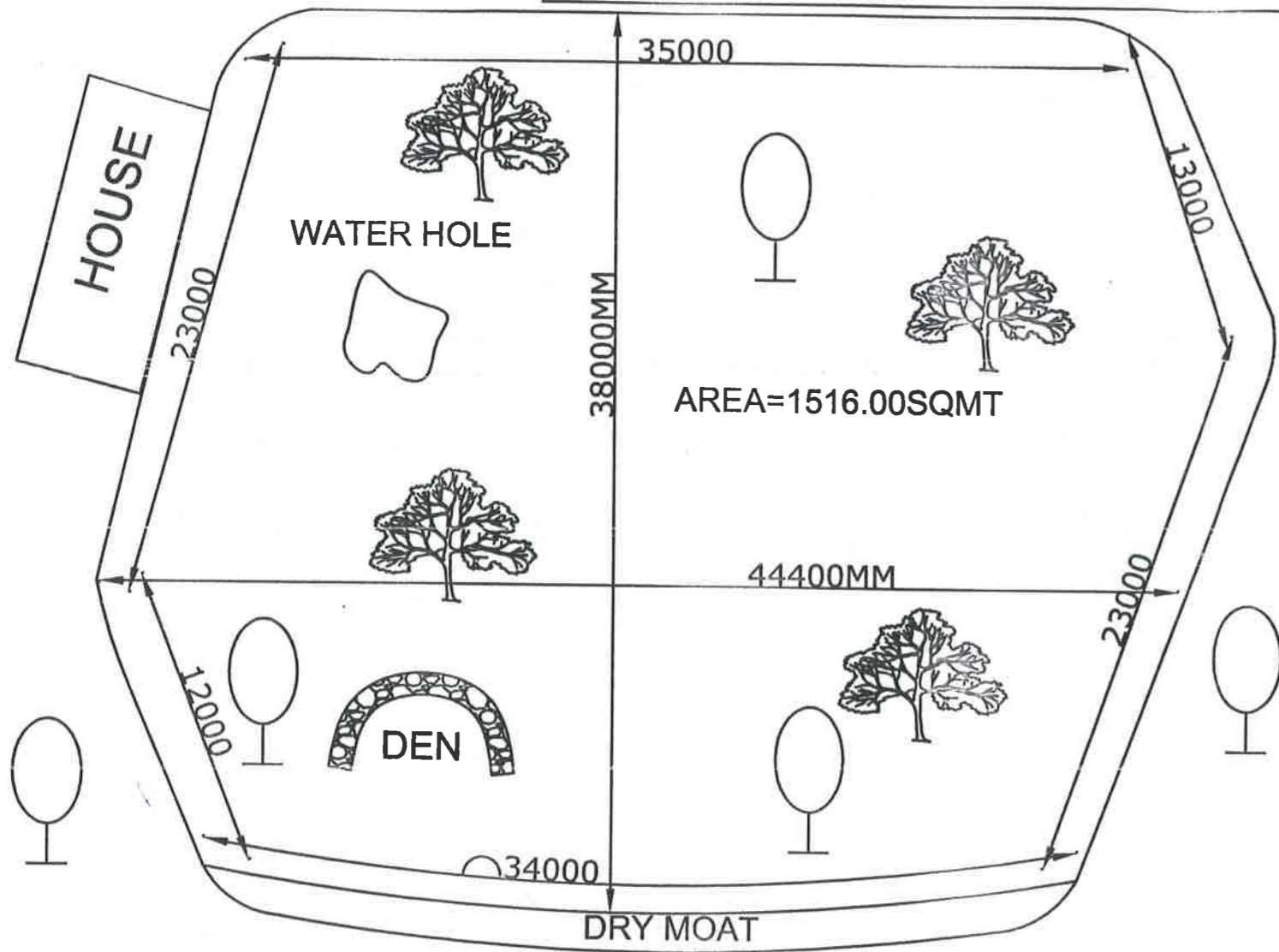
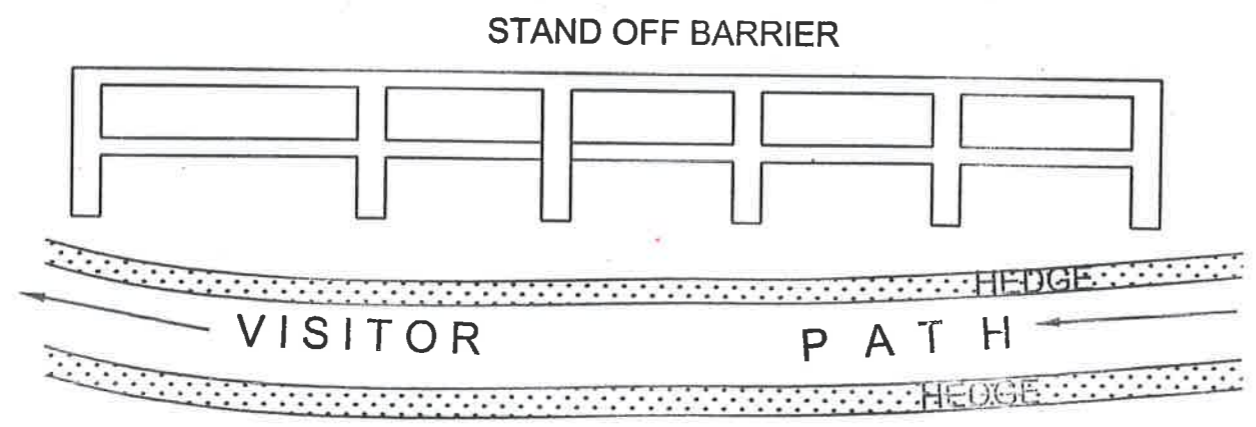

## LAYOUT

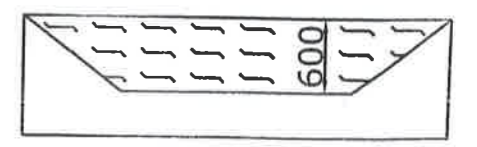
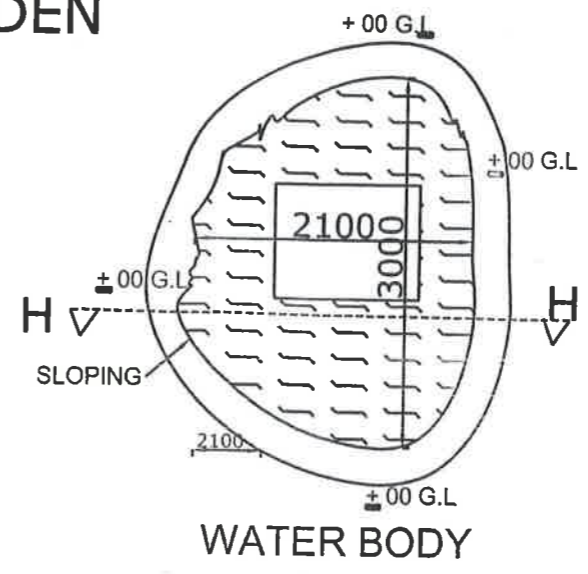

## SECTION - H-H

Director  
Shaheed Ashfaq Ullah Khan  
Prani Udyan, Gorakhpur

SHAHEED ASHFAQ ULLAH KHAN  
ZOOLOGICAL PARK GORAKHPUR

@COPYRIGHT RESERVED

NORTH



Drg title :

Scale :  
1:400

Drawn by:-  
HARI  
LUCKNOW

CONCEPT DESIGN BY

*Bhadauria*

R.S. BHADAURIA, I.F.S. [Retd.]  
LUCKNOW

Sunil Pandey  
P.C.C.F. Wild Life,  
S.K. PANDE  
D.P. Lucknow

CHIEF WILD LIFE WARDEN  
U.P. LUCKNOW



The drawing of the Asiatic Lion enclosure to be constructed at the Shaheed Ashfaq Ullah Khan Zoological Park, Gorakhpur, Uttar Pradesh was approved by the Expert Group on Zoo Designing of the Central Zoo Authority in its 80<sup>th</sup> Meeting held on 26.12.2018 vide Agenda Item No. 3(VIII)(a) subject to conditions laid by the Central Zoo Authority vide letter dated F. No. 20-4/2008-CZA(Vol. III)(NS)/078/2019, dated 15.01.2019.



# ASIATIC LION ENCLOSURE

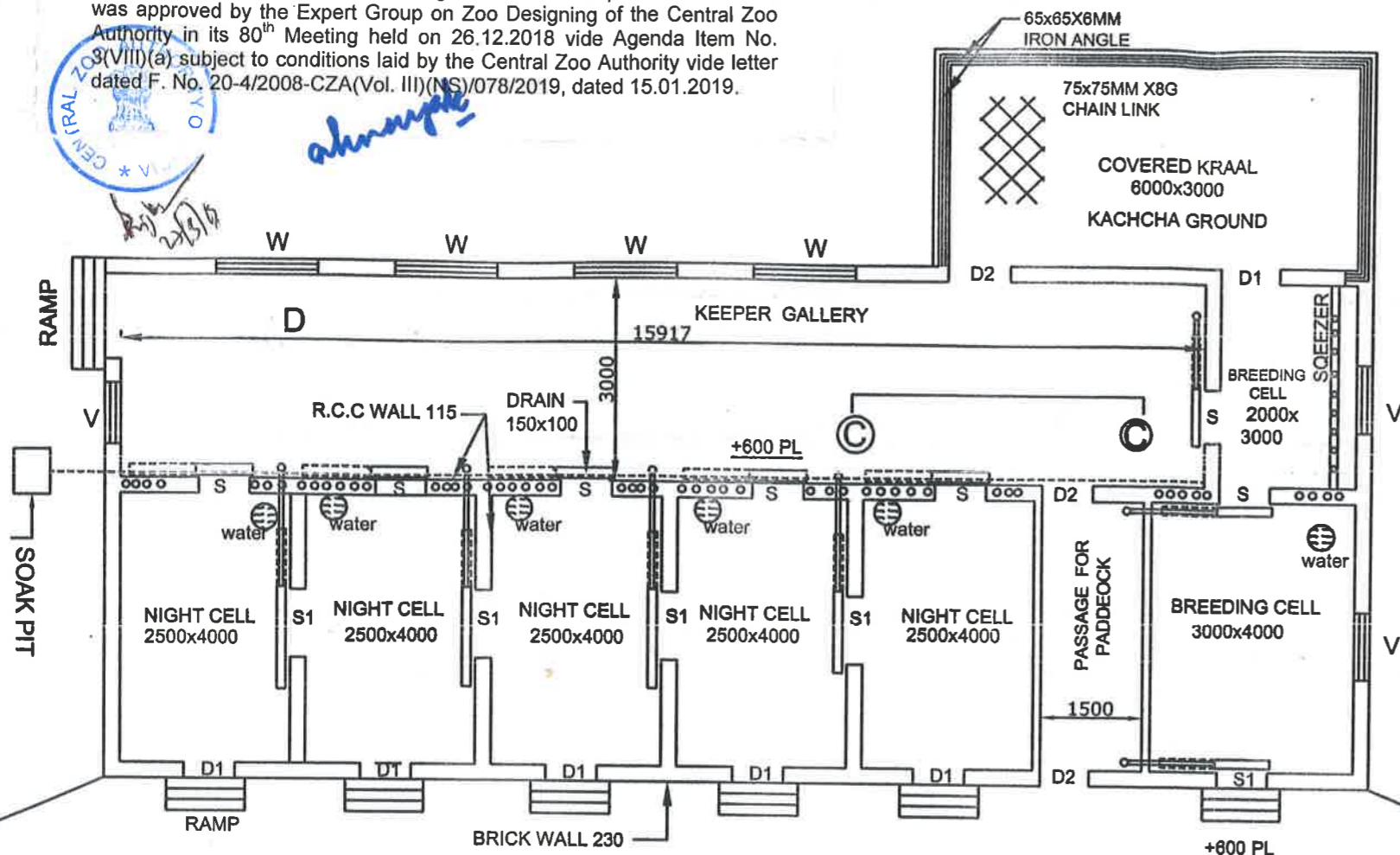

**P L A N**

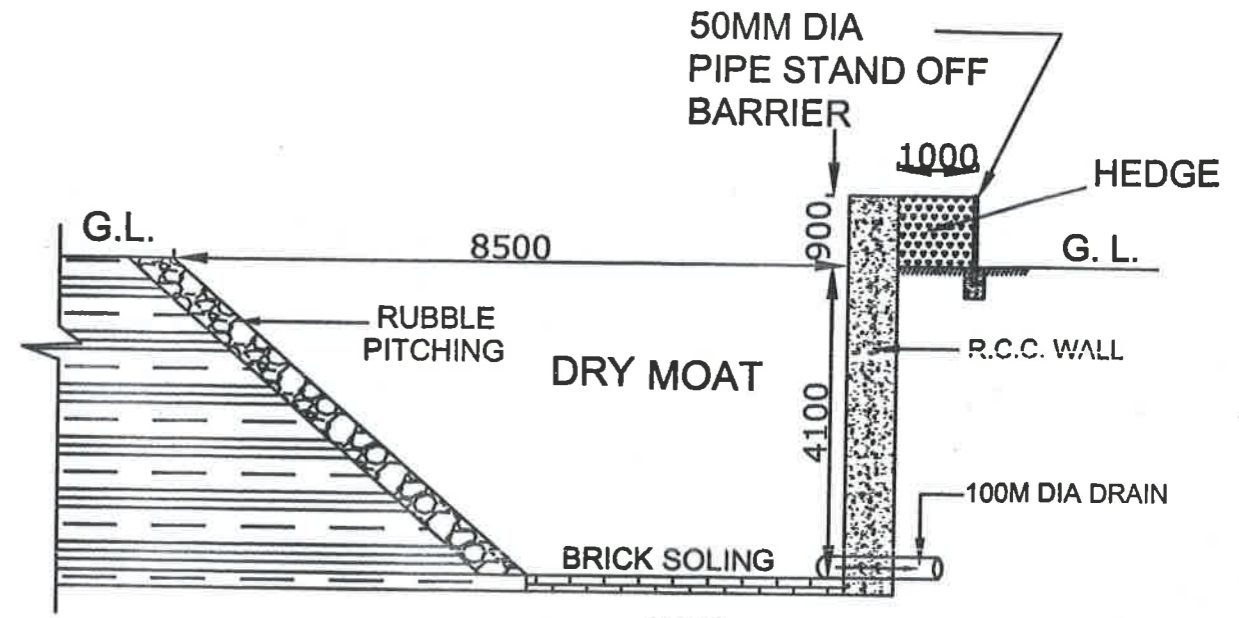

**SECTION OF MOAT**

Director  
Shaheed Ashfaq Ullah Khan  
Prani Udyan, Gorakhpur

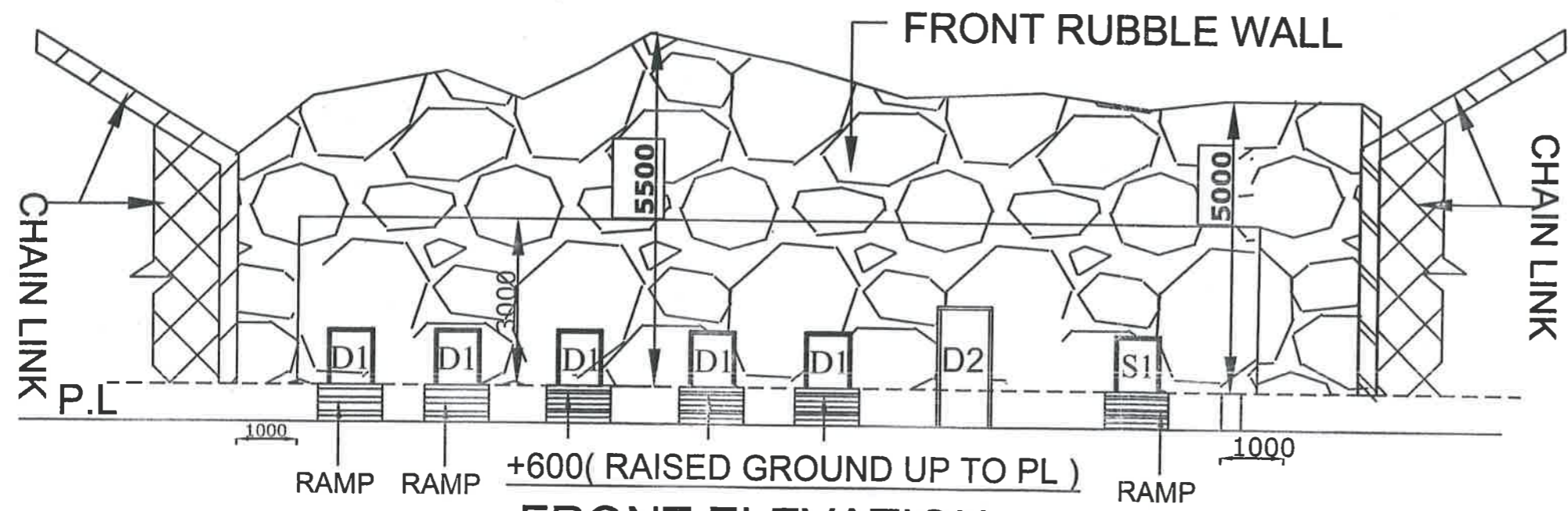

**FRONT ELEVATION**

## DOOR WINDOW SCHEDULE

NO.	NAME	SIZE (MM)	TYPE
1	D	1200X1950	DOUBLE MS HINGE DOOR
2	D1	750 X1000	DRAW UP SLIDING GRILL DOOR
3	D2	900X1950	MS HINGE DOOR
4	S	750 X1200	GRILL DOOR SLIDING
5	S1	750 X1200	MS SHEET SLIDING DOOR
6	W	1500 X1500	GRILL
7	V	750 X450	GRILL

**SHAHEED ASHFAQ ULLAH KHAN  
ZOOLOGICAL PARK GORAKHPUR**  
@COPYRIGHT RESERVED



Drg title :  
Scale :  
1:150  
Drawn by:-  
HARI  
LUCKNOW

CONCEPT DESIGN BY  
*Shadman*  
R.S. BHADOURIA, I.F.S. [Retd.]  
LUCKNOW

*Sunil Pandey*  
P.C.C.F. Wild Life,  
SUNIL PANDEY  
U.P. Lucknow  
CHIEF WILD LIFE WARDEN  
U.P. LUCKNOW



# ASIATIC LION ENCLOSURE

The drawing of the Asiatic Lion enclosure to be constructed at the Shaheed Ashfaq Ullah Khan Zoological Park, Gorakhpur, Uttar Pradesh was approved by the Expert Group on Zoo Designing of the Central Zoo Authority in its 80<sup>th</sup> Meeting held on 26.12.2018 vide Agenda Item No. 3(VIII)(a) subject to conditions laid by the Central Zoo Authority vide letter dated F. No. 20-4/2008-CZA(Vol. III)(NS)/078/2019, dated 15.01.2019.



*aharya*

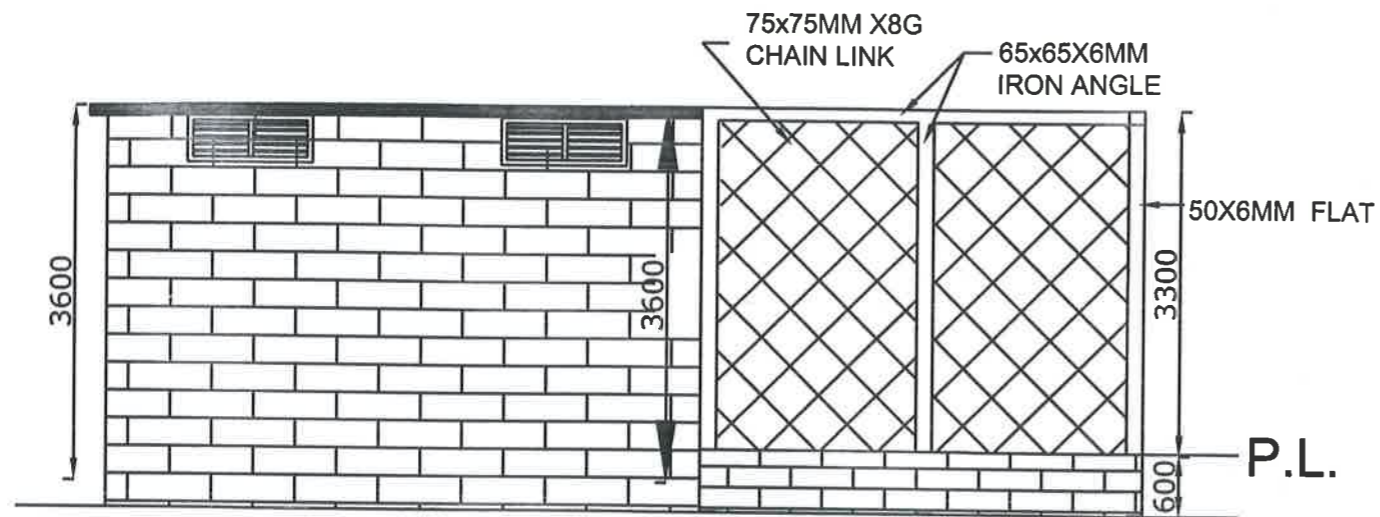

**ELEVATION  
RIGHT SIDE**

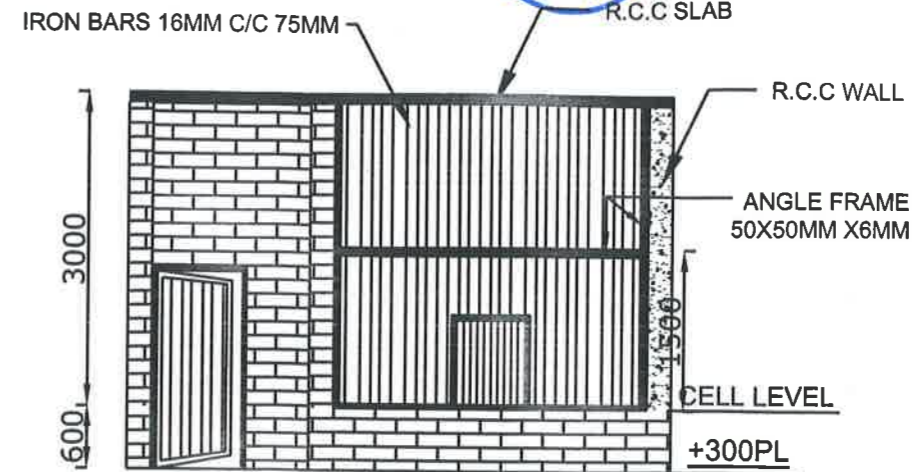

**ELEVATION  
OF NIGHT CELL AT C-C**

*Director*  
Shaheed Ashfaq Ullah Khan  
Prani Udyan, Gorakhpur

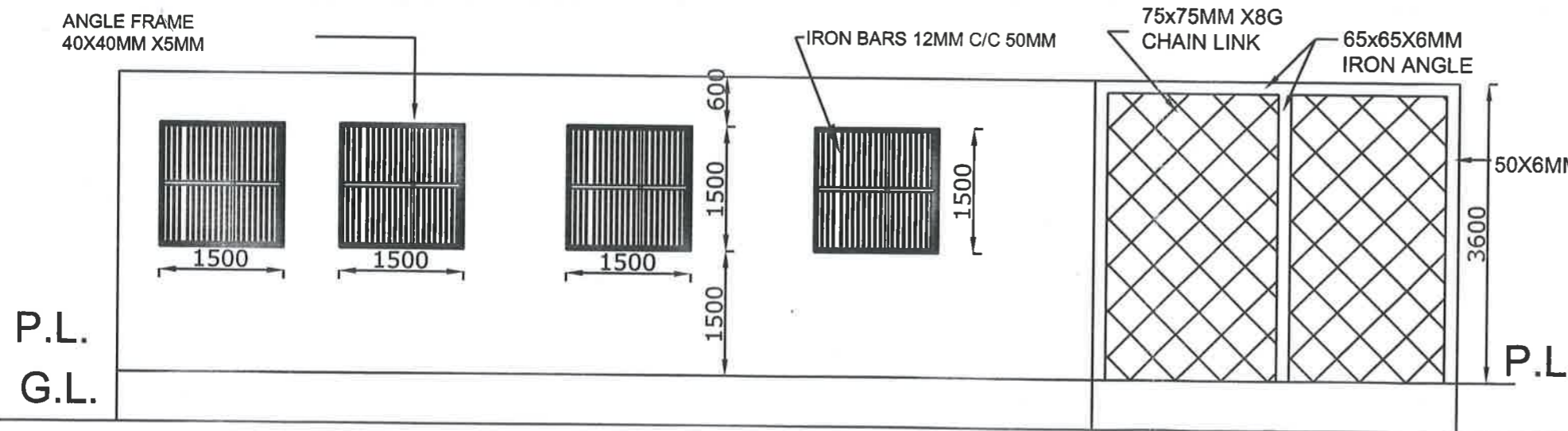

**BACK ELEVATION**

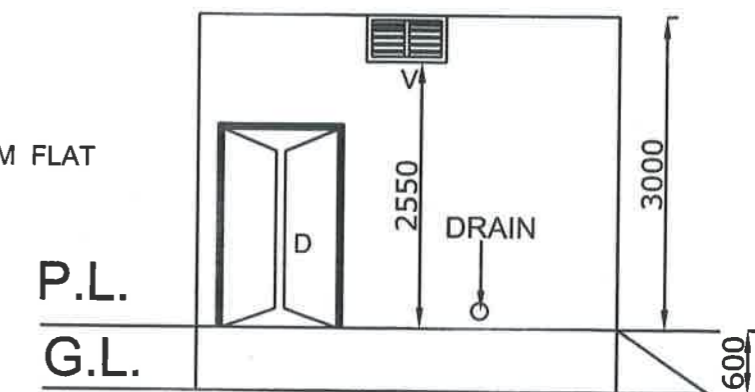

**ELEVATION  
LEFT SIDE**

**SHAHEED ASHFAQ ULLAH KHAN  
ZOOLOGICAL PARK GORAKHPUR**  
@COPYRIGHT RESERVED

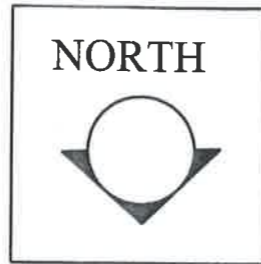

Drg title :  
Scale : 1:100  
Drawn by:- HARI  
LUCKNOW

CONCEPT DESIGN BY  
*R.S. Bhaduria*  
R.S. BHADURIA, I.F.S. [Retd.]  
LUCKNOW

*Sunil Pandey*  
SUNIL PANDEY  
CHIEF WILD LIFE WARDEN  
U.P. LUCKNOW