

# SLOTH BEAR SAFARI ETAWAH LAYOUT PLAN

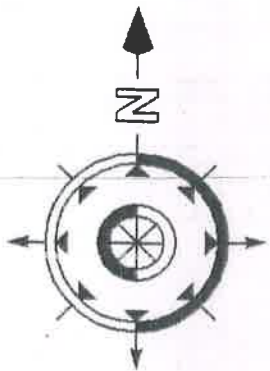

ENTRY/  
EXIT

ROAD

ROAD

EM.  
GATE

HOUSE

WP

SLOTH BEAR  
SAFARI  
21 Hectares

WP

WP

Approved by the Expert Group on Zoo Designing of the Central Zoo Authority in its 67<sup>th</sup> meeting held on 9<sup>th</sup> March, 2016 vide agenda item No.8.

Architects:

Vishal & Associates  
3/77, Viraj khand,  
Gomti Nagar, Lucknow  
Ph: 9839447965, 9839097571

SCALE-

N.T.S.

Dr. D. N. SINGH, IFS  
Member Secretary  
Central Zoo Authority  
Ministry of Environment, Forest & Climate Change  
Govt. of India, New Delhi-110003

*[Signature]*  
PCCF WILD LIFE  
UTTAR PRADESH LUCKNOW

*[Signature]*  
DIRECTOR,  
BEAR SAFARI PARK ETAWAH

# SLOTH BEAR SAFARI ENCLOSURE, ETAWAH

✓

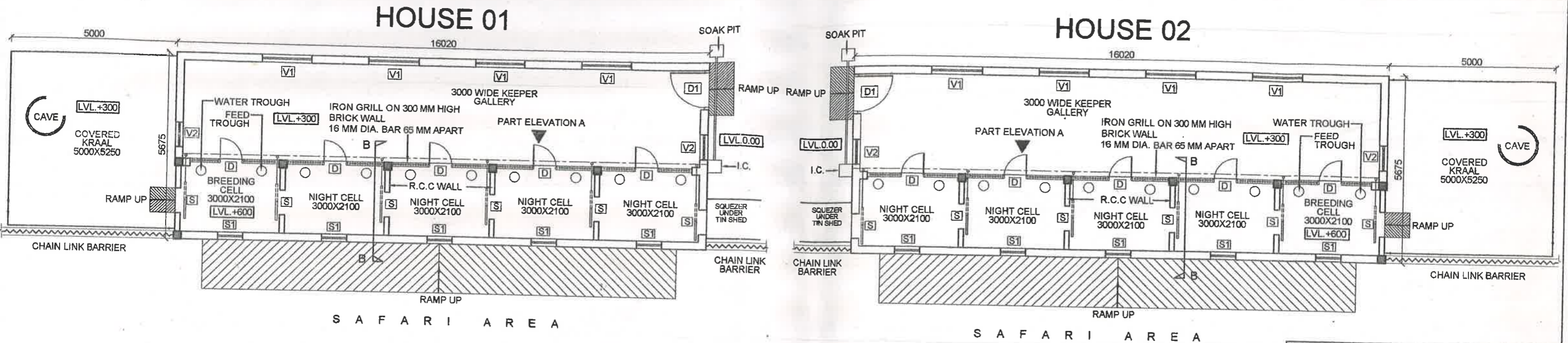

## GROUND FLOOR PLAN

Drg. No. ETAWAH/BEAR/AR/02

Project: SLOTH BEAR SAFARI ENCLOSURE, ETAWAH

Drg title: GROUND FLOOR PLAN (WORKING DRAWING)

Date: 29.04.16 Scale: NTS

Drawn By: Hari North:

Concept: Mr. R. S. BHADAURIA

Construction Agency: AWAS VIKAS, UTTAR PRADESH

Architects: Vishal & Associates  
3/77, Viraj khand, Gomti Nagar, Lucknow  
Ph: 9839447965, 9839097571

DOOR WINDOW SCHEDULE			
NO.	NAME	SIZE	TYPE
1	D1	1200X1800	HINGED DOOR (M.S. DOOR)
2	D	750X1200	HINGED DOOR (GRILLED)
3	S	750X900	SLIDING (S.L. STEEL SHEET) DOOR
4	S1	750X900	DRAW UP SLIDE (S.L. STEEL SHEET)
5	V1	1500X900	VENTILATOR
6	V2	750X600	VENTILATOR

REVISIONS	
Date	Description

*Handwritten signature*

310 रूपक डे  
प्रधान मुख्य वन संरक्षक, वन्य जीव  
उत्तर प्रदेश, लखनऊ

Approved by the Expert Group on Zoo Designing of the Central Zoo Authority in its 67<sup>th</sup> meeting held on 9<sup>th</sup> March, 2016 vide agenda item No. 8  
**Dr. D. N. SINGH, IAS**  
 Member Secretary  
 Central Zoo Authority  
 Ministry of Environment, Forest & Climate Change  
 Govt. of India, New Delhi-110003