



GOVERNMENT OF INDIA

MINISTRY OF ENVIRONMENT & FORESTS

Central Zoo Authority

2 copies 259

222



जहाँ है हरियाली।
वहाँ है खुशहाली।।

THROUGH REGISTERED POST

F. No. 19-62/92-CZA(27)(Vol. VII)(M) / 4231

DATE: 28.01.2014

To

The Director
Assam State Zoo,
Guwahati (Assam).

Sub:- Designs for the construction of various enclosures at Assam State Zoo, Guwahati.

Sir,

The designs for the construction of various enclosures at Assam State Zoo, Guwahati was placed before the 46th Meeting of the Expert Group on Zoo Designing of the Central Zoo Authority held on 3rd January, 2014. After detailed deliberation, the design was approved subject to the following:-

1. Sangai enclosure:-

The design was scrutinized and approved subject to following improvements:-

- Plan for movement of animals from outside into the enclosure.
- Peripheral boundary to be with chain link fencing in the wall of 300 mtrs.
- Drinking water trough to be provided inside house.
- RCC framed structure may not be required for small space structures.
- Sliding doors to squeeze cage be indicated.
- Walls of night shelter required to be indicated along with appropriate sliding doors.
- Kraal should be on side of the feeding cells with appropriate area.
- Feeding cells and house should not merge into paddock.
- There should be keepers' gallery.

....2/-

Bikaner House, Annexe VI, Shahjahan Road, New Delhi-110011

Phone : 011-23381585, 23073072, 23070375 (EPABX), Fax : +91-11-23386012

E-mail : cza@nic.in Website : <http://www.cza.nic.in>

OK
29/1/14

250
222

2. Pigmy Hog enclosure:-

The design is approved with the following changes :

- a) The front wall of the breeding cells should be 1.5 meters.
- b) Display and breeding area to be provided with drinking water trough.
- c) Vertical drop gates to be provided for entry to display / breeding cell from the shelter.
- d) All entry gates for animal to be vertical drop gates.
- e) Partition between display and breeding area shall be 0.5 meters wall with chain-link fence with connecting door with sliding door.
- f) Top cover with chain-link may not required.
- g) Edge boundary of breeding cell can be with chain-link fencing only.

3. Hippo enclosure:-

The design was scrutinized and approved with following suggestions :-

- a) Depth of tank should be minimum 1.50 / 2.0 mtrs.
- b) Tank/ water body area should be about 30% of the enclosure area.
- c) Width of corridor – not given. Should be adequate for entry of cage.
- d) Doors for animal entry should be sliding one.
- e) There should be about 3 mtr. wide land area close to the visitor area.
- f) Night shelter should be only one side instead of both sides as proposed.

4. Stump tailed macaque:-

The design was scrutinized and approved with changes that the chain link fence from the front is not required, since the water moat has been provided to restrict the visitors.

5. Serow enclosure :-

The design was scrutinized and approved subject to following improvements:-

- j) Plan for movement of animals from outside into the enclosure.
- k) Peripheral boundary to be with chain link fencing in the wall of 300 mtrs.
- l) Drinking water trough to be provided inside house.
- m) RCC framed structure may not be required for small space structures.
- n) Sliding doors to squeeze cage be indicated.

251
222

- o) Walls of night shelter required to be indicated along with appropriate sliding doors.
- p) Kraal should be on side of the feeding cells with appropriate area.
- q) Feeding cells and house should not merge into paddock.
- r) There should be keepers' gallery.

Keeping in view of the above, you are requested to submit amended copies of the designs for further scrutiny by this Authority and its approval.

Yours faithfully,
sd/-
(B. S. Bonal)
Member Secretary

Copy to the Chief Wildlife Warden, Government of Assam, Guwahati for favour of information and necessary action.

Forwarded by



(Dr. Brij Kishor Gupta)
Evaluation and Monitoring Officer

222

PROPOSED PIGMY HOG ENCLOSURE

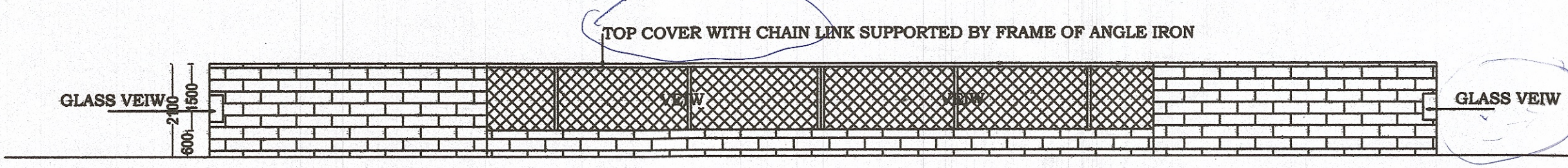

FRONT ELEVATION
SCALE : 1:300

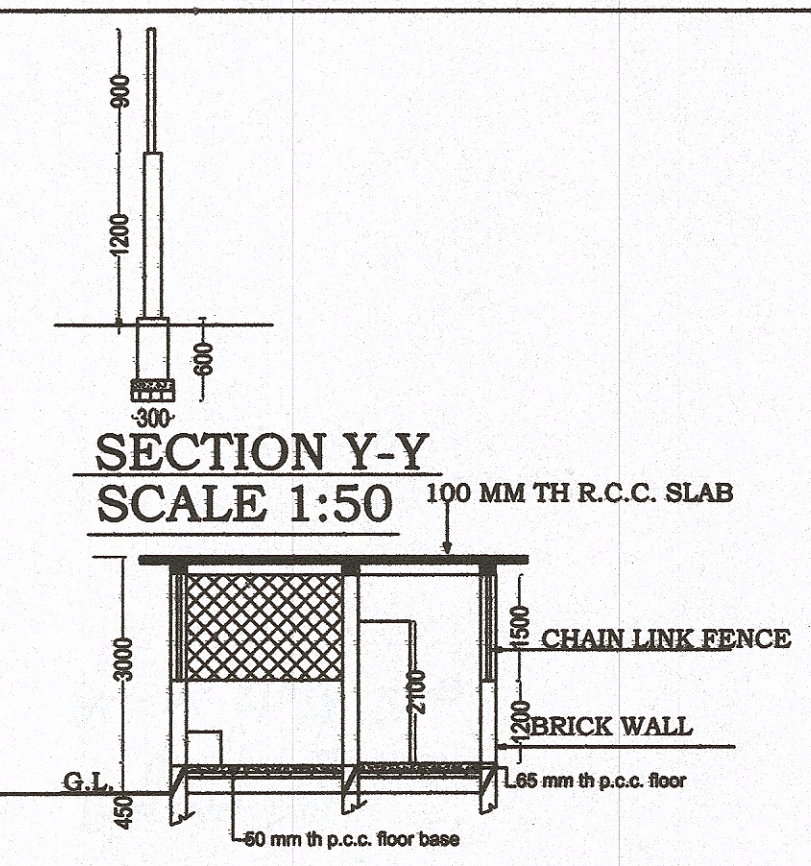

SECTION Y-Y
SCALE 1:50

SECTIONAL ELEVATION AT X-X
SCALE : 1:100

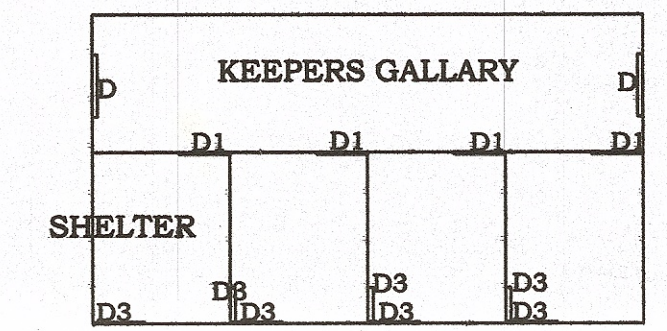

PLAN OF SHELTER
SCALE : 1:100

*A-41 off wall
- all inside
- 1/2 chain link down*

*Approved with
changes as follows*

1. Display & breeding areas to be provided with drinking water trough
2. Vertical drop gates to be provided for entry to display / breeding cell from the shelter
3. All entry gates to be vertical drop gates
4. Position between display and breeding area shall be of 0.5m high wall with chain link above
5. Top cover with chain link not required
6. Edge from boundary of breeding cell come into chain link fencing only.

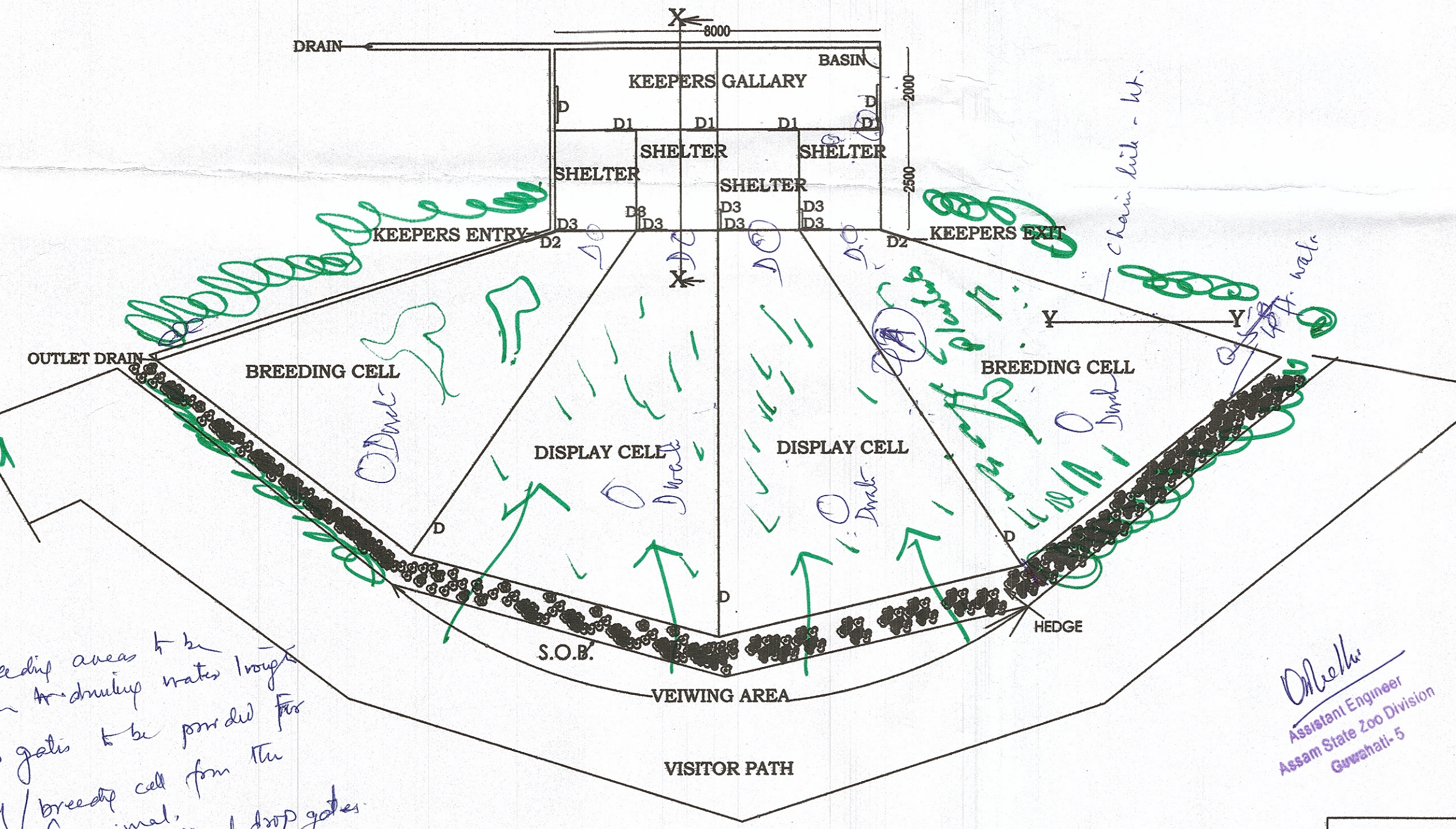

SITE PLAN OF PROPOSED PIGMY HOG ENCLOSURE
SCALE : 1:300

D. B. Kalita
Assistant Engineer
Assam State Zoo Division
Guwahati-5

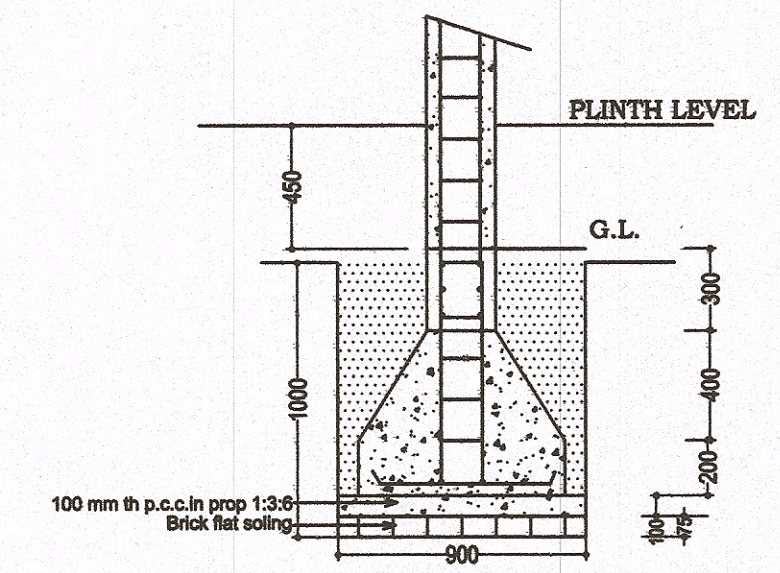

FOUNDATION SECTION OF NIGHT SHELTER
SCALE 1:50

D=900x2100 -2 nos
 D1.=750x2100-4NOS
 D2.=750x1200-2NOS
 D3=500x500 -7 NO

PROPOSED PIGMY HOG ENCLOSURE	
LOCATION: ASSAM STATE ZOO CUM BOTANICAL GARDEN GUWAHATI, ASSAM	
DRAWN BY: JUNU PRABHA KALITA	PREPARED BY: SRI. G.K. DEV. MEDHI Assistant Engineer Assam State Zoo Division Guwahati -
SCALE = 1:100, 50	DATE =

*23/01/14
16.75 mmtg. at 5.45 pm mtg. D*