



सत्यमेव जयते

GOVERNMENT OF INDIA  
MINISTRY OF ENVIRONMENT & FORESTS  
**Central Zoo Authority**

148

178



जहाँ है हरियाली।  
वहाँ है खुशहाली।।

F. No. 19-256/93-CZA(193)(Vol. III)(M)/2050

DATE: 20.12.2011

21

To

The Joint Secretary  
to the Government of Nagaland,  
Department of Forest, Ecology, Environment and Wildlife,  
Kohima (Nagaland)

**Sub:- Construction of enclosures at Nagaland Zoological Park, Rangapahar.**

**Ref:- Your office letter No. FOR/WORKS-1/2001(Pt) dated 14.10.2011.**

Sir,

Reference is invited to the aforesaid proposal.

The designs for the construction of enclosures for Great Indian hornbill, Barking deer, Hoolock gibbon, Fox, Common leopard, Stump tailed macaque, Burmese tortoise, Jungle cat and 2.5 km metalled by pass road at Nagaland Zoological Park, Rangapahar were placed before the Meeting of the Expert Group on Zoo Designing of the Central Zoo Authority held on 12<sup>th</sup> December, 2011. The observations of the committee are given below:-

(i) Construction of Great Indian hornbill enclosure

The design was approved subject to the following amendments as indicated in plan:-

- One third portion of the roof should be covered to protect the birds during the monsoon.
- The areas for roosting and nesting of birds should be provided in such a way that the birds are protected from rain. An appropriate perches using natural material available locally should be provided along with the live plants and trees inside the enclosure as an environmental enrichment.

Keeping in view of the above, revised design should be submitted to the Central Zoo Authority for records. A copy of the design indicating the necessary amendments to made are enclosed herewith for your perusal.

(ii) Construction of Barking deer enclosure

The design was not approved, as the plan of the enclosure is not attached, however, the following observations were made:-

- The location for feeding and retiring cells should be shown.

dlc  
Issued  
21/12/11

148

180

- (a) The width of the inclined sheet use as a barrier should not be less than 2.5 meter.
- (b) The D-4 should be located side wise and D-5 should be used as a lifting door.
- (c) The squeeze cage should be located inside attached with a cell and should be of small in size.
- (d) The kraal should be kept outside of the feeding and retiring cells and the kraal location should be interchanged with squeeze cage.

Keeping in view of the above, revised design should be submitted to the Central Zoo Authority for records. A copy of the design indicating the necessary amendments to made are enclosed herewith for your perusal.

(vi) Construction of Stump tailed macaque enclosure

The design was approved subject to the following amendments as depicted in the plan:-

- (a) No cement and concrete should be used in paddock area to construct mounds etc.
- (b) The kraal should be increased in size.
- (c) There should be no swing door in the feeding retiring cells towards keepers gallery.
- (d) All the feeding retiring cells (except the middle one) should have fixed iron bares instead of using chain-link mesh of an appropriate size and thickness. The feeding and retiring cells located in the middle should have a drop slide in front and sliding door on both the sides.

Keeping in view of the above, revised design should be submitted to the Central Zoo Authority for records. A copy of the design indicating the necessary amendments to made are enclosed herewith for your perusal.

(vii) Construction of Burmese tortoise enclosure

The design was approved, subject to the following amendments as depicted in the plan:-

- (a) The height of the chain-link fence should be kept only 1.5 meter.
- (b) The height of the toe wall should be 0.5 meter only.

Keeping in view of the above, revised design should be submitted to the Central Zoo Authority for records. A copy of the design indicating the necessary amendments to made are enclosed herewith for your perusal.

(viii) Construction of Jungle cat enclosure

The design was not approved, however the following observations were made:-

- (a) The minimum paddock area for housing the Jungle cat should be of 150-200 sq. meters.
- (b) The feeding and retiring cells should be of the size of 2x1.5 meters.

148

# NAGALAND ZOOLOGICAL PARK, RANGAPAHAR.

## HOOLOCK GIBBON ENCLOSURE

(CROSS SECTION OF NET MOUNT)

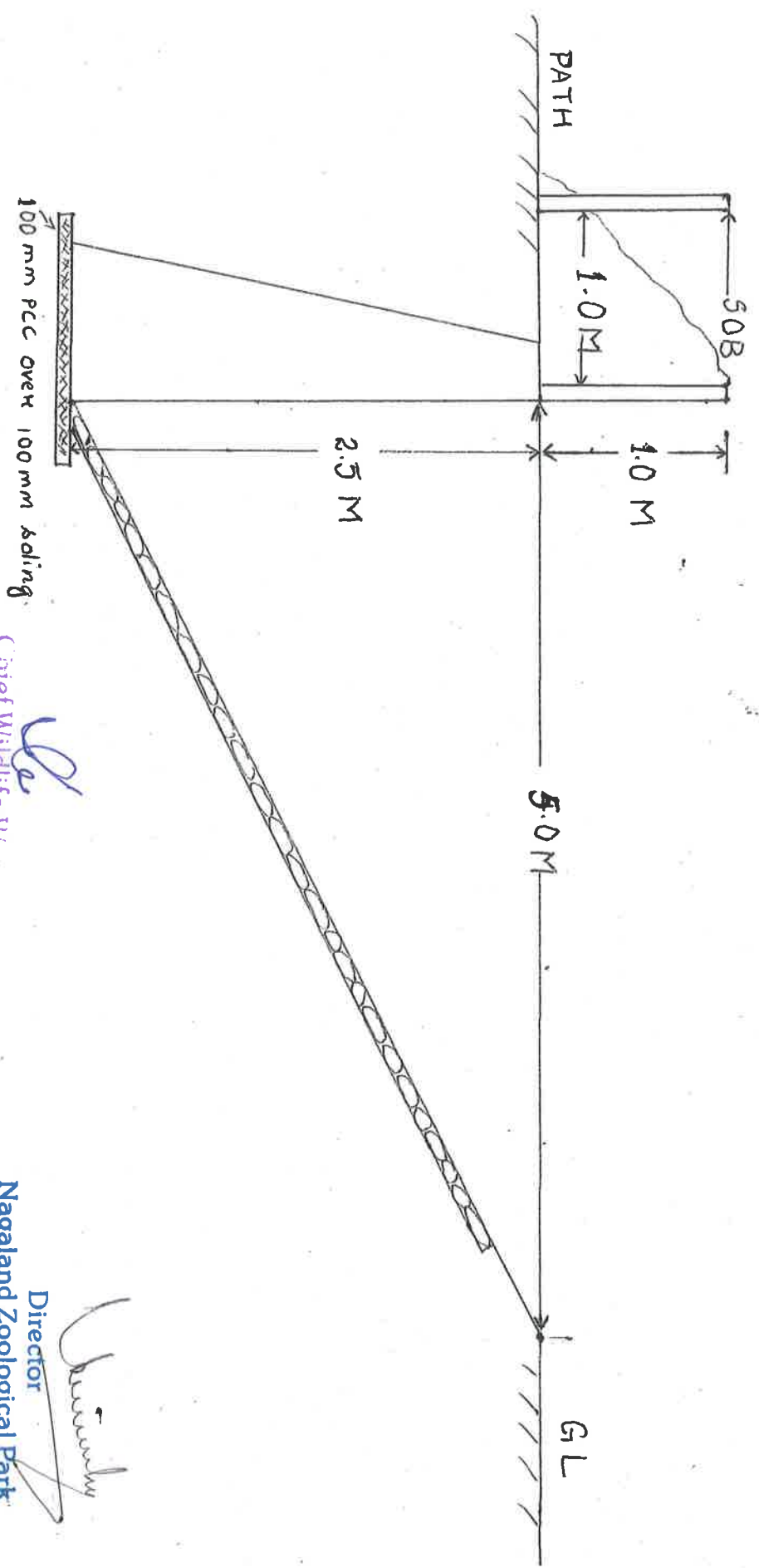

*[Signature]*  
Chief Wildlife Warden  
Nagaland - Dimapur

*[Signature]*  
Director  
Nagaland Zoological Park  
Rangapahar, Nagaland

NAGALAND ZOOLOGICAL PARK, RANGAPAHAR  
HOOLOCK GIBBON ENCLOSURE  
(ANIMAL HOUSE)

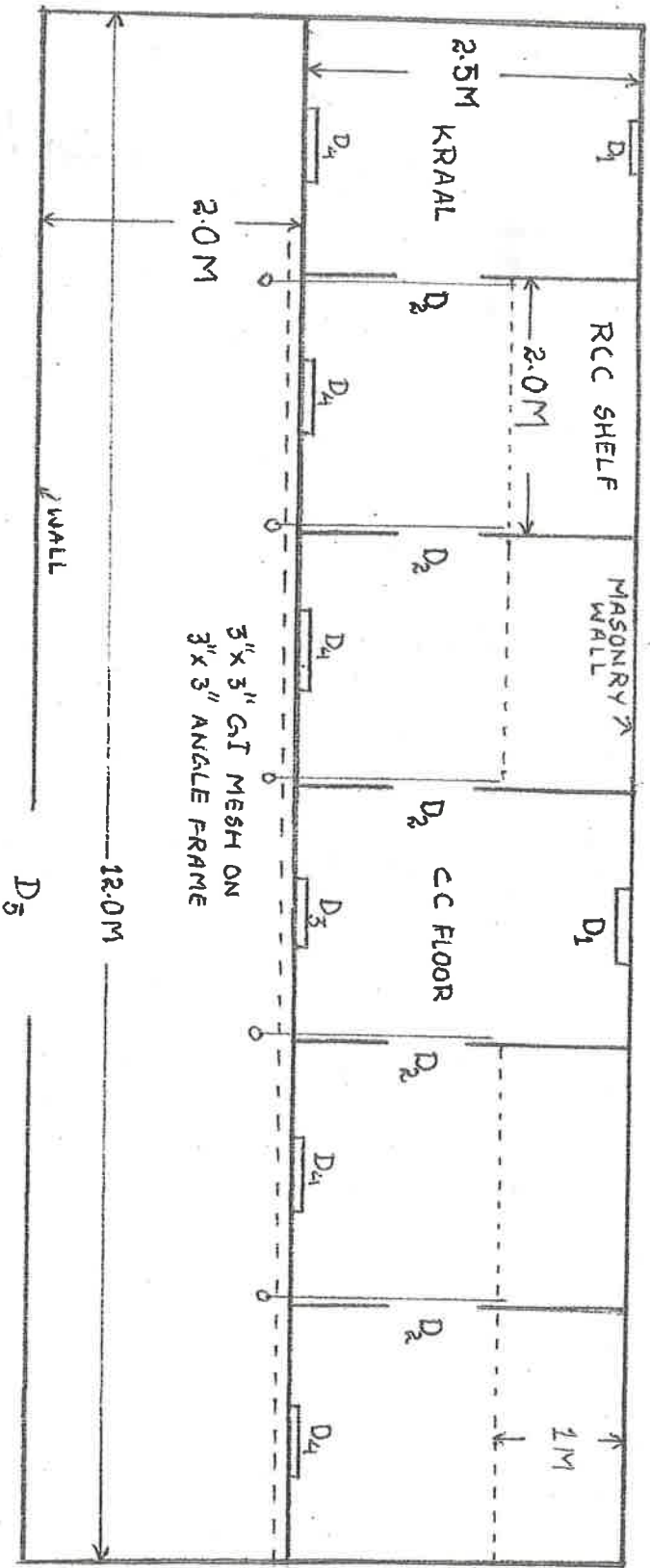

PLAN

Chief Wildlife Warden  
Nagaland : Dimapur

Director  
Nagaland Zoological Park  
Rangapahar, Nagaland

- DOORS OF ANGLE FRAME  
IN 3"x3" GI MESH
- D<sub>1</sub> → 0.6 X 0.8 M LIFTING
  - D<sub>2</sub> → 0.6 X 0.8 M SLIDING
  - D<sub>3</sub> → 1.0 X 2.0 M SWING.
  - D<sub>4</sub> → 0.8 X 2.0 M SWING.
  - D<sub>5</sub> → 2.0 X 2.0 M SWING.

148

NAGALAND ZOOLOGICAL PARK, RANGAPPAHAR  
 HOOLOCK GIBBON ENCLASURE  
 (PLAN)

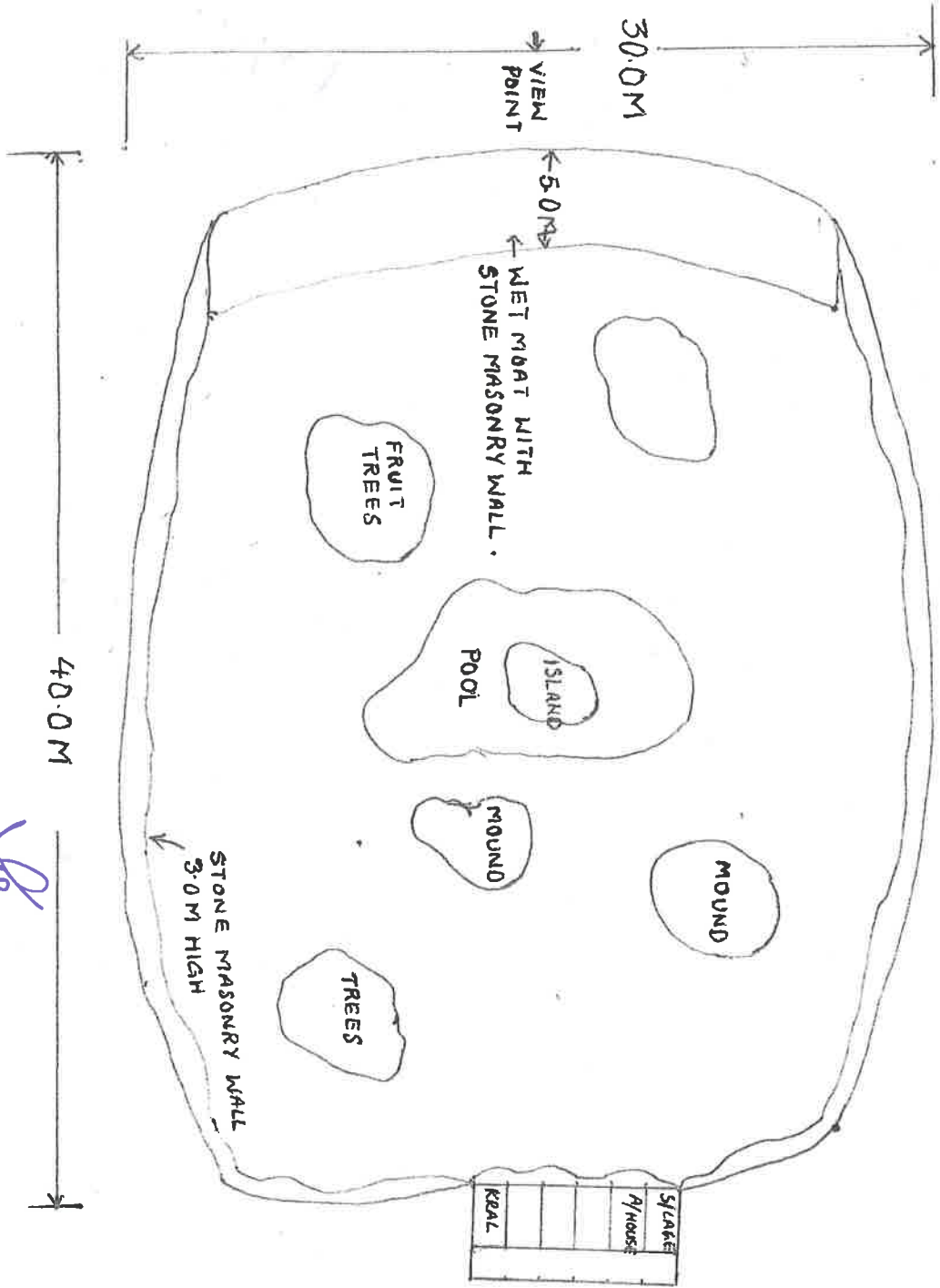

Chief Wildlife Warden  
 Nagaland - Dimapur

Director  
 Nagaland Zoological Park  
 Rangapahar, Nagaland

148