

2.5 m depth in center

Chain link Fence 50mm X 50mm X 10g 2 mtr high fixed on 50x50x6mm post on 375mm th. & 600mm high jodhpur stone masonry

[Signature]
 Member Secretary
 Central Zoo Authority
 (Ministry of Environment & Forests)
 Govt. of India, New Delhi

The 'FORMS'
 architecture
 4-ga-18, jaipur
 ph: 26521800
 e mail: kavita_design@yahoo.co.in

[Signature]
 Project Director
 R. S. R. D. C. Ltd.
 JODHPUR

PLAN GRID SIZE
 20M X 20 M

CROCODILE-GARIYAL ENCLOSURE

PROJECT
 PROPOSED SATELLITE MACHIA
 BIOLOGICAL PARK, JODHPUR

NOTES:
 CLIENT
 RSRDC
 PREPARED BY
 The 'FORMS', JAIPUR



| NO. | DATE | REVISIONS | BY | CH. |
|-----|----------|--|----|-----|
| 1 | 15-04-10 | Detail drawings submitted | | |
| 2 | 11-06-10 | After discussion with IFO and CZAI | | |
| 3 | 15-11-10 | After CZAI expert committee visit | | |
| 4 | 23-01-11 | After CZAI expert committee comments | | |
| 5 | 07-07-11 | Sizes changed after discussion and comments from PCC, CCP and DFO. | | |
| 6 | 29-07-11 | Sizes changed after discussion and comments from PCC, APCCF and DFO. | | |

| PROPOSAL PLAN | CROCODILE-GARIYAL |
|--|-------------------------|
| Checked by:- Kavita Jain | Made By:- AJAY KUMAR |
| DATE: 06 MARCH 2012 | SCALE: 1:300 |
| Drawing No. Biopark-Machia-CROCODILE & GHARIYAL-01 | |

CONSULTANTS
 Kavita Jain
 B Arch (Dist.), M Arch (Conservation)
 The 'FORMS'
 4-GA-18, JAWAHAR NAGAR,
 JAIPUR (RAJ), INDIA.
 Ph: +91 141 2621085, 98290 29300
 E MAIL: kavita_design@yahoo.co.in

Architecture
 Conservation
 Landscape
 Interiors

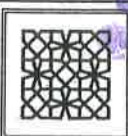

[Signature]
 Project Director
 R. S. R. D. C. Ltd.
 JODHPUR

128

Chain link Fence 50mm X 50mm X 10g 2 mtr high fixed on 50x50x6mm post on 375mm th. & 600mm high jodhpur stone masonry

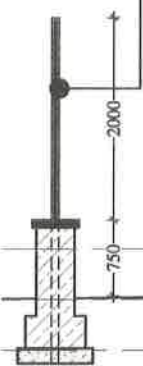

2 mtr High natural stone wall



- LVL.+ 106.0
- LVL.+ 105.5
- LVL.+ 105.0
- LVL.+ 104.5
- LVL.+ 104.0
- LVL.+ 103.5
- LVL.+ 103.0

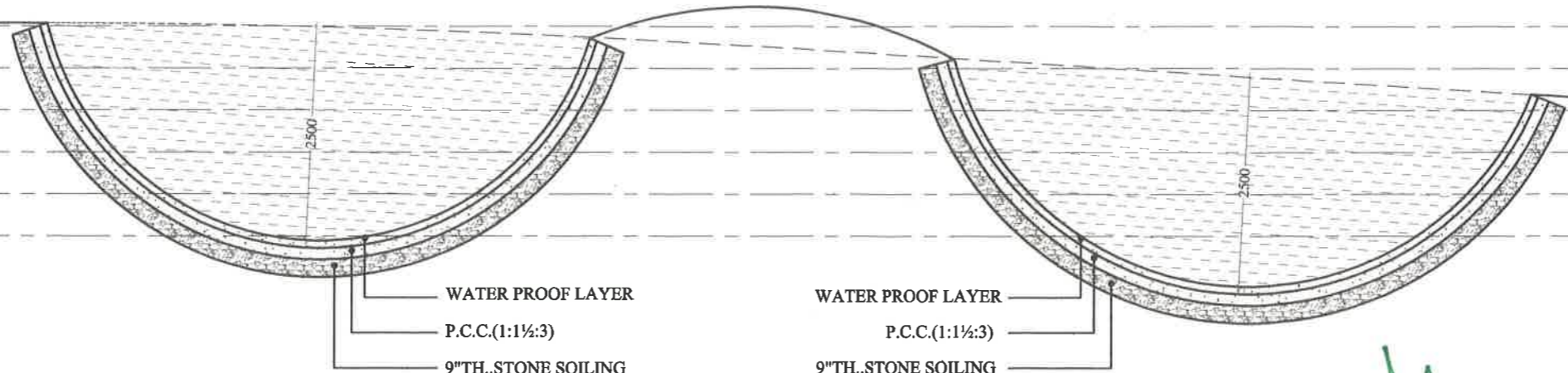

WATER PROOF LAYER
P.C.C.(1:1½:3)
9"TH..STONE SOILING

WATER PROOF LAYER
P.C.C.(1:1½:3)
9"TH..STONE SOILING

SECTION A-A

Chain link Fence 50mm X 50mm X 10g 2 mtr high fixed on 50x50x6mm post on 375mm th. & 600mm high jodhpur stone masonry

[Signature]
Member Secretary
Central Zoo Authority
(Ministry of Environment & Forests)
Govt. of India, New Delhi

[Signature]
Project Director
R. S. R. D. C. Ltd.
JODHPUR

2 mtr High natural stone wall

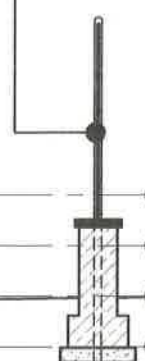
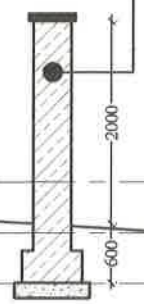

- LVL.+ 105.0
- LVL.+ 104.5
- LVL.+ 104.0
- LVL.+ 103.5
- LVL.+ 103.0
- LVL.+ 102.5
- LVL.+ 102.0
- LVL.+ 101.5
- LVL.+ 101.0

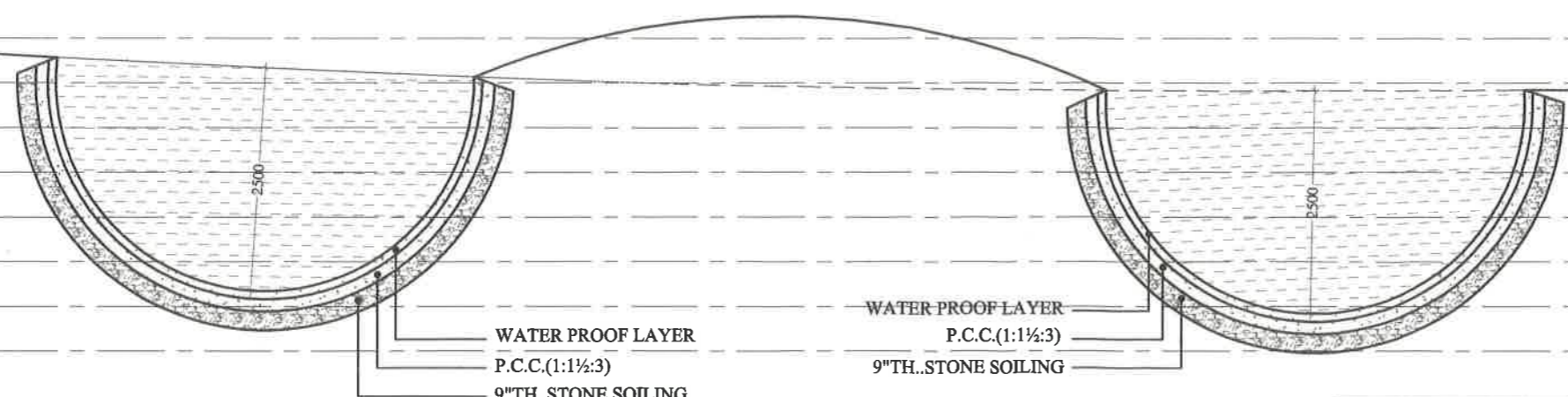

WATER PROOF LAYER
P.C.C.(1:1½:3)
9"TH..STONE SOILING

WATER PROOF LAYER
P.C.C.(1:1½:3)
9"TH..STONE SOILING

SECTION B-B

CROCODILE-GARIYAL ENCLOSURE

| | | | | | | | | | | | |
|--|-----------------|--|-----|----------|---|----|--|-----------------------------|-------------------------|---|--|
| PROJECT PROPOSED SATELLITE MACHIA BIOLOGICAL PARK, JODHPUR | NOTES: | | NO. | DATE | REVISIONS | BY | CH | PROPOSAL SECTION | CROCODILE-GARIYAL | CONSULTANTS | Architecture Conservation Landscape Interiors |
| | CLIENT RSRDC | | 1 | 15-03-10 | Detail drawings submitted | | | Checked by:- Kavita Jain | Made By:- AJAY KUMAR | Kavita Jain | |
| PREPARED BY The 'FORMS', JAIPUR | | | 2 | 11-06-10 | After discussion with DFO and CZAI | | DATE: 06 MARCH 2012 | SCALE: 1:75 | | 4-GA-18, JAWAHAR NAGAR, JAIPUR (RAJ.), INDIA, PHE: +91 141 2621085, 98280 20300 E MAIL:- kavita_design@yahoo.co.in | |
| | | | 3 | 15-11-10 | After CZAI expert committee visit. | | Drawing No. Biopark-Machia-CROCODILE & GHARIYAL-02 | | | | |
| | | | 4 | 25-01-11 | After CZAI expert committee comments. | | | | | | |
| | | | 5 | 07-07-11 | Sizes changed after discussion and comments from PCC, CCF and DFO | | | | | | |
| | | | 6 | 29-07-11 | Sizes changed after discussion and comments from PCC, APCCF and DFO | | | | | | |

128

107

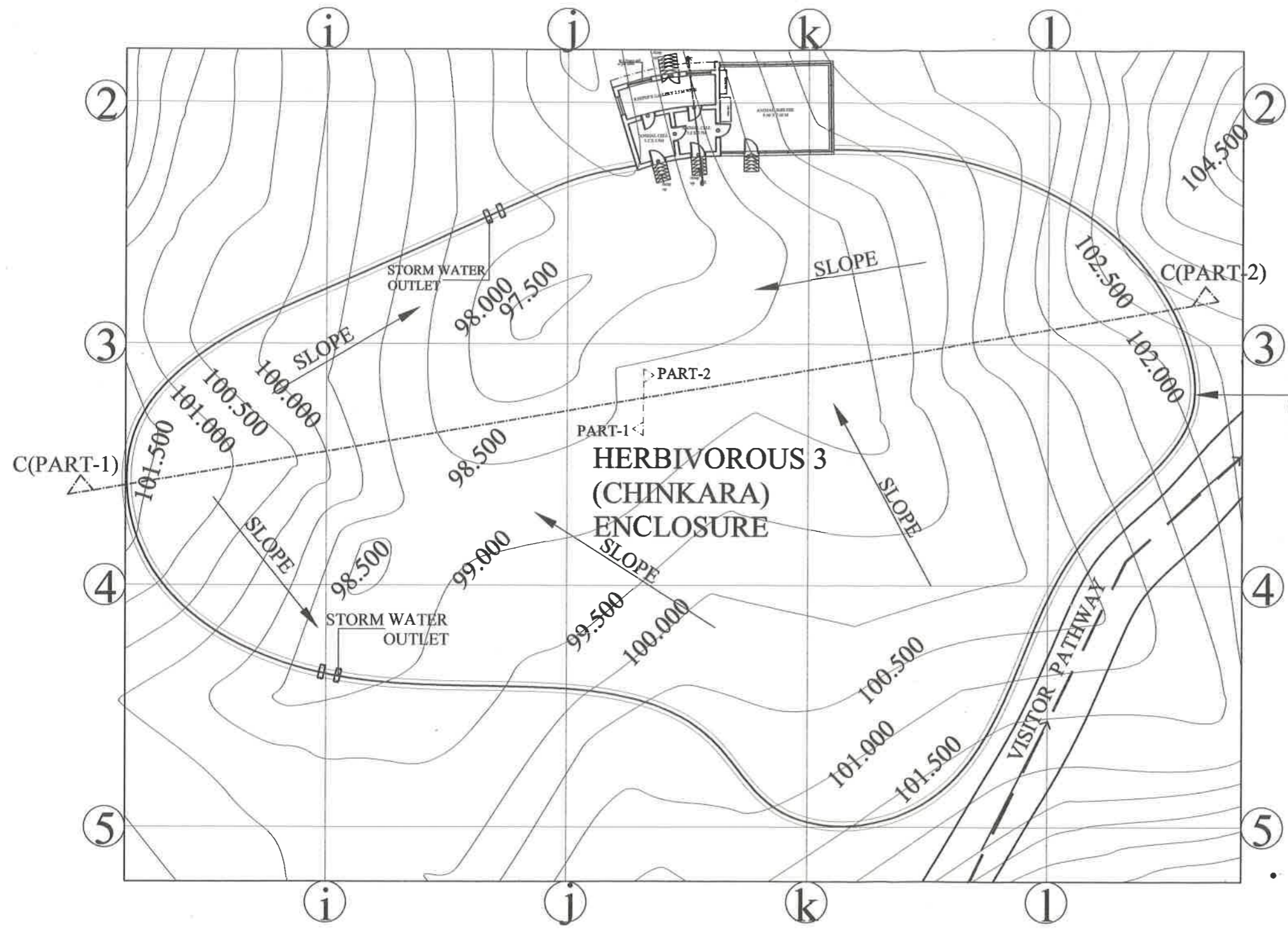

Chain link Fence 75mm x75mmx10 g (2.5 m high) on 375mm th.& 600mm high Jodhpur Stone Masonry wall with

[Signature]
 Member Secretary
 Central Zoo Authority
 (Ministry of Environment & Forests)
 Govt. of India, New Delhi

The 'FORMS'
 Conservation
 4-01A-18, JAWAHAR NAGAR,
 JAIPUR (RAJ), INDIA
 TEL: +91 141 233399, 26280 2030
 E MAIL: kavita_design@zoo.co.in

[Signature]
 Project Director
 R.S. R. D. C. Ltd.
 JODHPUR

Chain link Fence 75mm X 75mm X 10g (2.5 M High) fixed to 75 mm x 75 mm x 6mm angle iron posts.(As per CZA)

PLAN GRID SIZE
20M X 20 M

HERBIVOROUS-3 ENCLOSURE

| PROJECT PROPOSED SATELLITE MACHIA BIOLOGICAL PARK, JODHPUR | NOTES: |  | <table border="1"> <thead> <tr> <th>NO.</th> <th>DATE</th> <th>REVISIONS</th> <th>BY</th> <th>CH</th> </tr> </thead> <tbody> <tr> <td>1</td> <td>15-03-10</td> <td>Detail drawings submitted</td> <td></td> <td></td> </tr> <tr> <td>2</td> <td>11-06-10</td> <td>After discussion with DFO and CZAI</td> <td></td> <td></td> </tr> <tr> <td>3</td> <td>15-11-10</td> <td>After CZAI expert committee visit</td> <td></td> <td></td> </tr> <tr> <td>4</td> <td>25-01-11</td> <td>After CZAI expert committee comments</td> <td></td> <td></td> </tr> <tr> <td>5</td> <td>07-07-11</td> <td>Size changed after discussion and comments from PCC, CCF and DFO</td> <td></td> <td></td> </tr> <tr> <td>6</td> <td>29-07-11</td> <td>Size changed after discussion and comments from PCC, APCCF and DFO</td> <td></td> <td></td> </tr> </tbody> </table> | NO. | DATE | REVISIONS | BY | CH | 1 | 15-03-10 | Detail drawings submitted | | | 2 | 11-06-10 | After discussion with DFO and CZAI | | | 3 | 15-11-10 | After CZAI expert committee visit | | | 4 | 25-01-11 | After CZAI expert committee comments | | | 5 | 07-07-11 | Size changed after discussion and comments from PCC, CCF and DFO | | | 6 | 29-07-11 | Size changed after discussion and comments from PCC, APCCF and DFO | | | <table border="1"> <tr> <td>PROPOSAL PLAN</td> <td>HERBIVOROUS-3 CHINKARA</td> </tr> <tr> <td>Checked by:- Kavita Jain</td> <td>Made By:- AJAY KUMAR</td> </tr> <tr> <td>DATE: 06 MARCH 2012</td> <td>SCALE: 1:400</td> </tr> <tr> <td>Drawing No. :Bipark-Machia-HERBIVOROUS(3) - 01</td> <td></td> </tr> </table> | PROPOSAL PLAN | HERBIVOROUS-3 CHINKARA | Checked by:- Kavita Jain | Made By:- AJAY KUMAR | DATE: 06 MARCH 2012 | SCALE: 1:400 | Drawing No. :Bipark-Machia-HERBIVOROUS(3) - 01 | | <table border="1"> <tr> <td>CONSULTANTS</td> <td>Architecture Conservation Landscape Interiors</td> </tr> <tr> <td>Kavita Jain B.Arch (Hons.), M.Arch (Conservation)</td> <td></td> </tr> <tr> <td>The 'FORMS'</td> <td></td> </tr> <tr> <td>4-01A-18, JAWAHAR NAGAR, JAIPUR (RAJ), INDIA</td> <td></td> </tr> <tr> <td>TEL: +91 141 233399, 26280 2030 E MAIL: kavita_design@zoo.co.in</td> <td></td> </tr> </table> | CONSULTANTS | Architecture Conservation Landscape Interiors | Kavita Jain B.Arch (Hons.), M.Arch (Conservation) | | The 'FORMS' | | 4-01A-18, JAWAHAR NAGAR, JAIPUR (RAJ), INDIA | | TEL: +91 141 233399, 26280 2030 E MAIL: kavita_design@zoo.co.in | |
|--|--|---|--|------|-----------|-----------|----|----|---|----------|---------------------------|--|--|---|----------|------------------------------------|--|--|---|----------|-----------------------------------|--|--|---|----------|--------------------------------------|--|--|---|----------|--|--|--|---|----------|--|--|--|---|---------------|------------------------|-----------------------------|-------------------------|---------------------|--------------|--|--|---|-------------|--|--|--|-------------|--|---|--|--|--|
| | NO. | | | DATE | REVISIONS | BY | CH | | | | | | | | | | | | | | | | | | | | | | | | | | | | | | | | | | | | | | | | | | | | | | | | | | | |
| 1 | 15-03-10 | Detail drawings submitted | | | | | | | | | | | | | | | | | | | | | | | | | | | | | | | | | | | | | | | | | | | | | | | | | | | | | | | | |
| 2 | 11-06-10 | After discussion with DFO and CZAI | | | | | | | | | | | | | | | | | | | | | | | | | | | | | | | | | | | | | | | | | | | | | | | | | | | | | | | | |
| 3 | 15-11-10 | After CZAI expert committee visit | | | | | | | | | | | | | | | | | | | | | | | | | | | | | | | | | | | | | | | | | | | | | | | | | | | | | | | | |
| 4 | 25-01-11 | After CZAI expert committee comments | | | | | | | | | | | | | | | | | | | | | | | | | | | | | | | | | | | | | | | | | | | | | | | | | | | | | | | | |
| 5 | 07-07-11 | Size changed after discussion and comments from PCC, CCF and DFO | | | | | | | | | | | | | | | | | | | | | | | | | | | | | | | | | | | | | | | | | | | | | | | | | | | | | | | | |
| 6 | 29-07-11 | Size changed after discussion and comments from PCC, APCCF and DFO | | | | | | | | | | | | | | | | | | | | | | | | | | | | | | | | | | | | | | | | | | | | | | | | | | | | | | | | |
| PROPOSAL PLAN | HERBIVOROUS-3 CHINKARA | | | | | | | | | | | | | | | | | | | | | | | | | | | | | | | | | | | | | | | | | | | | | | | | | | | | | | | | | |
| Checked by:- Kavita Jain | Made By:- AJAY KUMAR | | | | | | | | | | | | | | | | | | | | | | | | | | | | | | | | | | | | | | | | | | | | | | | | | | | | | | | | | |
| DATE: 06 MARCH 2012 | SCALE: 1:400 | | | | | | | | | | | | | | | | | | | | | | | | | | | | | | | | | | | | | | | | | | | | | | | | | | | | | | | | | |
| Drawing No. :Bipark-Machia-HERBIVOROUS(3) - 01 | | | | | | | | | | | | | | | | | | | | | | | | | | | | | | | | | | | | | | | | | | | | | | | | | | | | | | | | | | |
| CONSULTANTS | Architecture Conservation Landscape Interiors | | | | | | | | | | | | | | | | | | | | | | | | | | | | | | | | | | | | | | | | | | | | | | | | | | | | | | | | | |
| Kavita Jain B.Arch (Hons.), M.Arch (Conservation) | | | | | | | | | | | | | | | | | | | | | | | | | | | | | | | | | | | | | | | | | | | | | | | | | | | | | | | | | | |
| The 'FORMS' | | | | | | | | | | | | | | | | | | | | | | | | | | | | | | | | | | | | | | | | | | | | | | | | | | | | | | | | | | |
| 4-01A-18, JAWAHAR NAGAR, JAIPUR (RAJ), INDIA | | | | | | | | | | | | | | | | | | | | | | | | | | | | | | | | | | | | | | | | | | | | | | | | | | | | | | | | | | |
| TEL: +91 141 233399, 26280 2030 E MAIL: kavita_design@zoo.co.in | | | | | | | | | | | | | | | | | | | | | | | | | | | | | | | | | | | | | | | | | | | | | | | | | | | | | | | | | | |
| CLIENT RSRDC | PREPARED BY The 'FORMS', JAIPUR | | | | | | | | | | | | | | | | | | | | | | | | | | | | | | | | | | | | | | | | | | | | | | | | | | | | | | | | | |

128



HERBIVOROUS-1
SECTION A-A



HERBIVOROUS-2
SECTION B-B

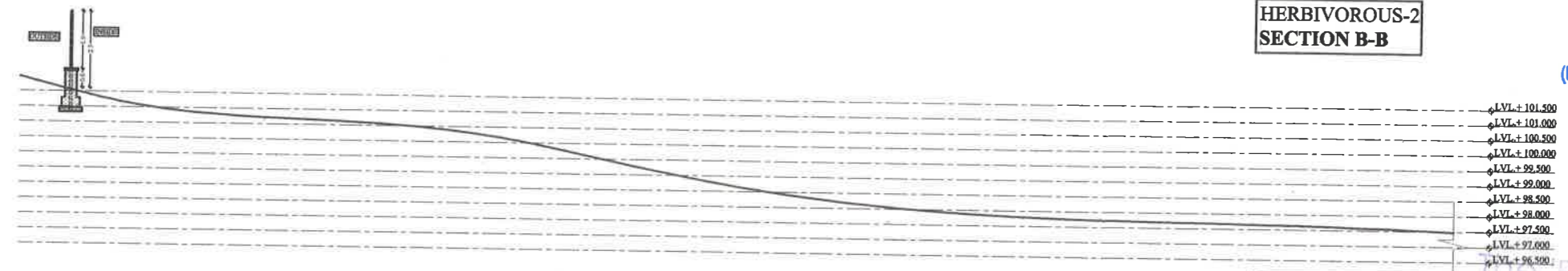

HERBIVOROUS-3
SECTION C-C(PART-1)

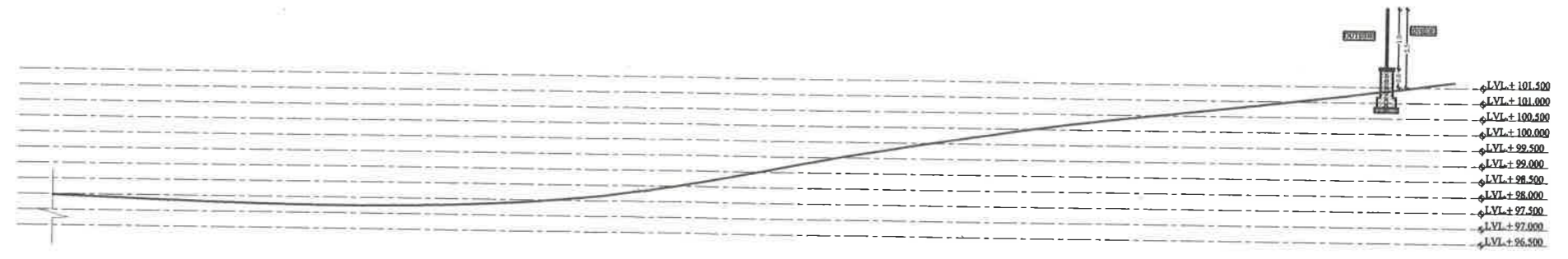

HERBIVOROUS-3
SECTION C-C(PART-2)

HERBIVOROUS-2 ENCLOSURE

Kavita Jain

Member Secretary
Central Zoo Authority
(Ministry of Environment & Forests)
Govt. of India, New Delhi

M R M S'
conservation

e mail: kavita_design@yahoo.co.in

Kavita Jain
Project Director
H. S. R. D. C. Ltd.
JODHPUR

Kavita Jain
Project Director
H. S. R. D. C. Ltd.
JODHPUR

| PROJECT PROPOSED SATELLITE MACHIA BIOLOGICAL PARK, JODHPUR | NOTES: | | <table border="1"> <thead> <tr> <th>NO.</th> <th>DATE</th> <th>REVISIONS</th> <th>BY</th> <th>CH</th> </tr> </thead> <tbody> <tr> <td>1</td> <td>15-03-10</td> <td>Detail drawings submitted.</td> <td></td> <td></td> </tr> <tr> <td>2</td> <td>11-06-10</td> <td>After discussion with DFO and CZAI</td> <td></td> <td></td> </tr> <tr> <td>3</td> <td>15-11-10</td> <td>After CZAI expert committee visit.</td> <td></td> <td></td> </tr> <tr> <td>4</td> <td>25-01-11</td> <td>After CZAI expert committee comments.</td> <td></td> <td></td> </tr> <tr> <td>5</td> <td>07-07-11</td> <td>Sizes changed after discussion and comments from PCC, CCF and DFO.</td> <td></td> <td></td> </tr> <tr> <td>6</td> <td>29-07-11</td> <td>Sizes changed after discussion and comments from PCC, APCCF and DFO.</td> <td></td> <td></td> </tr> </tbody> </table> | NO. | DATE | REVISIONS | BY | CH | 1 | 15-03-10 | Detail drawings submitted. | | | 2 | 11-06-10 | After discussion with DFO and CZAI | | | 3 | 15-11-10 | After CZAI expert committee visit. | | | 4 | 25-01-11 | After CZAI expert committee comments. | | | 5 | 07-07-11 | Sizes changed after discussion and comments from PCC, CCF and DFO. | | | 6 | 29-07-11 | Sizes changed after discussion and comments from PCC, APCCF and DFO. | | | <table border="1"> <thead> <tr> <th>PROPOSAL SECTION</th> <th>HERBIVOROUS</th> <th>CONSULTANTS</th> </tr> </thead> <tbody> <tr> <td>Checked by:- Kavita Jain</td> <td>Made By:- AJAY KUMAR</td> <td>Kavita Jain B Arch.(Hons.), M Arch.(Conservation) The 'FORMS' 4-0A-18, JAWAHAR NAGAR, JODHPUR (RAJ), INDIA. PH: +91 141 2621083, 98280 20200 E MAIL: kavita_design@yahoo.co.in</td> </tr> </tbody> </table> | PROPOSAL SECTION | HERBIVOROUS | CONSULTANTS | Checked by:- Kavita Jain | Made By:- AJAY KUMAR | Kavita Jain B Arch.(Hons.), M Arch.(Conservation) The 'FORMS' 4-0A-18, JAWAHAR NAGAR, JODHPUR (RAJ), INDIA. PH: +91 141 2621083, 98280 20200 E MAIL: kavita_design@yahoo.co.in | <table border="1"> <thead> <tr> <th>Architecture Conservation Landscape Interiors</th> </tr> </thead> <tbody> <tr> <td> </td> </tr> </tbody> </table> | Architecture Conservation Landscape Interiors | |
|--|------------------------------------|--|---|---|-----------|-----------|----|----|---|----------|----------------------------|--|--|---|----------|------------------------------------|--|--|---|----------|------------------------------------|--|--|---|----------|---------------------------------------|--|--|---|----------|--|--|--|---|----------|--|--|--|---|------------------|-------------|-------------|-----------------------------|-------------------------|--|---|---|--|
| | NO. | | | DATE | REVISIONS | BY | CH | | | | | | | | | | | | | | | | | | | | | | | | | | | | | | | | | | | | | | | | | |
| 1 | 15-03-10 | Detail drawings submitted. | | | | | | | | | | | | | | | | | | | | | | | | | | | | | | | | | | | | | | | | | | | | | | |
| 2 | 11-06-10 | After discussion with DFO and CZAI | | | | | | | | | | | | | | | | | | | | | | | | | | | | | | | | | | | | | | | | | | | | | | |
| 3 | 15-11-10 | After CZAI expert committee visit. | | | | | | | | | | | | | | | | | | | | | | | | | | | | | | | | | | | | | | | | | | | | | | |
| 4 | 25-01-11 | After CZAI expert committee comments. | | | | | | | | | | | | | | | | | | | | | | | | | | | | | | | | | | | | | | | | | | | | | | |
| 5 | 07-07-11 | Sizes changed after discussion and comments from PCC, CCF and DFO. | | | | | | | | | | | | | | | | | | | | | | | | | | | | | | | | | | | | | | | | | | | | | | |
| 6 | 29-07-11 | Sizes changed after discussion and comments from PCC, APCCF and DFO. | | | | | | | | | | | | | | | | | | | | | | | | | | | | | | | | | | | | | | | | | | | | | | |
| PROPOSAL SECTION | HERBIVOROUS | CONSULTANTS | | | | | | | | | | | | | | | | | | | | | | | | | | | | | | | | | | | | | | | | | | | | | | |
| Checked by:- Kavita Jain | Made By:- AJAY KUMAR | Kavita Jain B Arch.(Hons.), M Arch.(Conservation) The 'FORMS' 4-0A-18, JAWAHAR NAGAR, JODHPUR (RAJ), INDIA. PH: +91 141 2621083, 98280 20200 E MAIL: kavita_design@yahoo.co.in | | | | | | | | | | | | | | | | | | | | | | | | | | | | | | | | | | | | | | | | | | | | | | |
| Architecture Conservation Landscape Interiors | | | | | | | | | | | | | | | | | | | | | | | | | | | | | | | | | | | | | | | | | | | | | | | | |
| | | | | | | | | | | | | | | | | | | | | | | | | | | | | | | | | | | | | | | | | | | | | | | | | |
| CLIENT RSRDC | PREPARED BY The 'FORMS', JAIPUR | DATE: 06 MARCH 2012 | SCALE: 1:200 | Drawing No. Biopark-Machia-HERBIVOROUS - 01 | | | | | | | | | | | | | | | | | | | | | | | | | | | | | | | | | | | | | | | | | | | | |

128

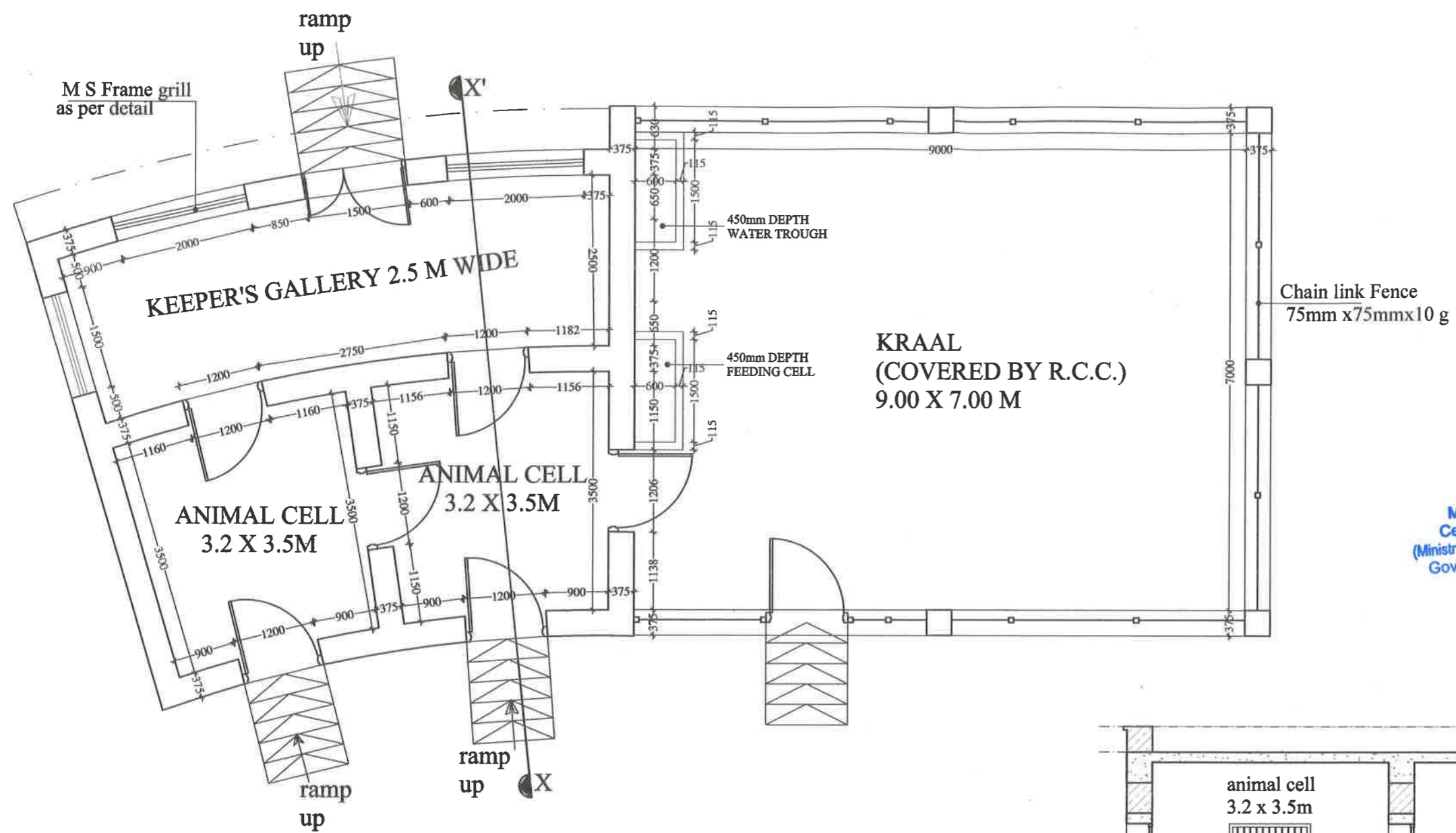

Member Secretary
Central Zoo Authority
(Ministry of Environment & Forests)
Govt. of India, New Delhi

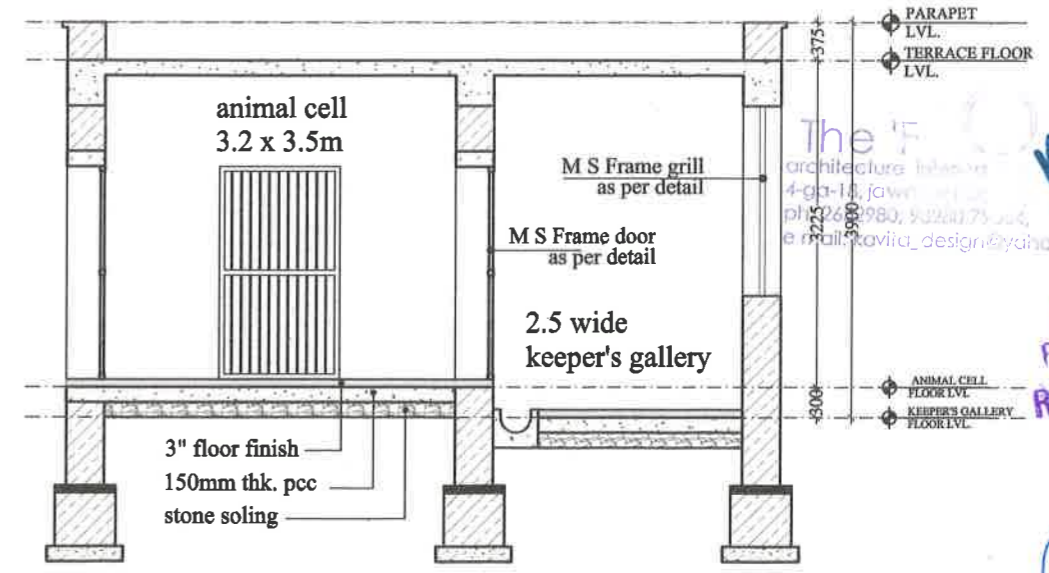

SECTION A-A

ANIMAL NIGHT SHELTER PLAN

HERBIVOROUS-2 ENCLOSURE

PROJECT
PROPOSED SATELLITE MACHIA
BIOLOGICAL PARK, JODHPUR

NOTES:
CLIENT
RSRDC
PREPARED BY
The 'FORMS', JAIPUR



| NO. | DATE | REVISIONS | BY | CHK. |
|-----|----------|--|----|------|
| 1 | 15-03-10 | Detail drawings submitted. | | |
| 2 | 11-06-10 | After discussion with DFO and CZAI | | |
| 3 | 15-11-10 | After CZAI expert committee visit. | | |
| 4 | 25-01-11 | After CZAI expert committee comments. | | |
| 5 | 07-07-11 | Sizes changed after discussion and comments from PCC, CCF and DFO. | | |
| 6 | 29-07-11 | Sizes changed after discussion and comments from PCC, APCCF and DFO. | | |

ANIMAL NIGHT SHELTER
PLAN & SECTION
Checked by:-
Kavita Jain
DATE: 06 MARCH 2012
Drawing No. Biopark-Machia-HERBIVOROUS - 02

HERBIVOROUS
Made By:-
AJAY KUMAR
SCALE: 1:75

CONSULTANTS
Kavita Jain
B.Arch.(Hons.), M.Arch.(Conservation)
The 'FORMS'
4-GA-18, JAWAHAR NAGAR,
JAIPUR, (RAJ), INDIA.
PHE: +91 141 2621085, 94280 20300
E MAIL: kavita_design@yahoo.co.in

Architecture
Conservation
Landscape
Interiors

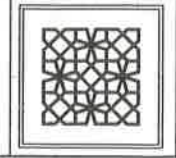

Project Director
R. S. R. D. C. Ltd.
JODHPUR