



जहाँ है हरियाली।
वहाँ है खुशहाली।।



GOVERNMENT OF INDIA
MINISTRY OF ENVIRONMENT & FORESTS
Central Zoo Authority



F. No. 19-20/92--CZA(325)(Vol. VII)(M) / 121

DATE: 24.06.2011

27

To

The Director
Padmaja Naidu Himalayan Zoological Park,
Darjeeling (West Bengal).

Sub:- Construction of seven unit of Pheasant enclosure at satellite facility, Dow Hill, Kurseong under Padmaja Naidu Himalayan Zoological Park, Darjeeling.

Ref:- (i) Your office letter No. 1044/PA-3/BUDGET/PNHZP/10-11 dated 14.03.2011.
(ii) Your office letter No. 1079/PA-3/BUDGET/PNHZP/10-11 dated 25.03.2011.

Sir,

Reference is invited to the above cited correspondence.

The said proposal was placed before the Technical Committee in its 58th Meeting of Central Zoo Authority held on 8th July, 2011.

The committee deliberated on the proposal and deferred consideration of the same to the next meeting of the committee. The committee recommended two members (Shri P. C. Tyagi and Dr. Vibhu Prakash) of the Technical Committee to visit the site and evaluate the proposal with reference to the requirement of the species, adequacy of the number of founders, etc. and also assist the zoo in revising the proposal, if required. The team will submit its recommendations to CZA, so that the same could be placed in the next meeting of the Technical Committee.

Therefore, you are requested to facilitate visit of Sh. P. C. Tyagi and Dr. Vibhu Prakash for the said purpose and provide all necessary information and logistic support.

Yours faithfully,

(B. S. Bonal)

Member Secretary

Copy for favour of information to:-

1. PS to Addl. DGF (WL), MoEF, New Delhi.
2. Sh. P. C. Tyagi, Senior Scientist, Wildlife Institute of India, Dehradun with the request to conduct the said evaluation and submit report at the earliest so as to enable placement of same before the next meeting. **Necessary details regarding the proposal is enclosed herewith for more information.**
3. Dr. Vibhu Prakash, Vulture Conservation Breeding Centre, Pinjore with the request to conduct the said evaluation and submit report at the earliest so as to enable placement of same before the next meeting. **Necessary details regarding the proposal is enclosed herewith for more information.**

Bikaner House, Annexe VI, Shahjahan Road, New Delhi-110011

Phone : 011-23381585, 23073072, 23070375 (EPABX), Fax : +91-11-23386012

E-mail : cza@nic.in Website : http://www.cza.nic.in

27/6/11

CONSTRUCTION OF PROPOSED SEVEN UNIT COMPOSITE PHEASANTRY AT SATELLITE ZOO DOV HILL, OVER AN AREA OF 1600 Sq.M.

REFERENCES:-

1. HOUSE : HALF BRICK WORK HALF CHAINLINK FENCE
2. ENCLOSURE : M.S. ANGLE FRAME WITH CHAINLINK FENCE (0.50 X 0.50 3/2")
3. RAILING : R.C.C. (1:1:4) POST WITH 40MM G.I PIPE @ 1.50M
4. VISITOR PATH : 1.20M WIDE IN P.C.C (1:2:4)
5. DRAIN : 0.20M WIDE IN P.C.C (1:2:4) TOTAL LENGTH = 180M
6. FENCING : 25MM X 25MM G.I NET (CHAINLINK)
7. GATE : M.S. ANGLE FRAME WITH CHAINLINK (100X200MM GATE)
8. PROTECTION WALL : PLUM CONC. (1:3:6) TOTAL LENGTH = 130M
9. HOUSE ROOF : M.S. ANGLE FRAME WITH FIBER SHEET
10. M.S. ANGLE : FIXING WITH C.C (1:2:4) HT. 1.10M @ 200MM
11. BASE : STONE SOLING WITH C.C (1:3:6) 0.15M TH.
12. HOUSE 1 & 5 : 8M X 20M SIZE EACH. (SIZE OF HOUSE 1.50X1.50)
13. Pheasant to be housed:
 - Siberian Pheasant (2:4), Tawny-crowned Pheasant (2:4), Kalij Pheasant (2:4)
 - Red jungle fowl (2:4), Blood Pheasant (2:4), Monal pheasant (7:9)
 - as per availability.
 - 1-2 - kept reserve for chick rearing

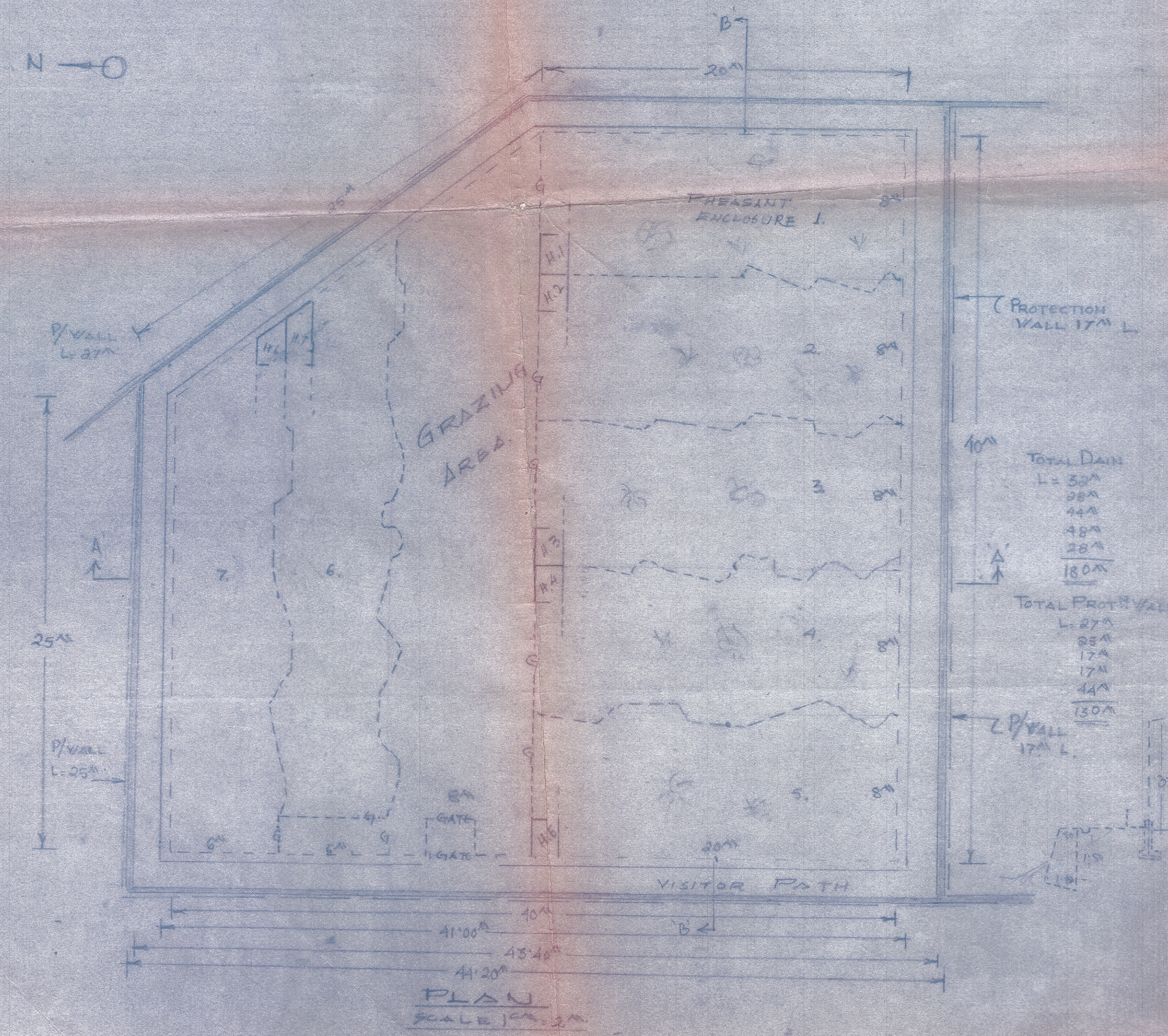
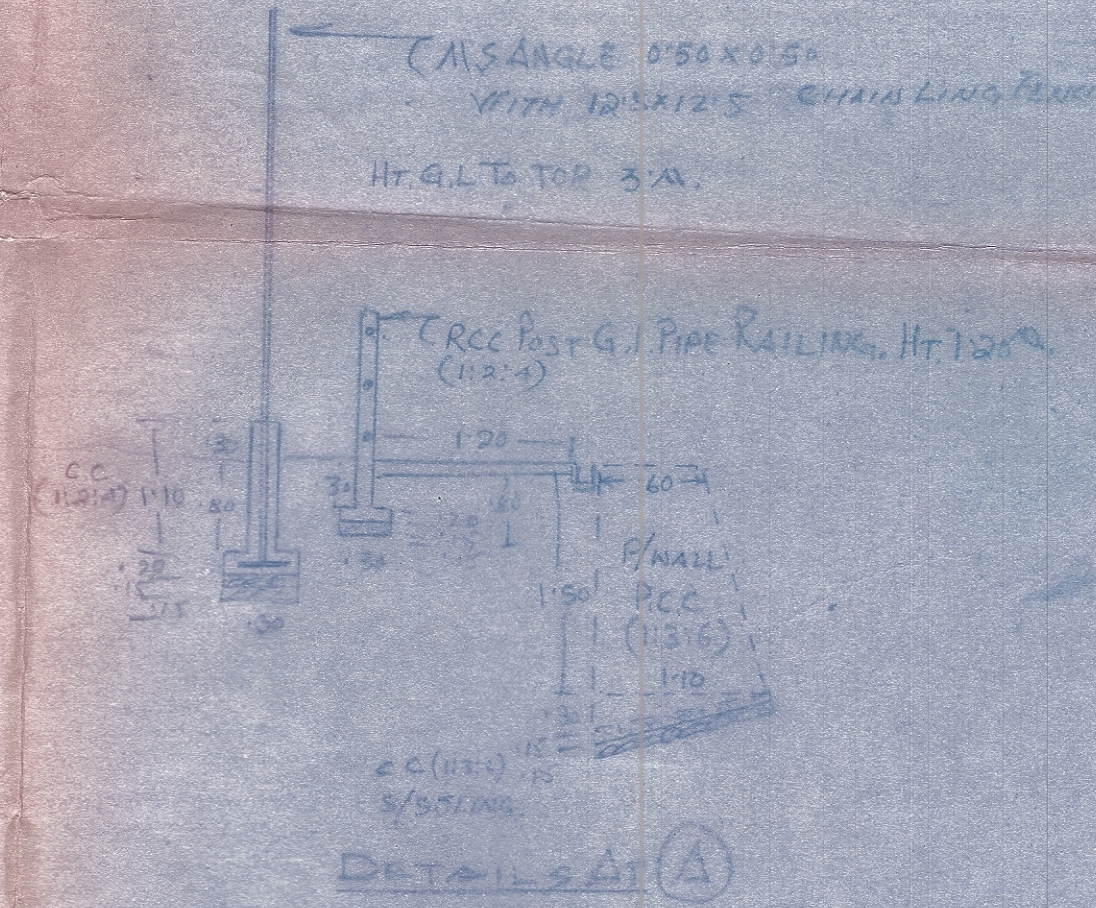
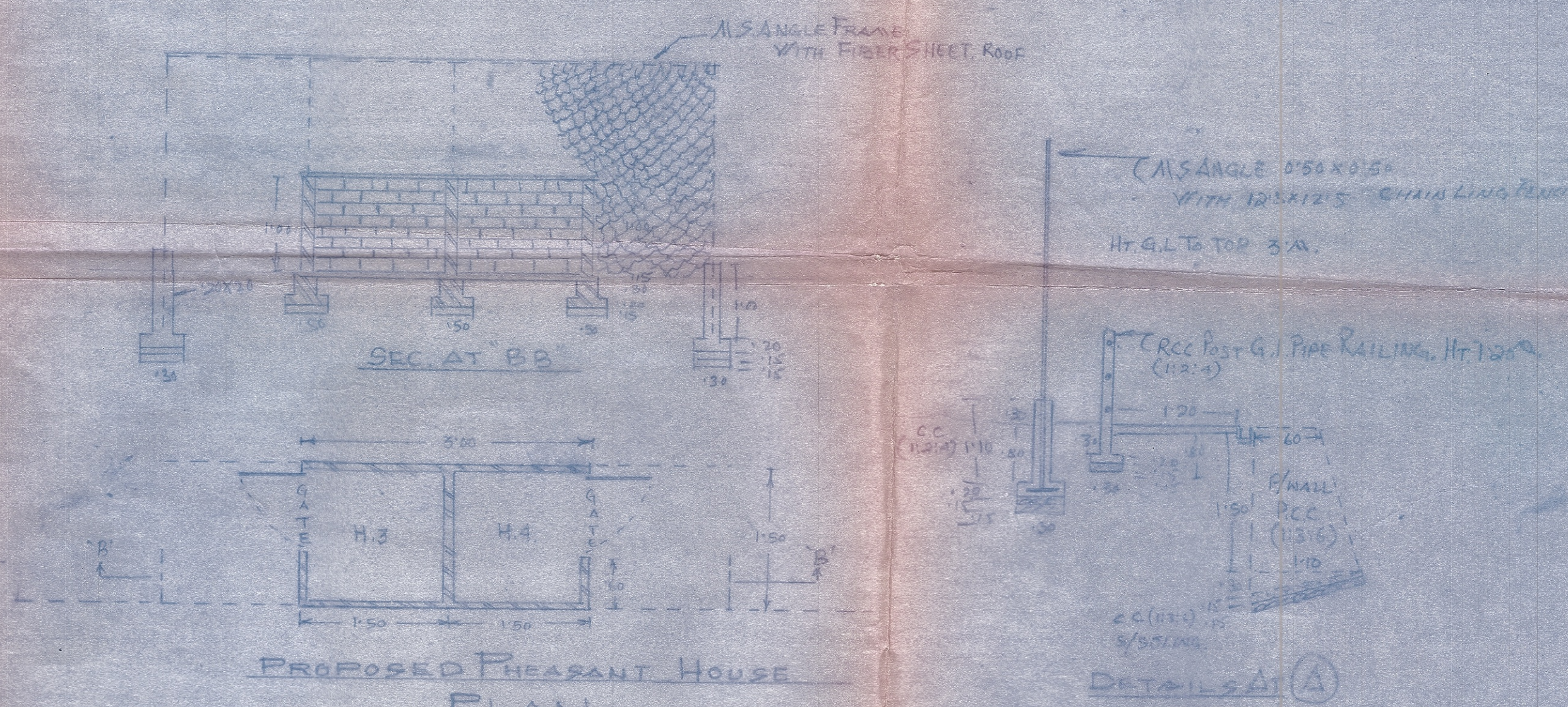
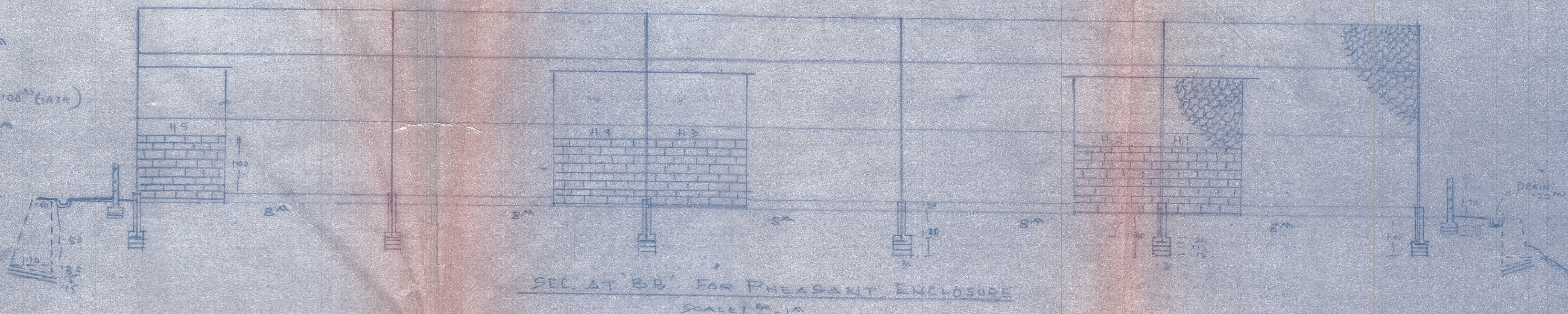

TOTAL DRAIN
L = 32M
44M
48M
38M
180M

TOTAL PROT. WALL
L = 27M
25M
17M
17M
44M
130M

SEC. AT AA
SCALE 1/4" = 1M

Submitted by:
[Signature]
Beat Officer
Satellite Zoo, Dowhill
P. N. H. Z. Park

Checked by:
[Signature]
Dy. Director
Satellite Zoo, Dowhill
P. N. H. Z. Park, Darjeeling

Approved by:
[Signature]
DIRECTOR
PNHZ Park, Darjeeling