

# BEAR SAFARI

Double door Entry & Exit gate cum Guard Room

Double door Emergency gate cum Guard Room

Green belt 10m wide

Chain link Mesh 50x50mm size of 5m Height with 1.3m overhanging plate at both sides of safari

Animal holding house & Kraal (Details attached)

# LION SAFARI

Green belt 10m wide

Artificial Hillock

# LEOPARD SAFARI Area:20.9Ha

Safari Road 3.75m wide Total Length=1.8Km

Outer Service Road of 5m wide

Chain link Mesh 50x50mm size of 5m Height with 1.3m overhanging plate

Green belt 10m wide

*req kindly to approved*  
*[Signature]*  
*9-12*

Water body

Animal holding house & Kraal (Details attached)

Green belt 10m wide

# TIGER SAFARI

*Approved as revised.*  
*[Signature]*

REVISE & RESUBMITTED

*[Signature]*  
*9/12/14*

*09/12/14*  
*[Signature]*  
Member Secretary  
Central Zoo Authority  
Ministry of Environment, Forests & Climate Change  
Govt. of India, New Delhi-110001

*[Signature]*  
Executive Director  
Bannerghatta Biological Park  
Bannerghatta, Bengaluru

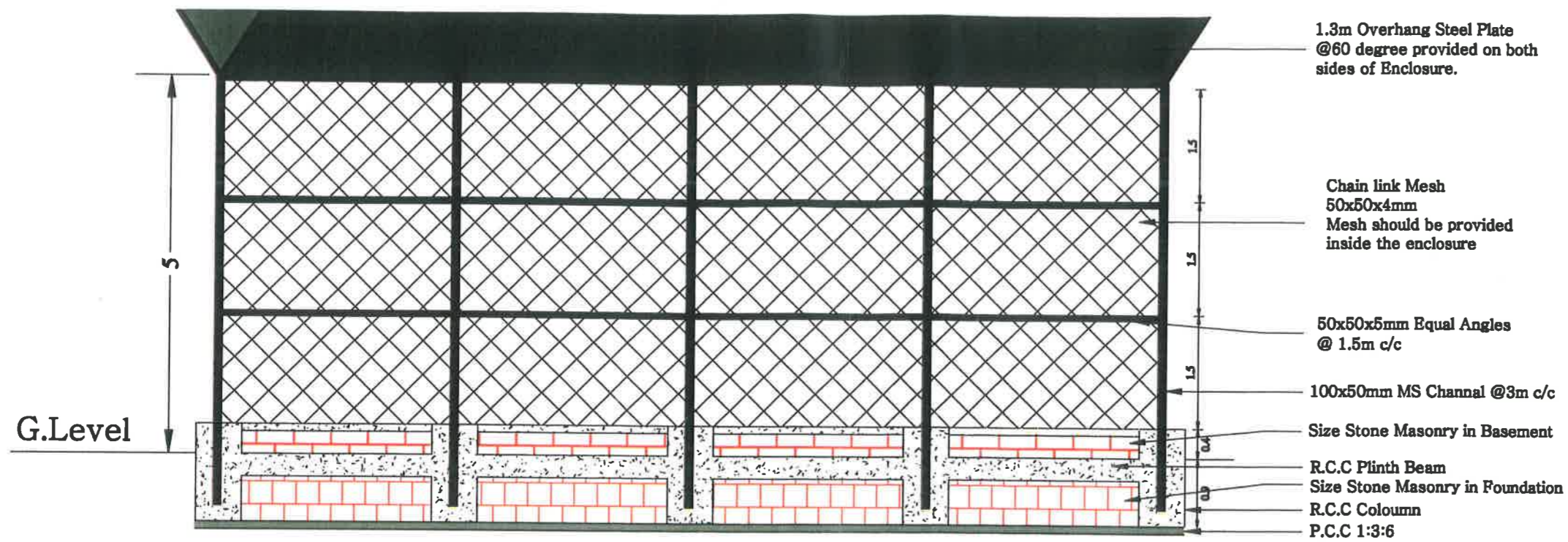

FENCING ELEVATION

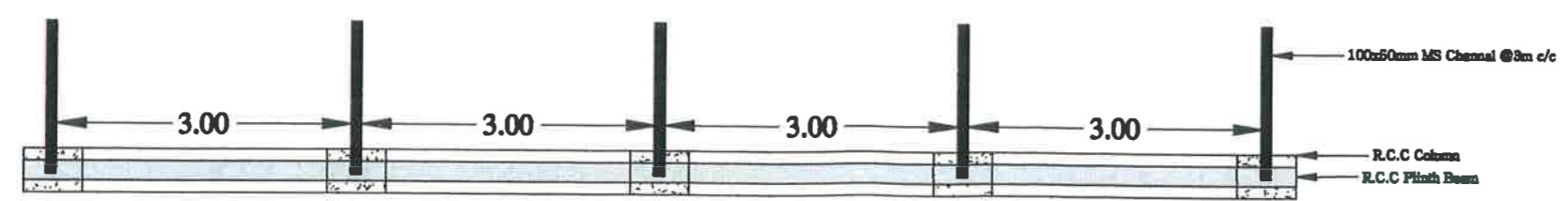

PLAN

REVISED & RESUBMITTED  
*[Signature]*  
9/12/14

Executive Director  
Bannerghatta Biological Park  
Bannerghatta, Bengaluru



84

# DOUBLE GATE ARRANGEMENT

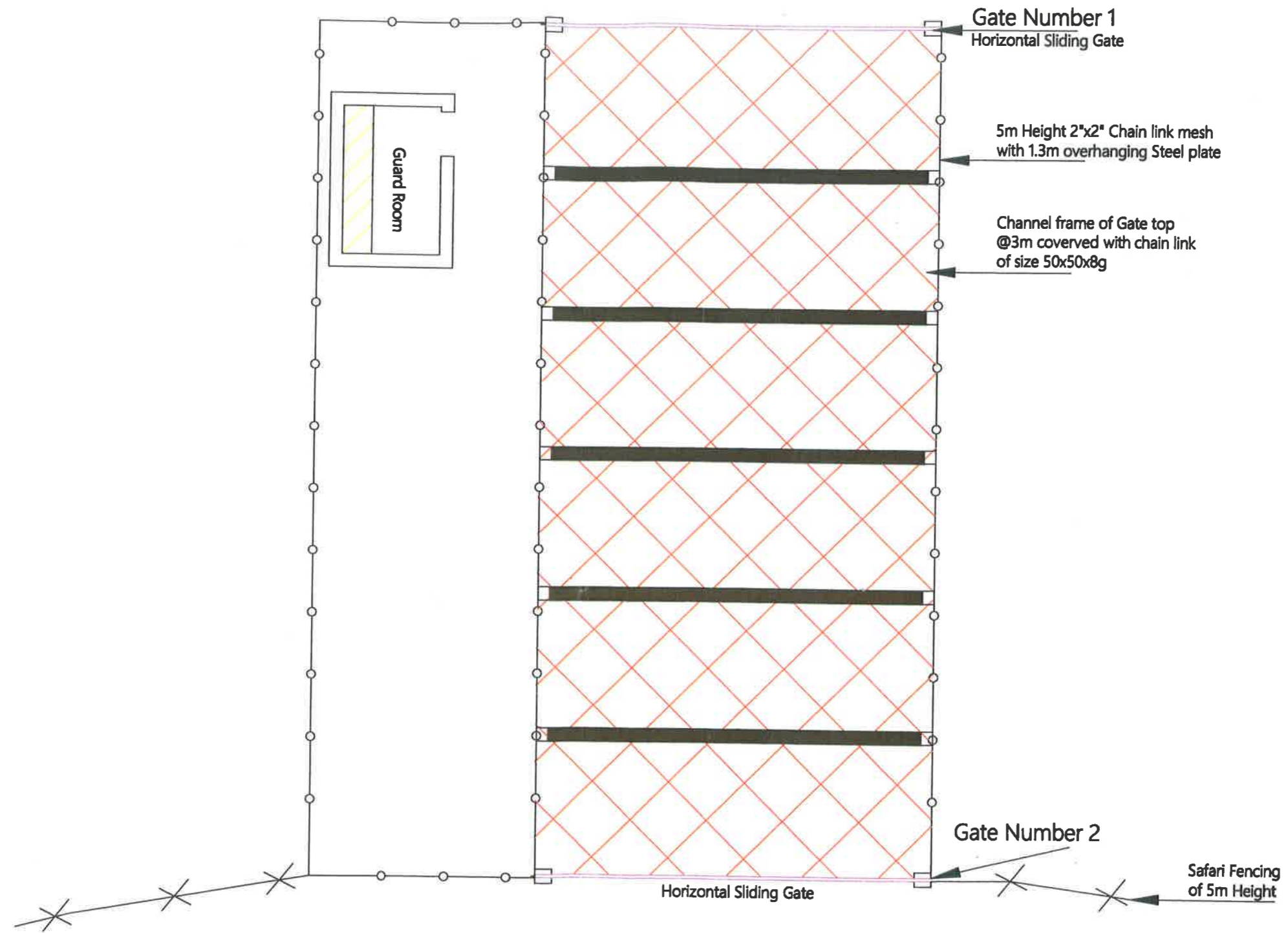

LEOPARD SAFARI

REVISED & RESUBMITTED

*[Signature]*  
Executive Director  
Bannerghatta Biological Park  
Bannerghatta, Bengaluru

84

# TYPICAL PLAN OF LEOPARD ANIMAL HOLDING HOUSE

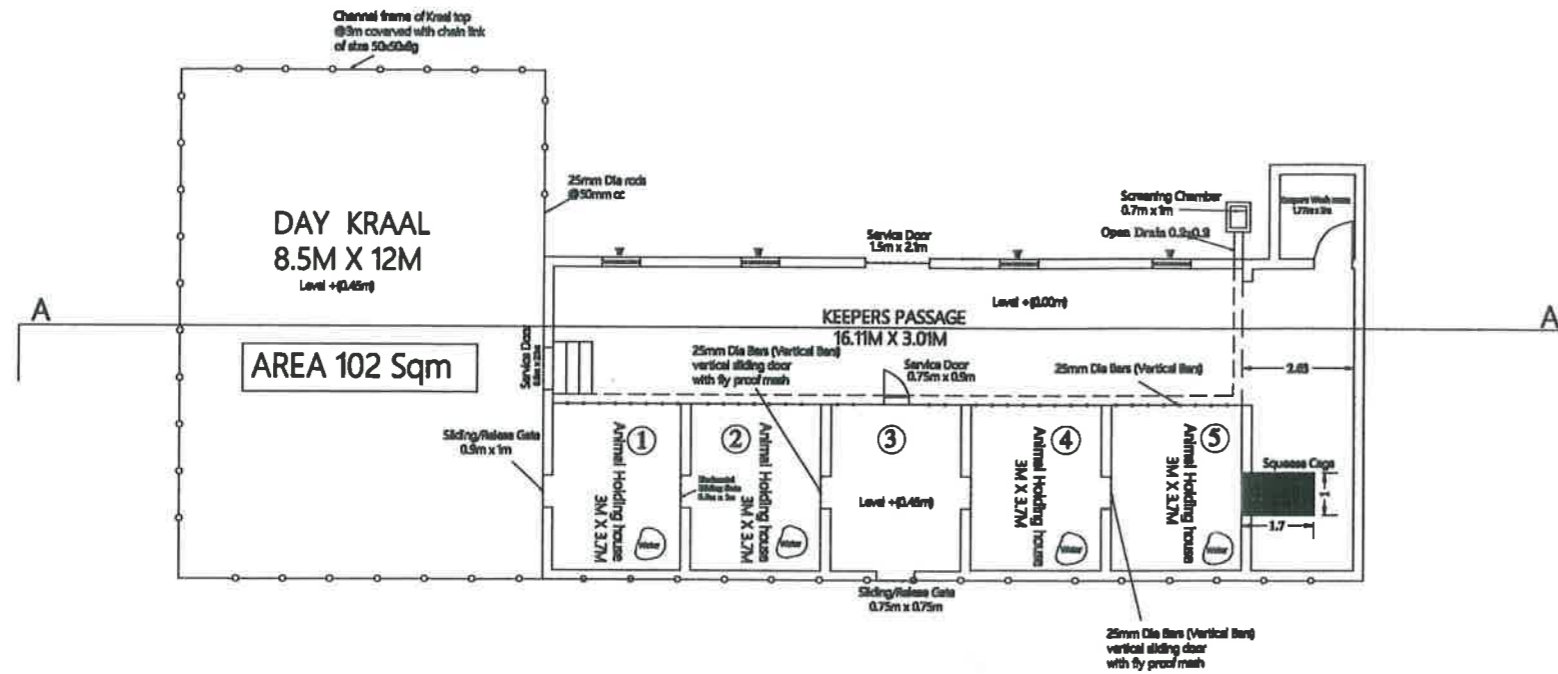

Details of Opening

Sl No.	Location	Opening Size	Shutter
1.	Service Door	1.5m x 2.1m	25mm Dia Bars (Vertical Bars) Slide hung
2.	Keepers gallery to cell	0.75m x 0.9m	25mm Dia Bars (Vertical Bars) vertical sliding door with fly proof mesh
3.	Cell to Cell	0.75m x 0.9m	25mm Dia Bars (Vertical Bars) vertical sliding door with fly proof mesh
4.	Cell to Area	1m x 1.8m	25mm Dia Bars (Vertical Bars) vertical sliding door with fly proof mesh
5.	Ventilators	0.75m x 0.9m	Wooden frame with 16mm Dia Bars
6.	Windows at Keepers passage	0.9m x 1.8m	Wooden frame and shutter with 16mm Dia Bars
7.	Cell to Day Kraal	0.9m x 1.8m	25mm Dia Bars (Vertical Bars) vertical sliding door with fly proof mesh
8.	Keepers Passage to Wash room	0.9m x 2.1m	Wooden frame and shutter

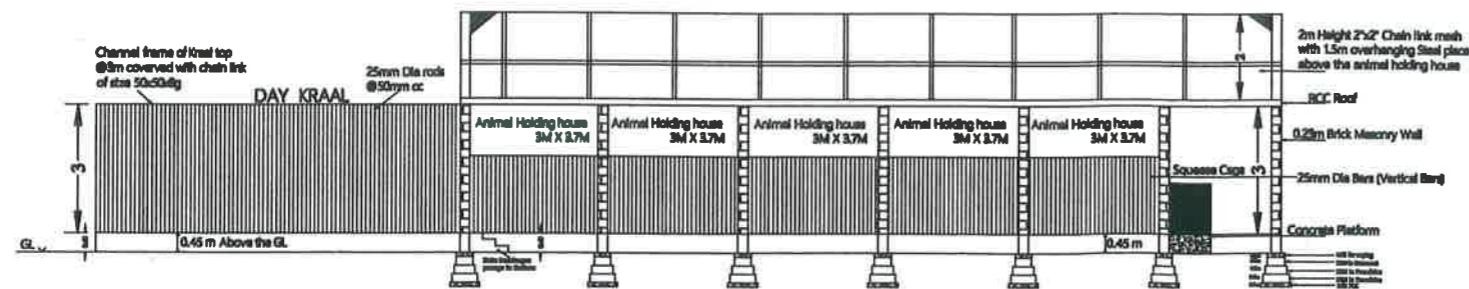

SECTION AT A-A

*Handwritten signature*

REVISED & RESUBMITTED

*Handwritten signature*  
9/12/14

Executive Director  
Bannerghatta Biological Park  
Bannerghatta, Bengaluru