

TYPICAL PLAN OF HYENA ENCLOSURE

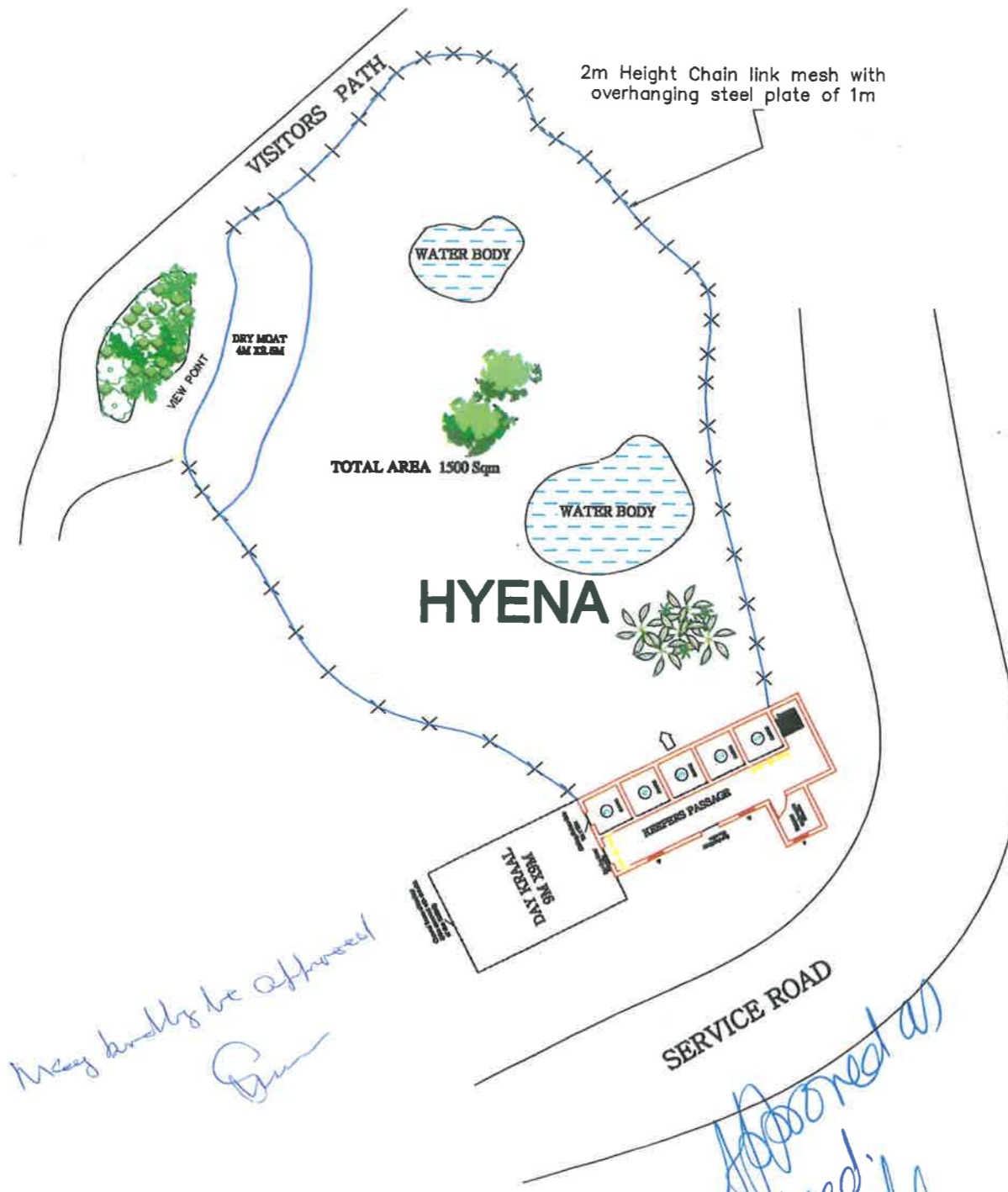

*May kindly be approved
Bun*

*Approved as
revised*

REVISED & RESUBMITTED
[Signature]

B. S. BONAL, IFS
Member Secretary
Central Zoo Authority
Ministry of Environment, Forests & Climate Change
India, New Delhi-110001

Executive Director
Bannerghatta Biological Park
Bannerghatta, Bengaluru

*09/12/14
(52 W.C.42D)*

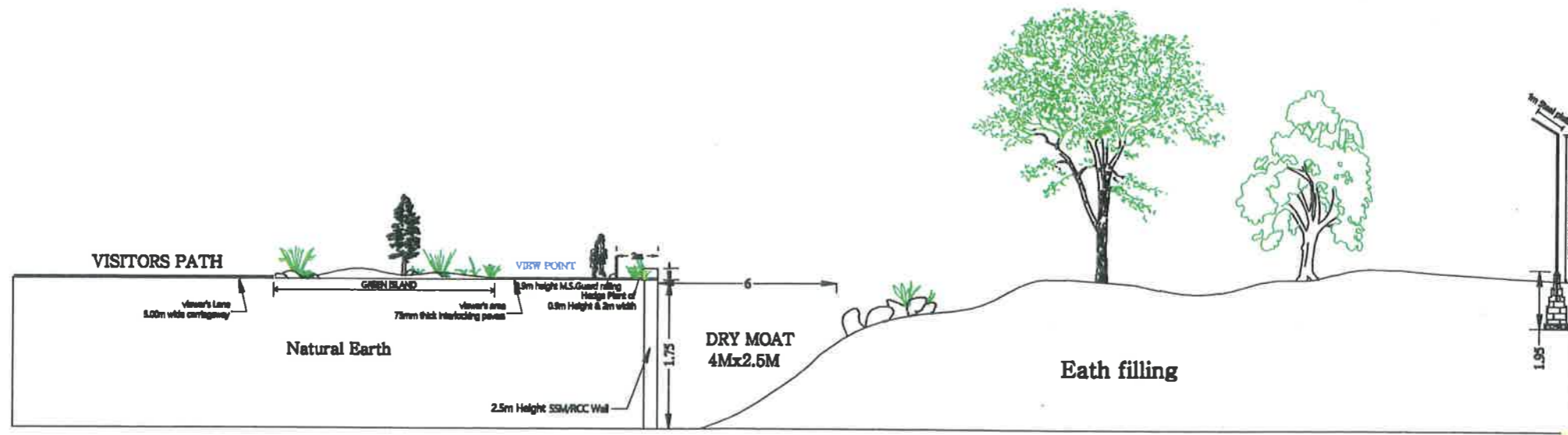

CROSS SECTION OF HYENA ENCLOSURE

REVISED & RESUBMITTED

may kindly be approved

[Signature]
9/12/14

**Executive Director
Bannerghatta Biological Park
Bannerghatta, Bengaluru**

[Signature]
9/12/14
B. S. BONAL, IFS
Member Secretary
Central Zoo Authority
Ministry of Environment, Forests & Climate Change
Government of India, New Delhi-110001

82

HYENA ANIMAL HOLDING HOUSE

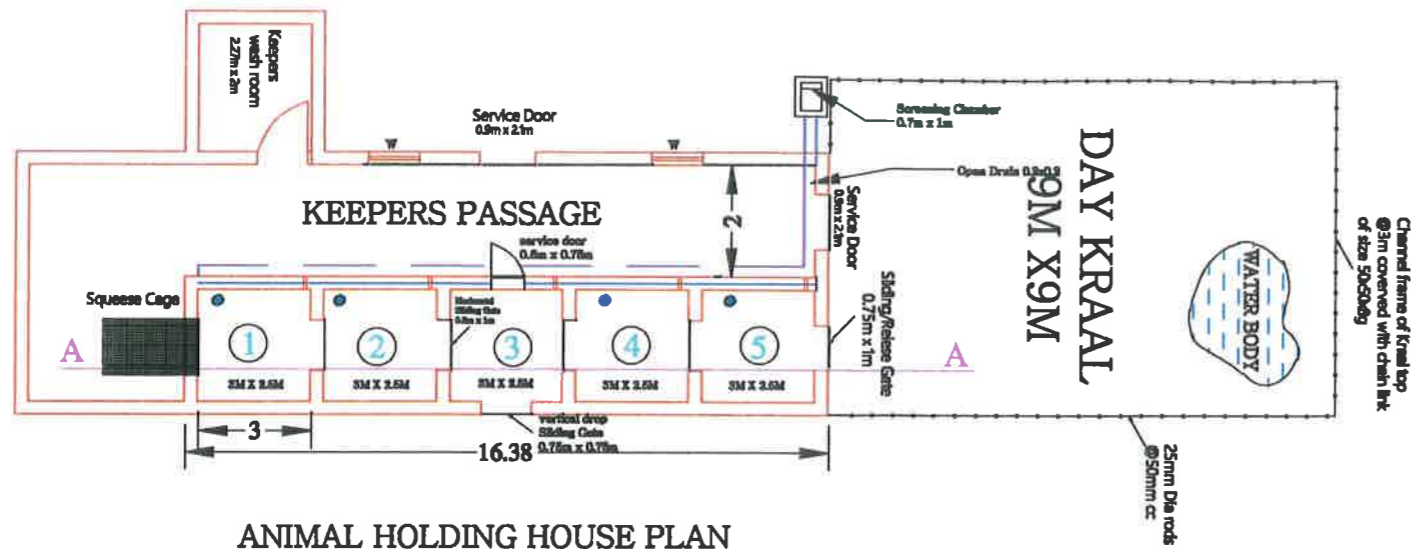

ANIMAL HOLDING HOUSE PLAN

Details of Opening

Sl No.	Location	Opening Size	Shutter
1.	Service Door	1m x 2.1m	16mm Dia Bars (Vertical Bars) Slide hung
2.	Keepers gallery to cell	0.75m x 1.8m	16mm Dia Bars (Vertical Bars) vertical sliding door with fly proof mesh
3.	Cell to Cell	0.9m x 1m	16mm Dia Bars (Vertical Bars) Horizontal sliding door with fly proof mesh
4.	Cell to Arena	0.75m x 0.75m	16mm Dia Bars (Vertical Bars) vertical drop sliding door with fly proof mesh
5.	Ventilator at Animal holding house	0.6m x 0.3m	Wooden frame with 16mm Dia Bars
6.	Windows at Keepers passage	0.9m x 1.2m	Wooden frame and shutter with 16mm Dia Bars

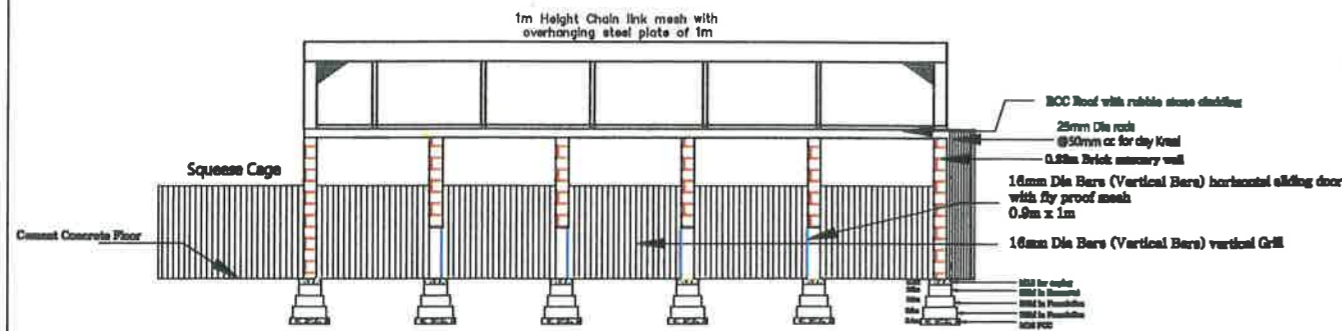

ANIMAL HOLDING HOUSE SECTION A-A

REVISED & RESUBMITTED

[Signature]
9/12/14

Executive Director
Bannerghatta Biological Park
Bannerghatta, Bengaluru