

73

436

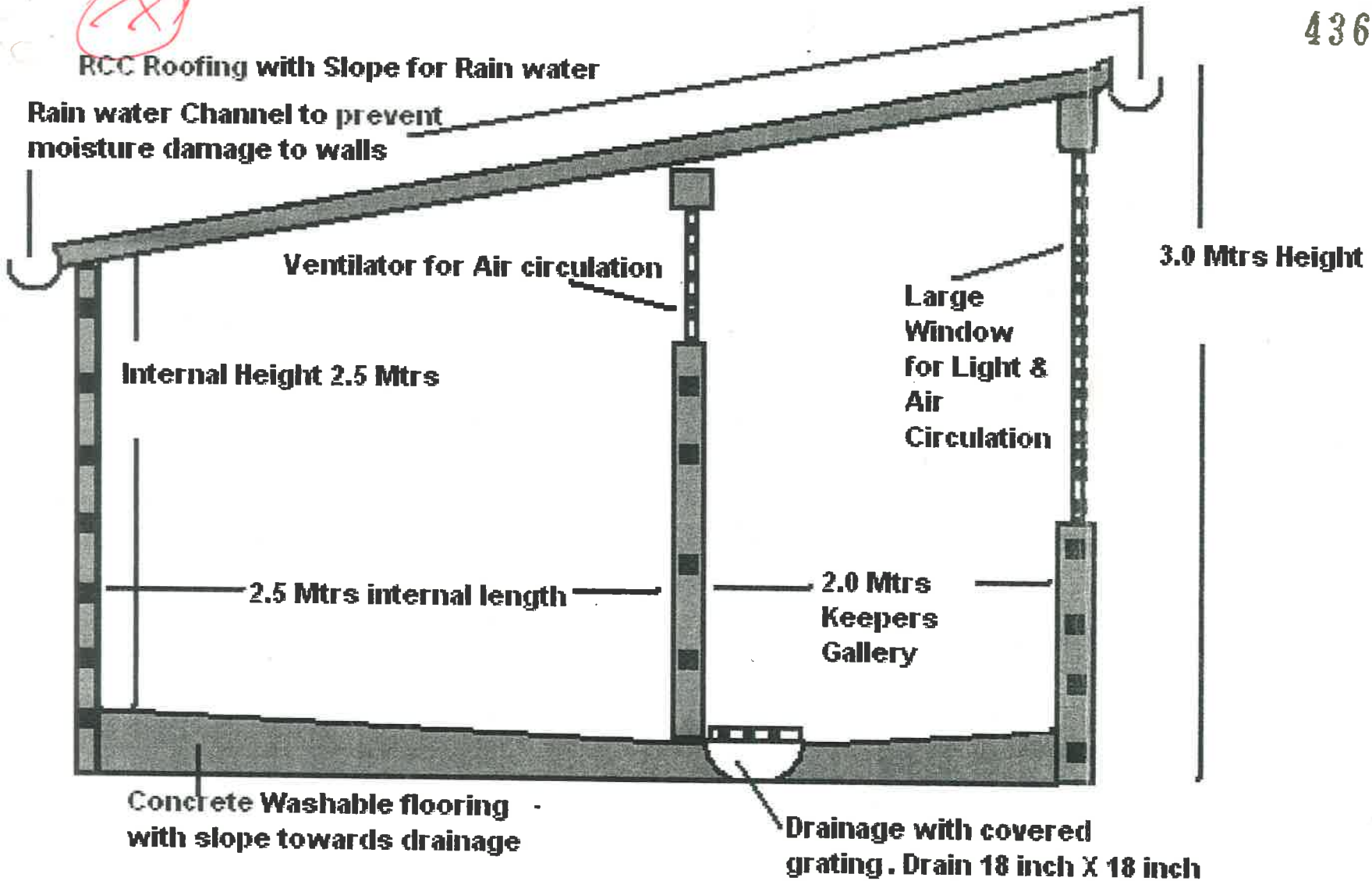

Brick Masonry Civil Works

Saloo
Executive Director
Bannerghatta Biological Park
Bangalore - 560 083.

13

Top View of Feeding / Retiring Den with Keepers Gallery for Bannerghatta Bear Rescue Centre as per CZA Guidelines

rc1

437

Length 2.5 Mtrs 2.0 Mtrs

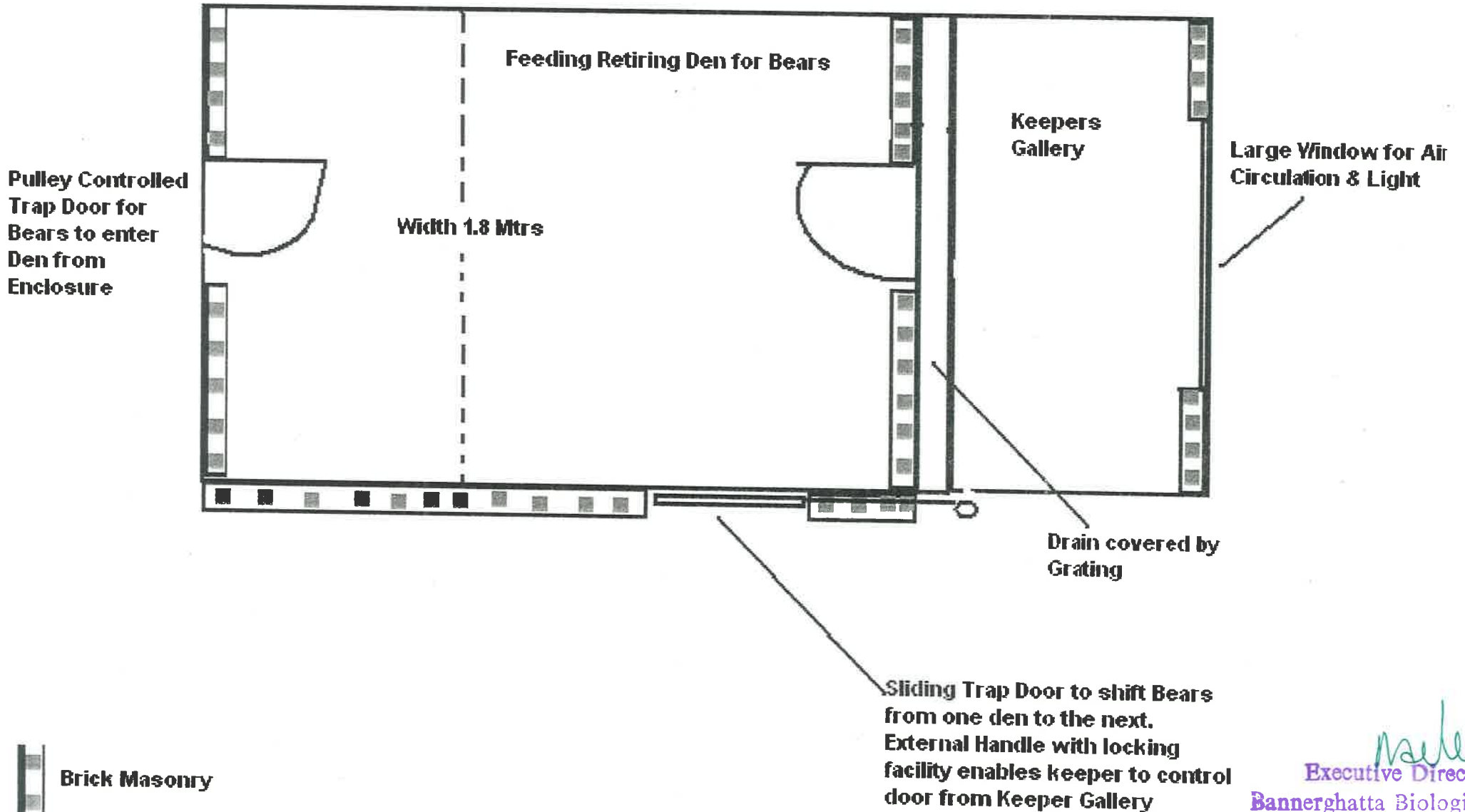

msk
Executive Director
Bannerghatta Biological Park
Bangalore - 560 083.



Feeding Retiring Den Building Structure with Keepers Gallery for Bannerghatta Bear Rescue Centre for housing 15 Bears following Prescribed guidelines of Central Zoo Authority

438

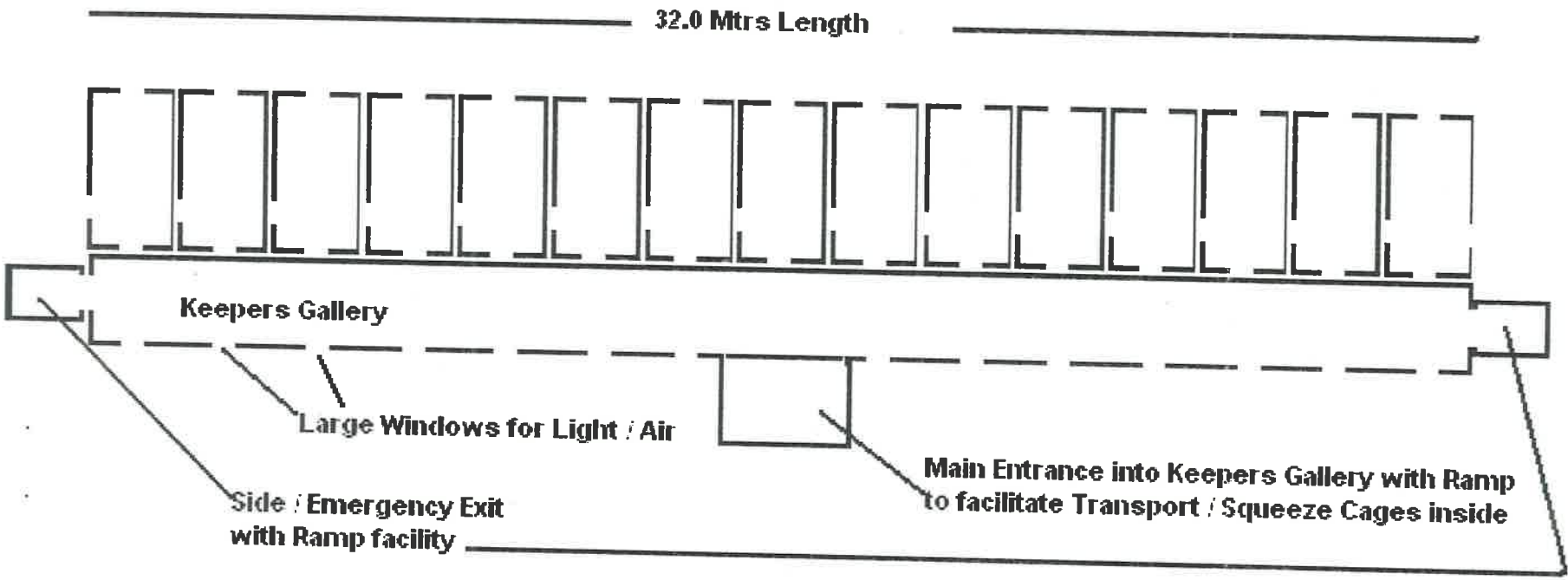

Top View of One 15 Den building unit structure

mselle
Executive Director
Bannerghatta Biological Park
Bangalore - 560 083.

73

439

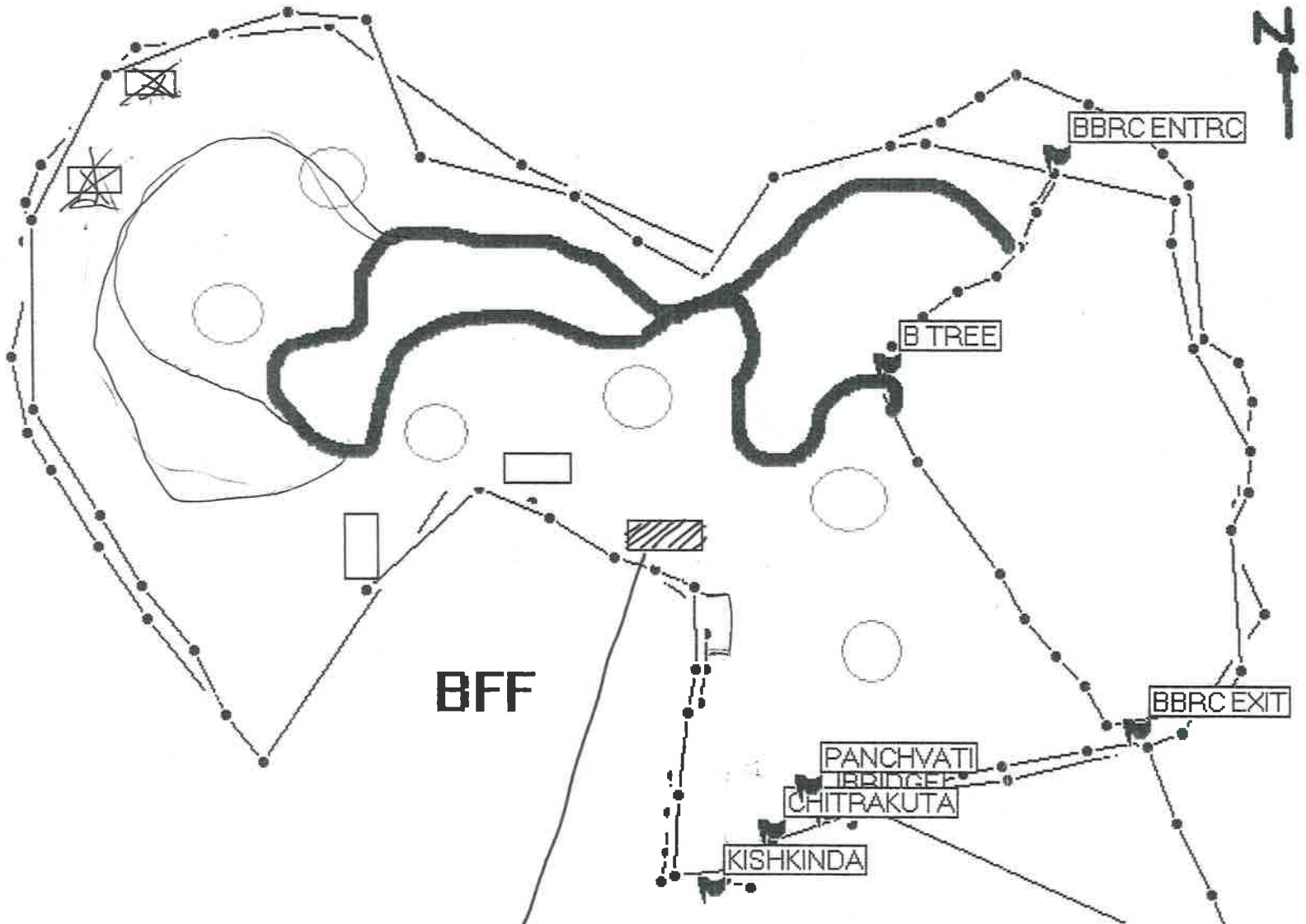

Proposed Feeding / Retiring Dens (1 unit x 20 Dens)
for housing rescued sloth Bears.

selva
Executive Director
Bannerghatta Biological Park
Bangalore - 560 083.

73

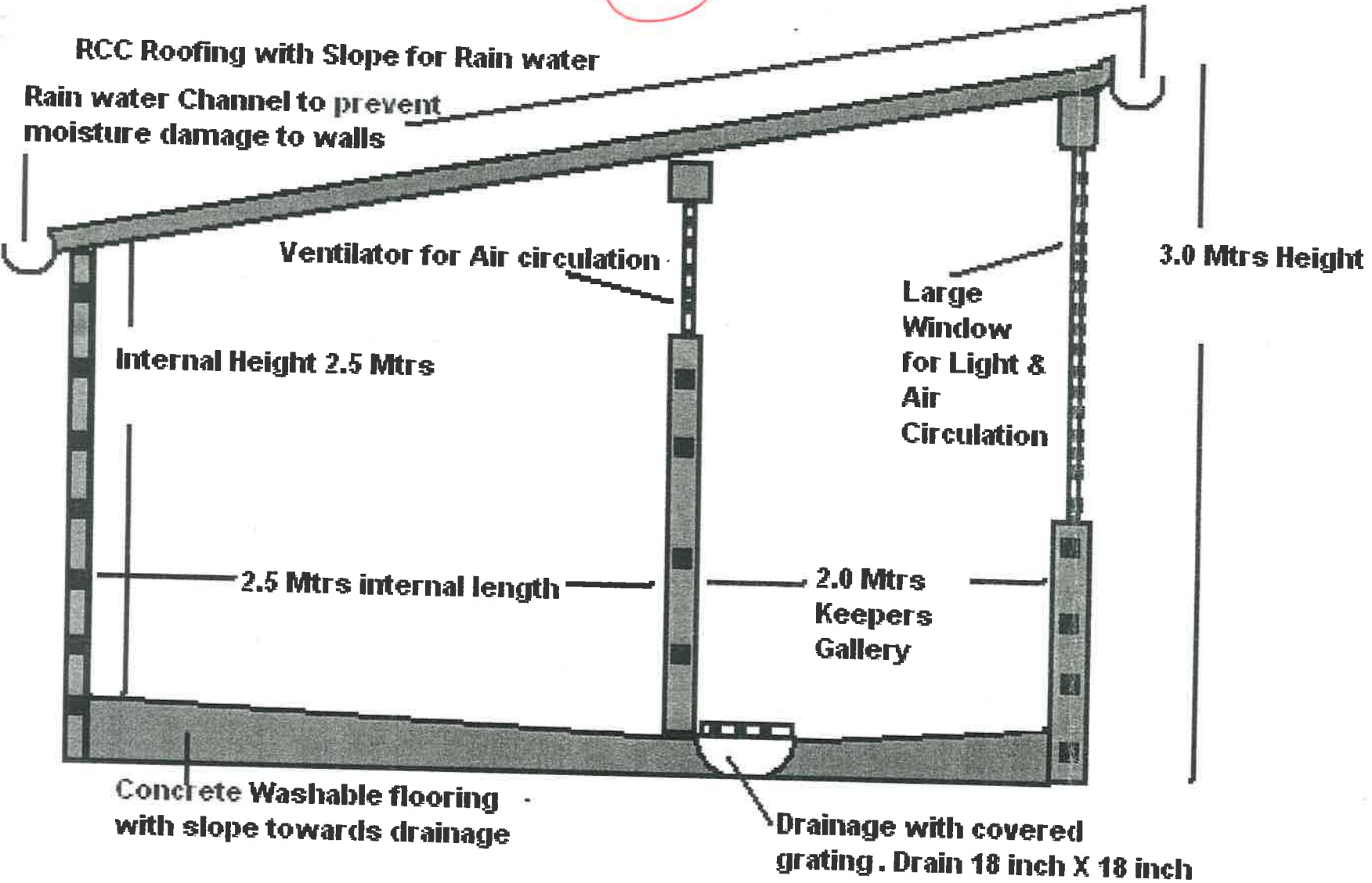

440

 **Brick Masonry Civil Works**

naheer
Executive Director
Bannerghatta Biological Park
Bangalore - 560 083.

43

rcl

Top View of Feeding / Retiring Den with Keepers Gallery for Bannerghatta Bear Rescue Centre as per CZA Guidelines

441

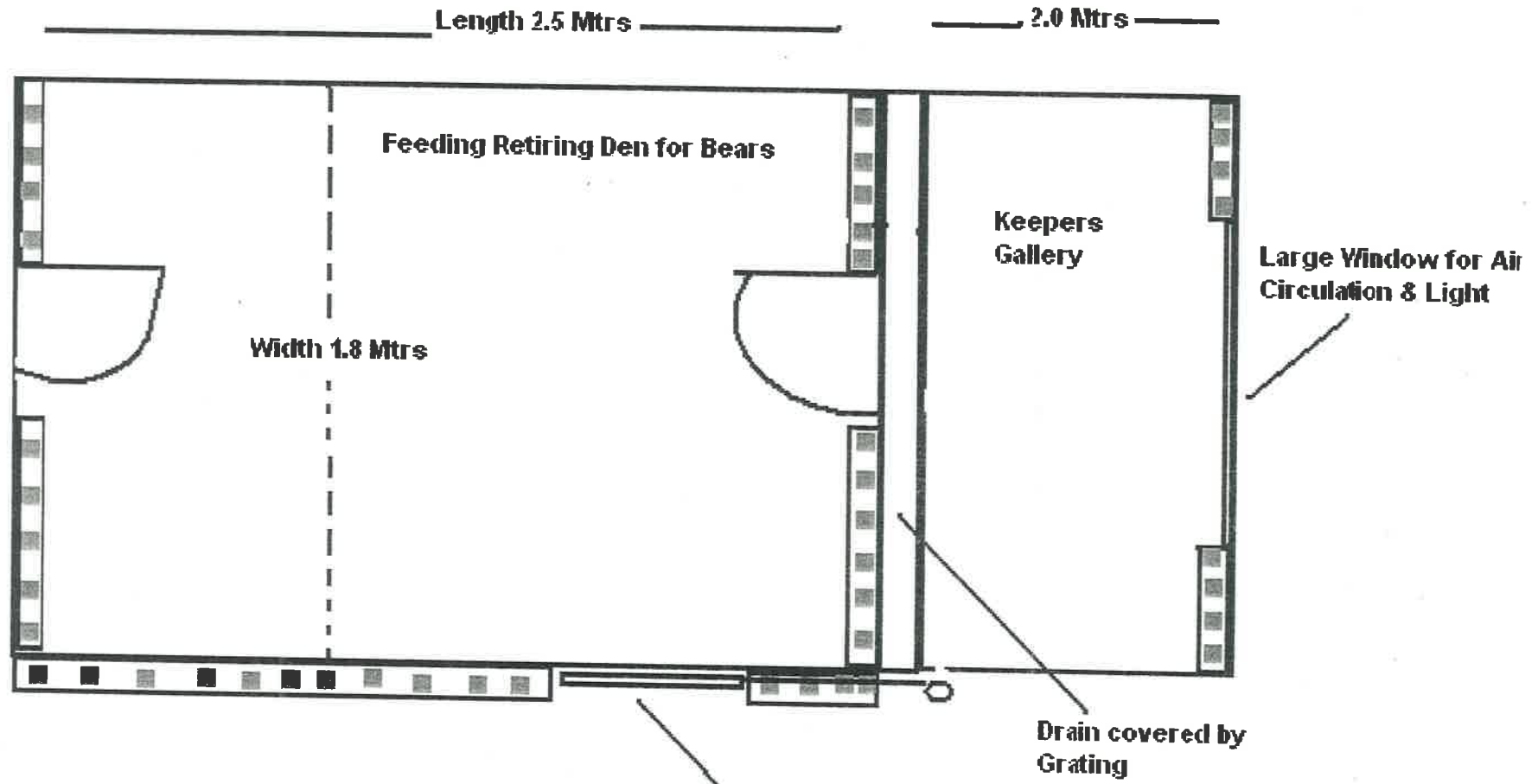

Sliding Trap Door to shift Bears from one den to the next. External Handle with locking facility enables keeper to control door from Keeper Gallery

Ms. S. S. S.
 Executive Director
 Bannerghatta Biological Park
 Bangalore - 560 083.

73

Feeding Retiring Den Building Structure with Keepers Gallery for Bannerghatta Bear Rescue Centre for housing 15 Bears following Prescribed guidelines of Central Zoo Authority

442

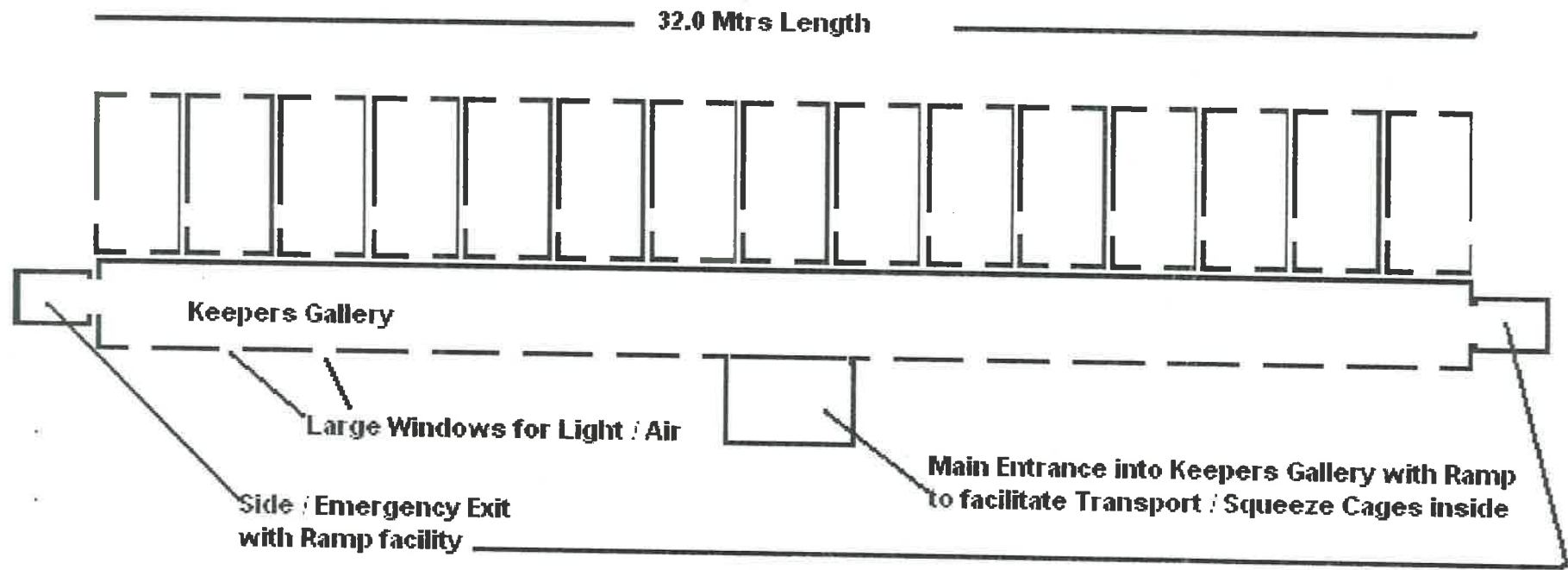

Top View of One 15 Den building unit structure

msd
Executive Director
Bannerghatta Biological Park
Bangalore - 560 083.