

SMALL CATS ENCLOSURE (LEOPARD, JUNGLE & TODDY CATS)

71256

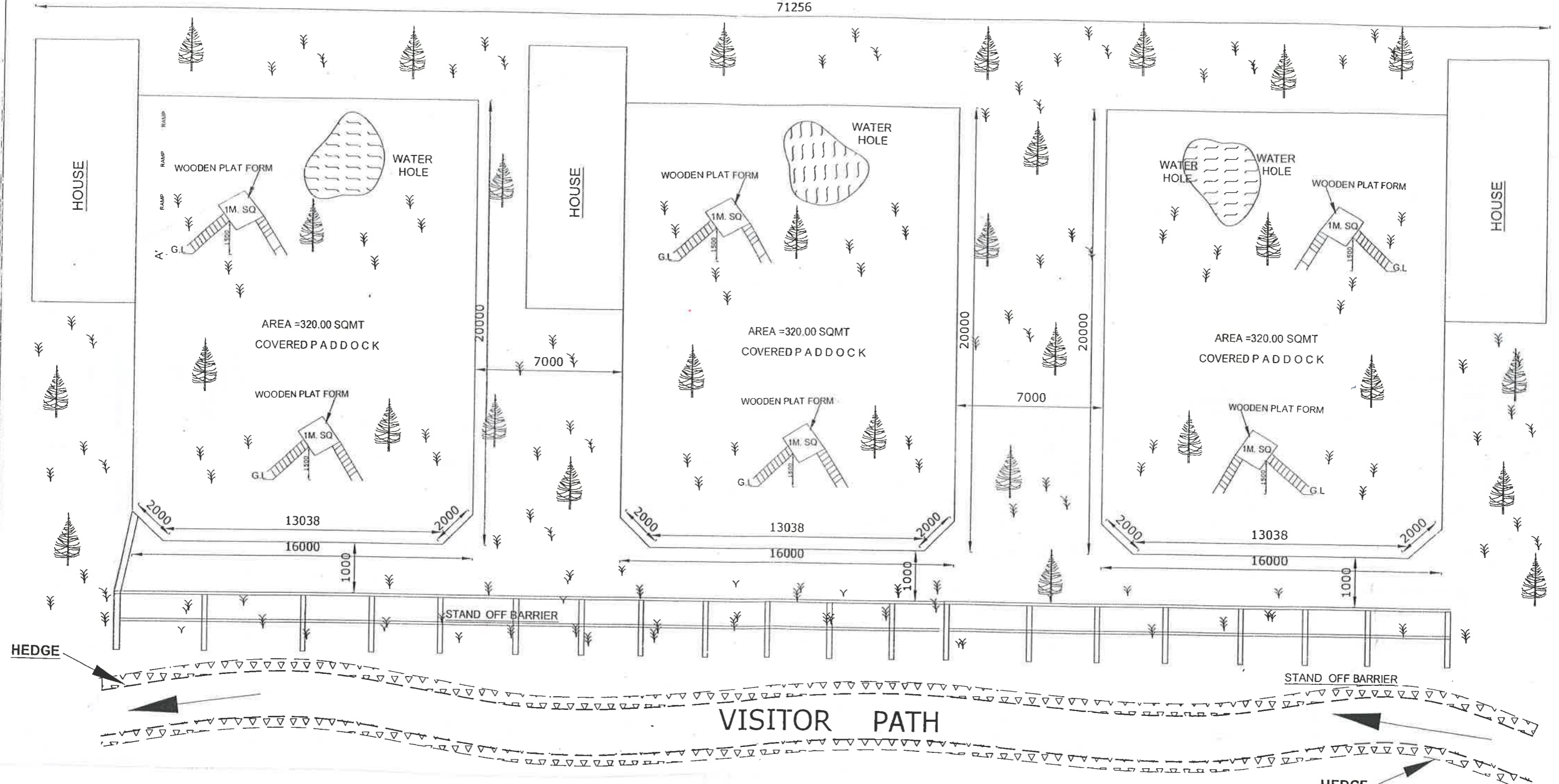

LAYOUT PLAN

The drawing of the Small cats (Leopard cat, Jungle cat & Civet cat) enclosure to be constructed at the Shaheed Ashfaque Ullah Khan Zoological Park, Gorakhpur, Uttar Pradesh was approved by the Expert Group on Zoo Designing of the Central Zoo Authority in its 76th Meeting held on 15.02.2018 vide Agenda Item No. 1[1(d)] subject to conditions laid by the Central Zoo Authority vide letter F. No. 20-4/2008-CZA(Vol. II)(PKR)/2549 dated 08.03.2018.

Dr. D. N. SINGHI, IFS
Member Secretary
Central Zoo Authority
Ministry of Environment, Forest and Climate Change
Govt. of India, New Delhi-110003

**SHAHEED ASHFAQE ULLAH KHAN
ZOOLOGICAL PARK GORAKHPUR**

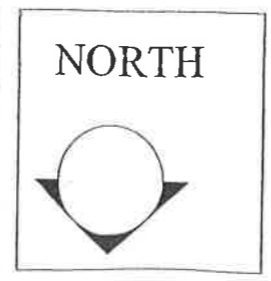

Scale : 1:280

Drawn by:- AWADHESH SHARMA
DRAUGHT 'S' MAN (CIVIL)
A- 1095/4 INDIRA NAGAR LUCKNOW

REGIONAL FOREST OFFICE
GORAKHPUR Forest Division
Gorakhpur

CONCEPT DESIGN BY
[Signature]
R.S. BHADAURIA, I.F.S. [Retd.]
LUCKNOW
CONSULTANT

[Signature]
S.K. UPADHYAY I.F.S.
CHIEF WILD LIFE WARDEN
U.P. LUCKNOW

SMALL CAT ENCLOSURE

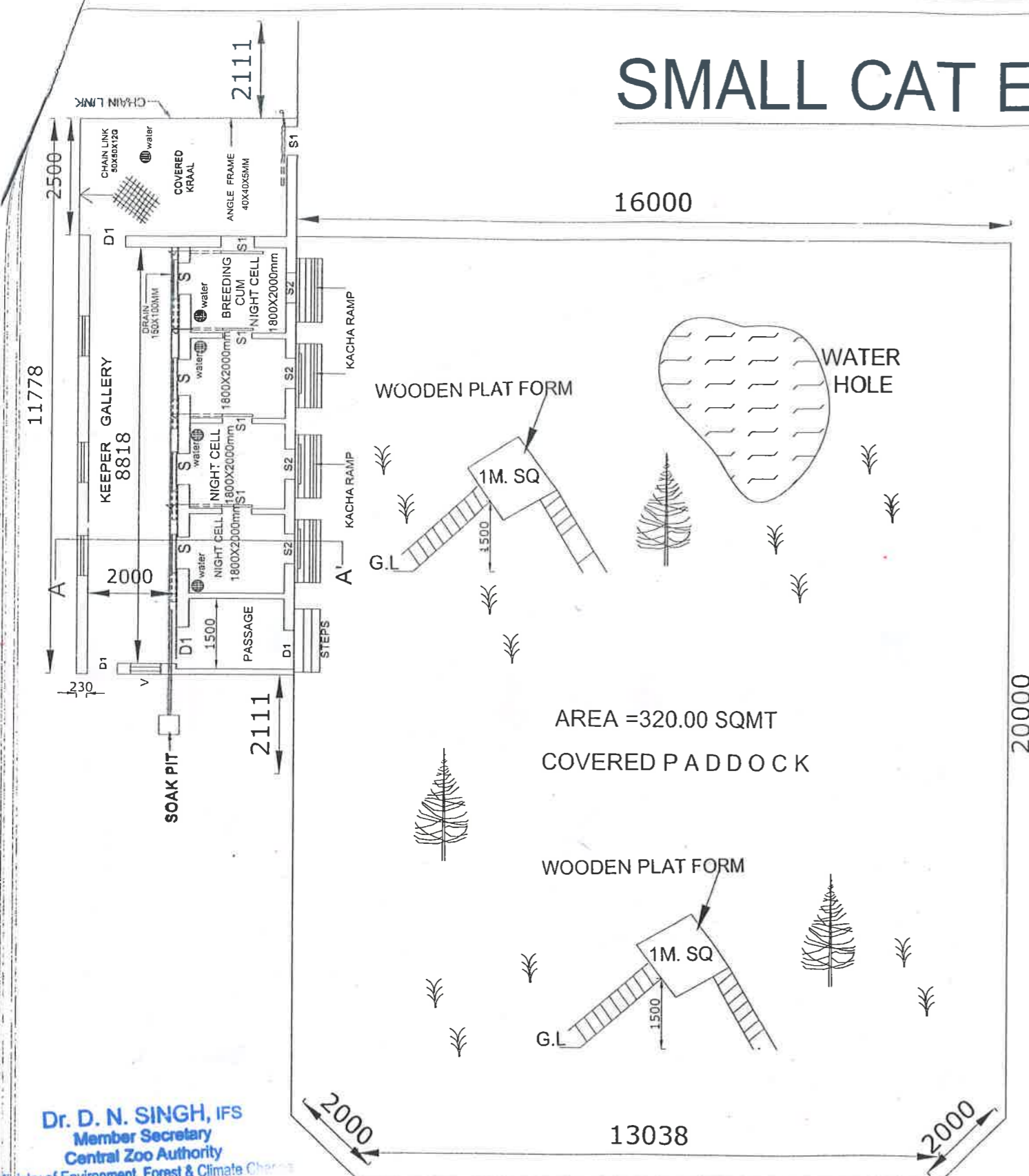

AREA = 320.00 SQMT
COVERED PADDOCK

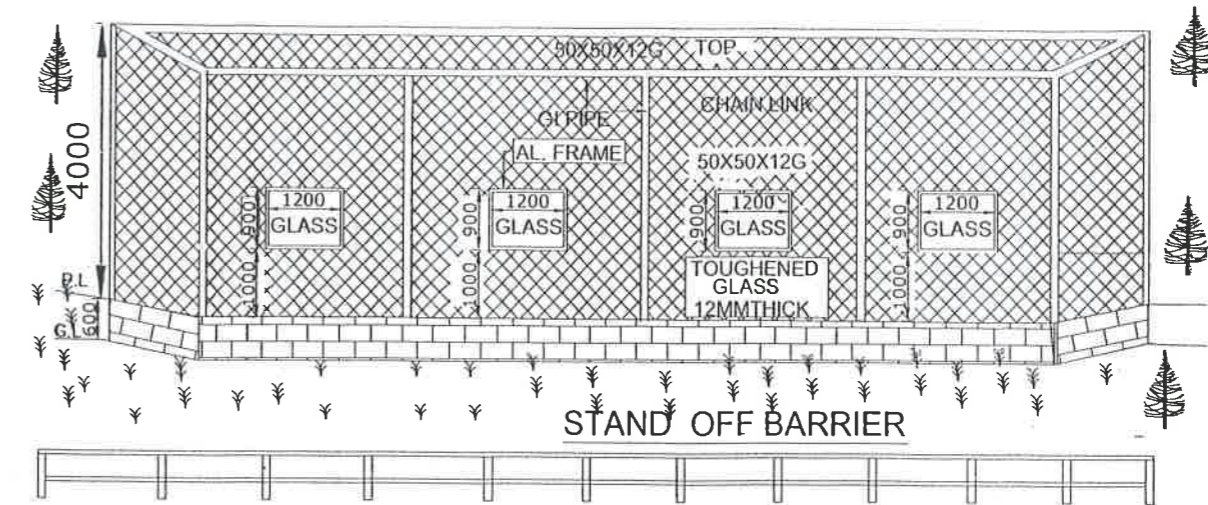

FRONT ELEVATION

DOOR SCHEDULE

NO	NAME	SIZE (MM)	TYPE
1	D1	900X1950	HINGE DOOR (STEEL DOOR)
2	S	750 X 1500	HINGE DOOR (GRILL DOOR)
3	S1	450X450	SLIDE DOOR (SL SHEET)
4	S2	450X450	DRAW UP SLIDE DOOR (S.L. STEEL DOOR)
5	W	900X1200	WINDOW
6	V	750X450	VENTILATOR

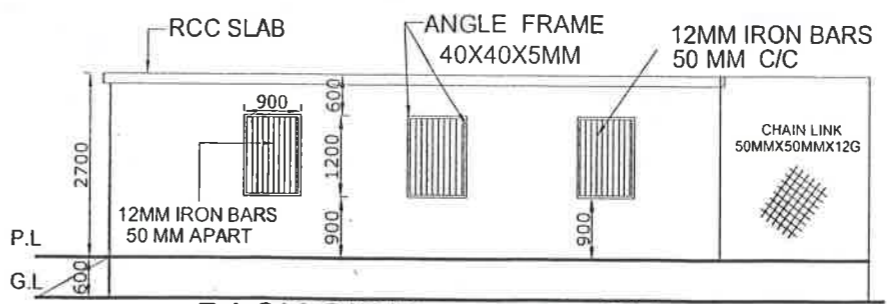

BACK SIDE ELEVATION

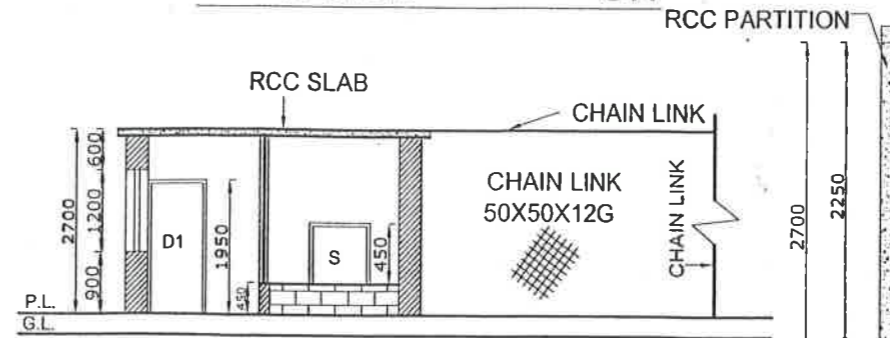

SECTION AT A-A'

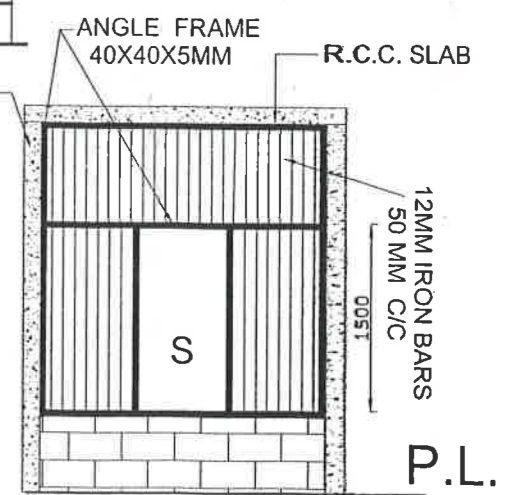

FRONT VIEW OF NIGHT CELL FROM GALLERY

Dr. D. N. SINGH, IFS
Member Secretary
Central Zoo Authority
Ministry of Environment, Forest & Climate Change
Govt. of India, New Delhi-110003

The drawing of the Small cats (Leopard cat, Jungle cat & Civet cat) enclosure to be constructed at the Shaheed Ashfaq Ullah Khan Zoological Park, Gorakhpur, Uttar Pradesh was approved by the Expert Group on Zoo Designing of the Central Zoo Authority in its 76th Meeting held on 15.02.2018 vide Agenda Item No. 1[1(d)] subject to conditions laid by the Central Zoo Authority vide letter F. No. 20-4/2008-CZA(Vol. II)(PKR)/2549 dated 08.03.2018.

Dr. D. N. SINGH, IFS
Member Secretary
Central Zoo Authority
Ministry of Environment, Forest & Climate Change
Govt. of India, New Delhi-110003

**SHAHEED ASHFAQ ULLAH KHAN
ZOOLOGICAL PARK, GORAKHPUR**

NORTH



Drg title :



Scale : 1:160

Drawn by:-

AWADHESH SHARMA
DRAUGHT 'S/ MAN (CIVIL)
A- 1095/4 INDIRA NAGAR LUCKNOW

CONCEPT DESIGN BY

R.S. BHADAURIA, I.F.S. [Retd.]
LUCKNOW
CONSULTANT

S.K. UPADHYAY I.F.S.
CHIEF WILD LIFE WARDEN
U.P. LUCKNOW