

# HIMALAYAN BLACK BEAR ENCLOSURE

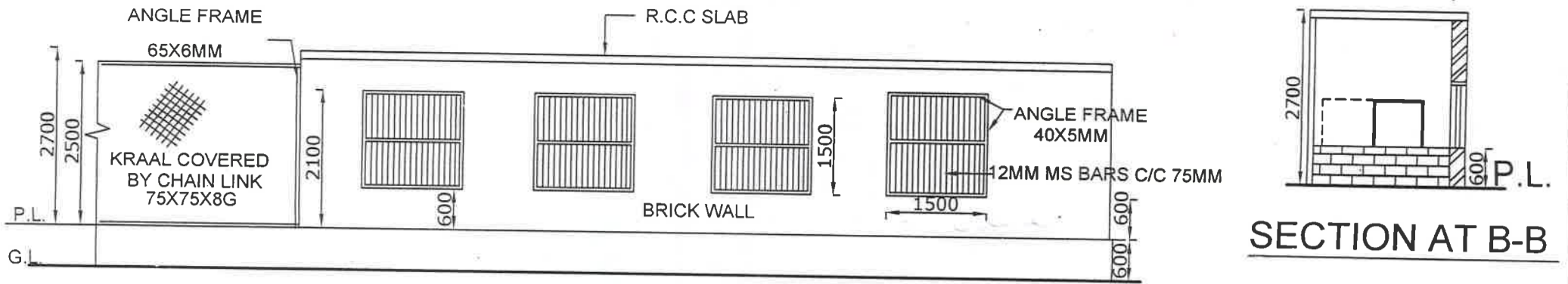

**BACK ELEVATION**

The drawing of the Himalayan black bear enclosure to be constructed at the Shaheed Ashfaq Ullah Khan Zoological Park, Gorakhpur, Uttar Pradesh was approved by the Expert Group on Zoo Designing of the Central Zoo Authority in its 76<sup>th</sup> Meeting held on 15.02.2018 vide Agenda Item No. 1[1(i)] subject to conditions laid by the Central Zoo Authority vide letter F. No. 20-4/2008-CZA(Vol. II)(PKR)/2549 dated 08.03.2018.

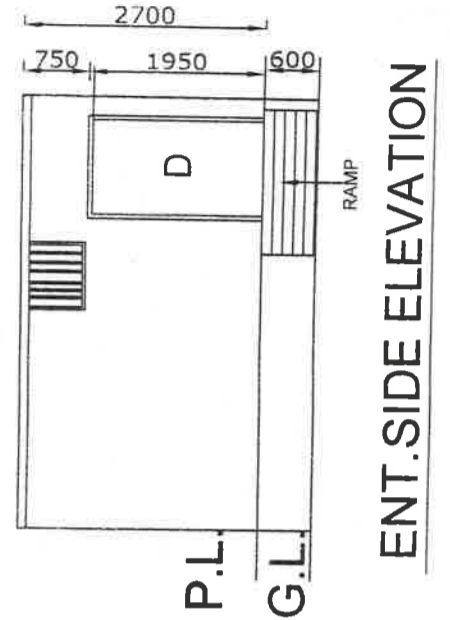

**ENT. SIDE ELEVATION**

Dr. D. N. SINGH, IFS  
Member Secretary  
Central Zoo Authority  
Ministry of Environment, Forest & Climate Change  
Govt. of India, New Delhi-110003

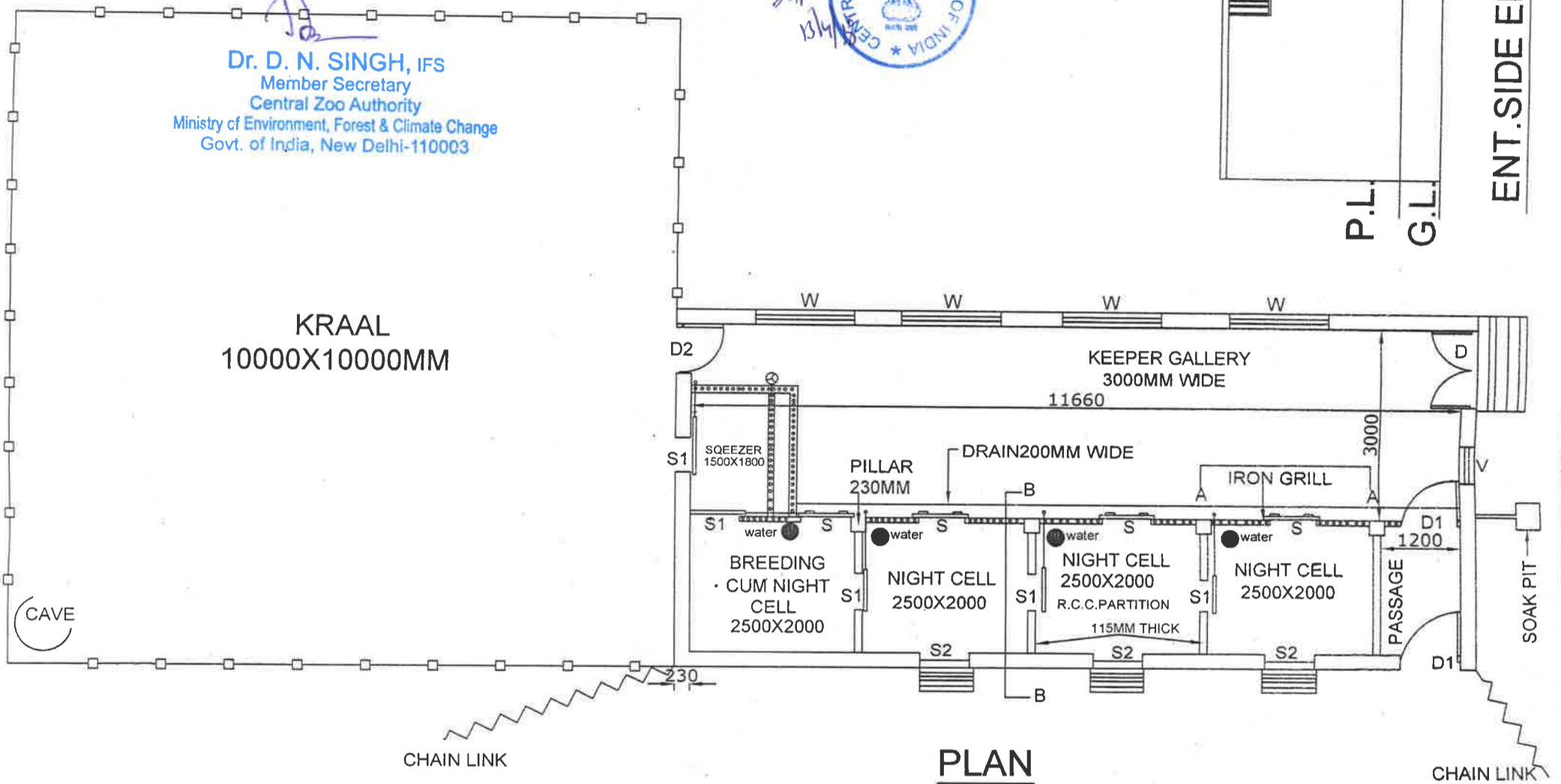

**PLAN**

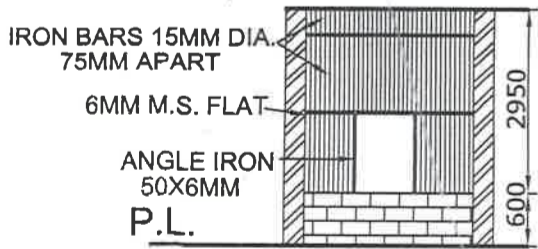

**FRONT ELEVATION OF NIGHT CELL AT A-A**

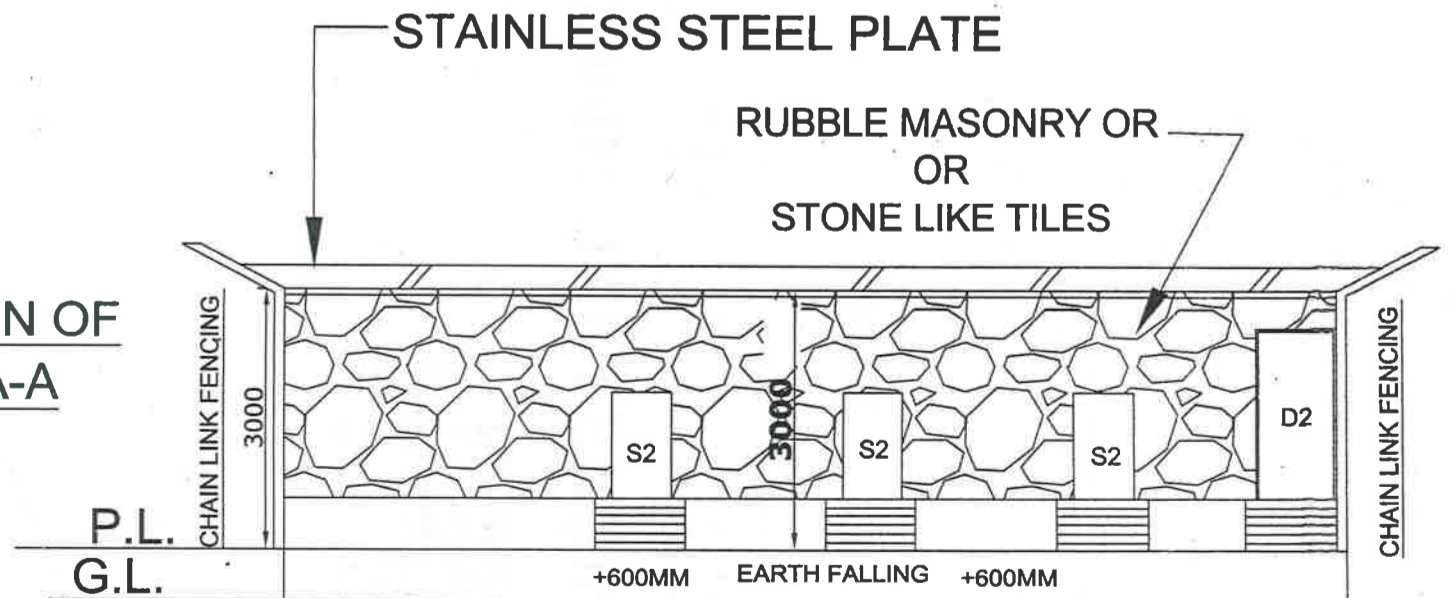

**FRONT ELEVATION**

SHAHEED ASHFAQ ULLAH KHAN  
ZOOLOGICAL PARK GORAKHPUR

NORTH



Drg title :

Scale :

1:120

Drawn by:- AWADHESH SHARMA  
DRAUGHT 'S'/MAN ( CIVIL )  
A- 1095/4 INDIRA NAGAR LUCKNOW

COMCEPT DESIGN BY

*(Signature)*  
R.S. BHADAURIA, I.F.S. [ Retd.]

*(Signature)*  
S.K. UPADHYAY I.F.S.  
CHIEF WILD LIFE WARDEN UP

# HIMALAYAN BLACK BEAR ENCLOSURE

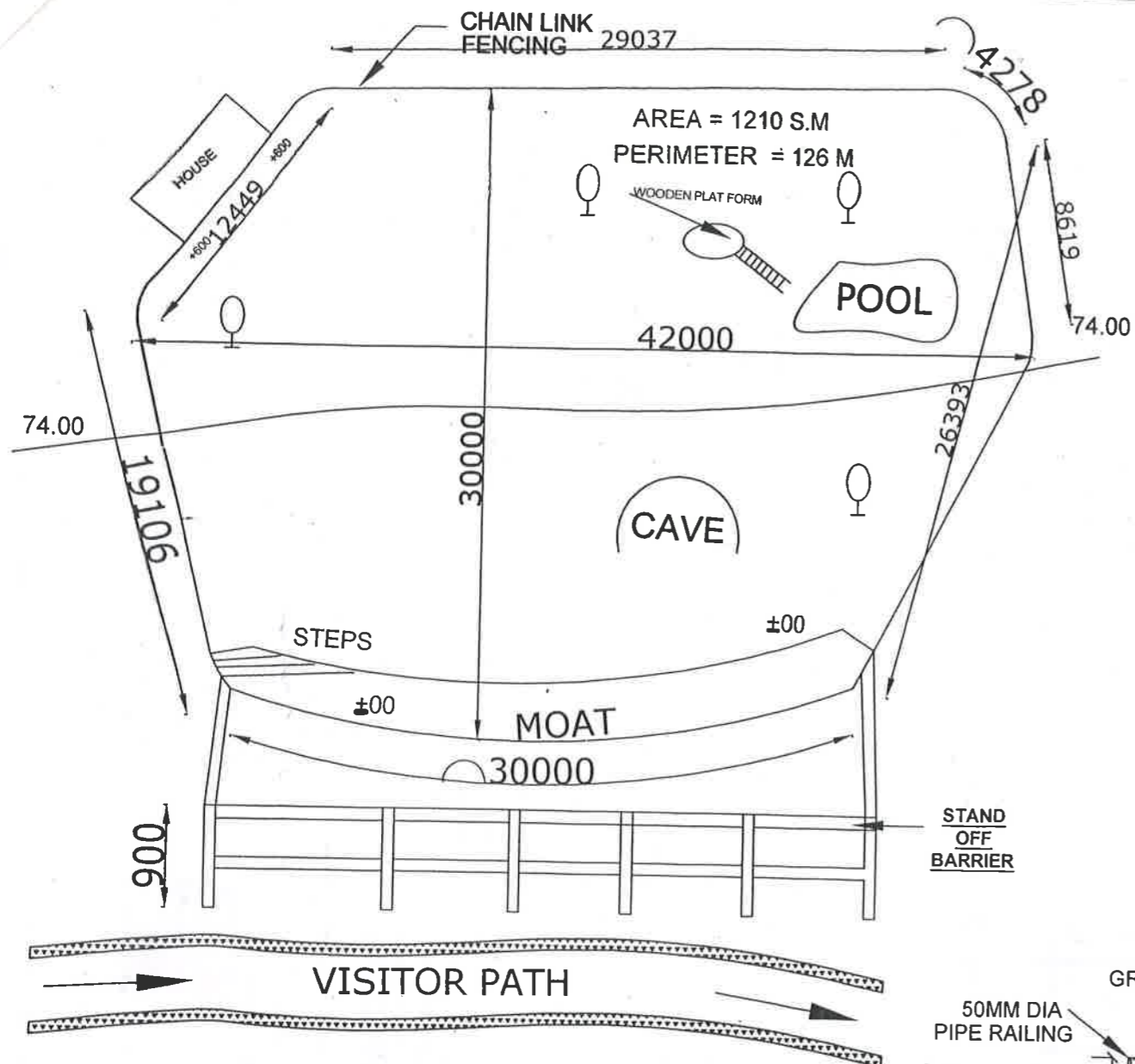

## LAYOUT PLAN

The drawing of the Himalayan black bear enclosure to be constructed at the Shaheed Ashfaq Ullah Khan Zoological Park, Gorakhpur, Uttar Pradesh was approved by the Expert Group on Zoo Designing of the Central Zoo Authority in its 76<sup>th</sup> Meeting held on 15.02.2018 vide Agenda Item No. 1[1(I)] subject to conditions laid by the Central Zoo Authority vide letter F. No. 20/4/2008-CZA(Vol. II)(PKR)/2549 dated 08.03.2018.

**Dr. D. N. SINGH, IFS**  
Member Secretary  
Central Zoo Authority  
Ministry of Environment, Forest & Climate Change  
Govt. of India, New Delhi-110003

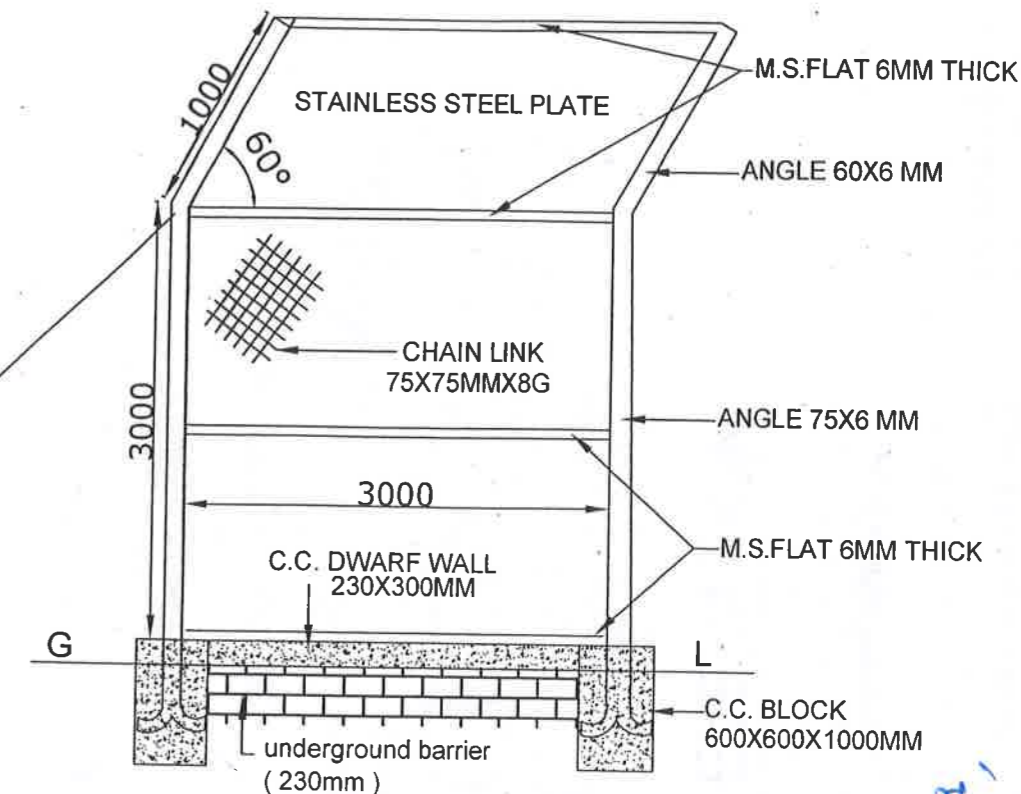
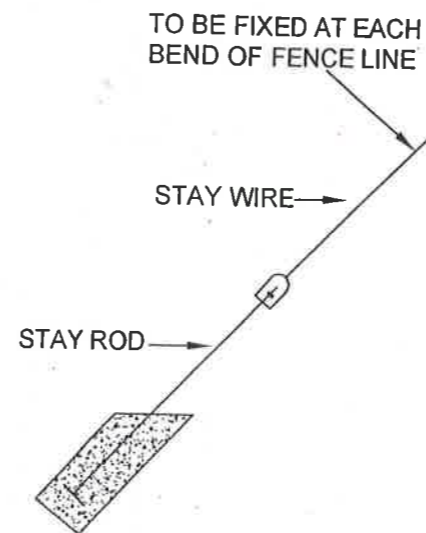

## CHAIN LINK FENCING

## DOOR SCHEDULE

NO.	NAME	SIZE	TYPE
1	D	1200X1950	HINGED DOOR (MS SHEET)
2	D1	900X1950	HINGED DOOR GRILLED
3	D2	750X1950	HINGED DOOR (MS SHEET)
2	S	750X1200	SLIDING DOOR GRILLED
5	S1	675X1000	(S.L. STEEL SHEET) SLIDING
6	S2	675X1000	DRAW UP SLIDE (S.L. STEEL SHEET)
7	W	1500X1500	WINDOW
8	V	750X600	VENTILATOR

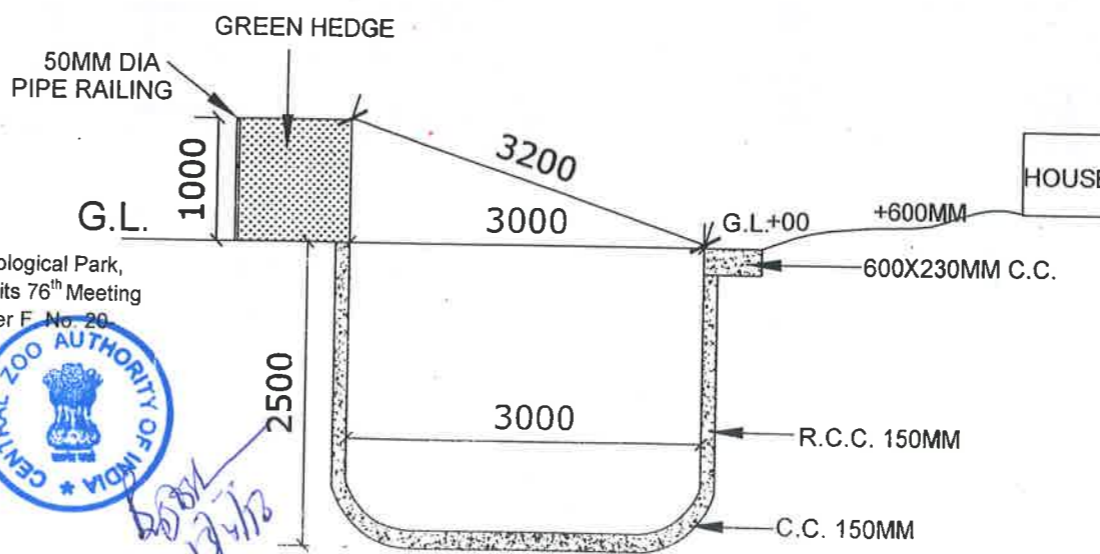

## SECTION OF MOAT

**SHAHEED ASHFAQ ULLAH KHAN  
ZOOLOGICAL PARK GORAKHPUR**

NORTH



Drg title :

Scale :  
1:430

Drawn by:-

AWADHESH SHARMA  
DRAUGHT 'S/ MAN ( CIVIL )  
A- 1095/4 INDIRA NAGAR LUCKNOW

CONCEPT DESIGN BY  
*R. S. Bhadauria*  
R.S. BHADAURIA, I.F.S. [ Retd. ]  
LUCKNOW  
CONSULTANT

S.K. UPADHYAY I.F.S.  
CHIEF WILD LIFE WARDEN U.P.