

NORTH
Scale : 1 :200

Legend	
	Chain link mesh 50X50X8 gauge 3mtr height with 0.6m overhang
	Visitors path with Interlock pavers
	Burnt Brick Masonry wall CM 1:6
	Waterbody
	Moat Area

TYPICAL PLAN OF WILD DOG ENCLOSURE

The drawing of the Wild dog enclosure to be constructed at Bannerghatta Biological Park, Bangalore, Karnataka was approved by the Expert Group on Zoo Designing of the Central Zoo Authority in its 70th Meeting held on 02.11.2016 vide Agenda Item No. 3(3) subject to conditions laid by the Central Zoo Authority vide letter dated F. No. 19-80/92-CZA(125)(Vol. IX)(BKG)/3050/2016 dated 23.11.2016.

Dr. D. N. SINGH, IFS
 Member Secretary
 Central Zoo Authority
 Ministry of Environment, Forest & Climate Change
 Govt. of India, New Delhi-110003



 Addl. Principal Chief Conservator of Forests
 (Wildlife) & Chief Wildlife Warden,
 Karnataka, Bengaluru.

 Executive Director
 Bannerghatta Biological Park
 Bannerghatta, Bengaluru



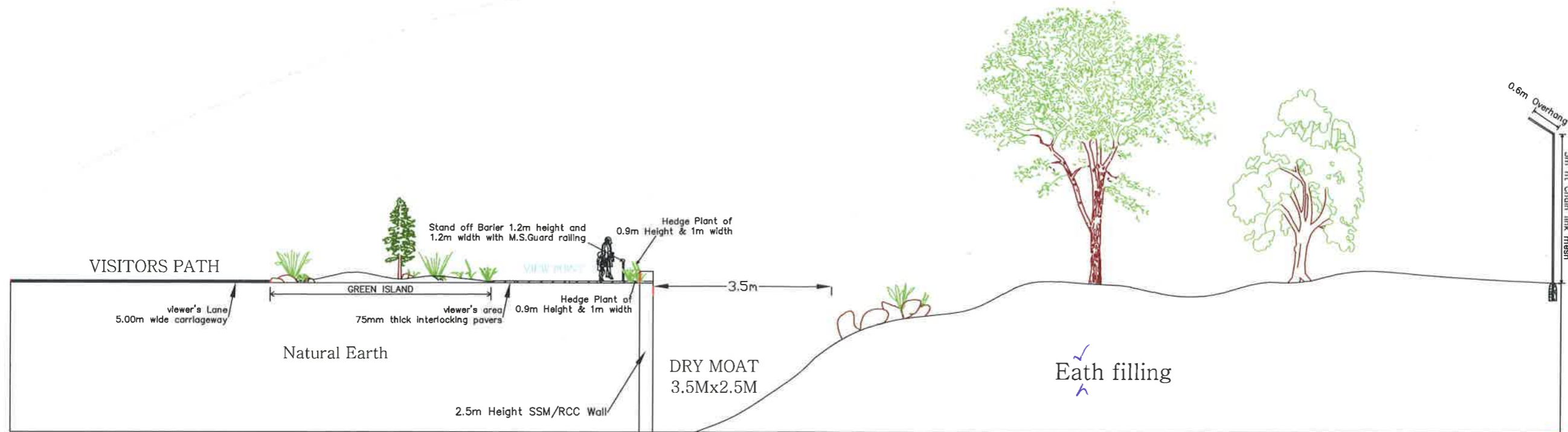

NORTH
Scale : 1 : 150



CROSS SECTION OF WILD DOGS ENCLOSURE

The drawing of the Wild dog enclosure to be constructed at Bannerghatta Biological Park, Bangalore, Karnataka was approved by the Expert Group on Zoo Designing of the Central Zoo Authority in its 70th Meeting held on 02.11.2016 vide Agenda Item No. 3(3) subject to conditions laid by the Central Zoo Authority vide letter dated F. No. 19-80/92-CZA(125) Vol. IX)(BKG)/3050/2016 dated 23.11.2016.

Dr. D. N. SINGH, IFS
Member Secretary
Central Zoo Authority
Ministry of Environment, Forest & Climate Change
Govt. of India, New Delhi-110003

Addl. Principal Chief Conservator of Forests
(Wildlife) & Chief Wildlife Warden,
Karnataka, Bengaluru.





Executive Director
Bannerghatta Biological Park
Bannerghatta, Bengaluru

The drawing of the Wild dog enclosure to be constructed at Bannerghatta Biological Park, Bangalore, Karnataka was approved by the Expert Group on Zoo Designing of the Central Zoo Authority in its 70th Meeting held on 02.11.2016 vide Agenda Item No. 3(3) subject to conditions laid by the Central Zoo Authority vide letter dated F. No. 19-80/92-CZA(125)(Vol. IX)(BKG)/3050/2016 dated 23.11.2016.

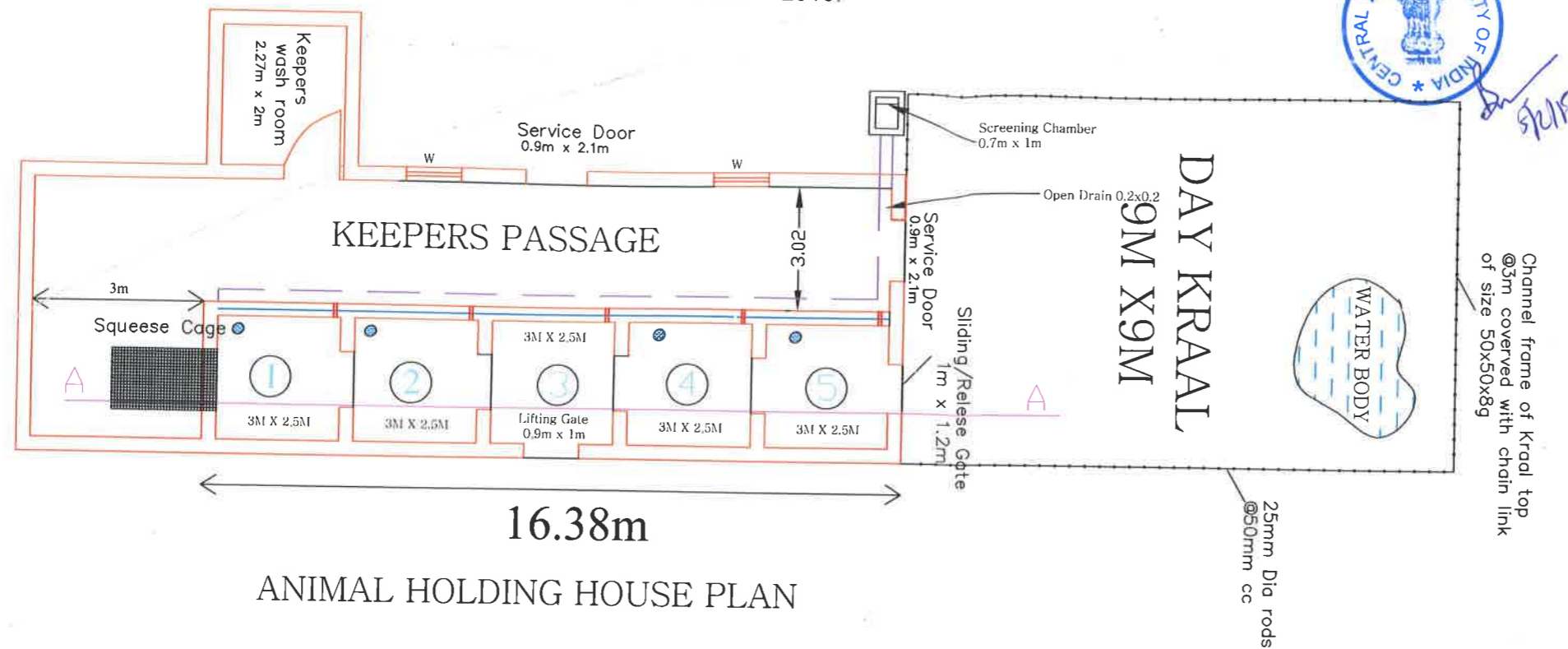

NORTH
Scale : 1 : 150



ANIMAL HOLDING HOUSE PLAN

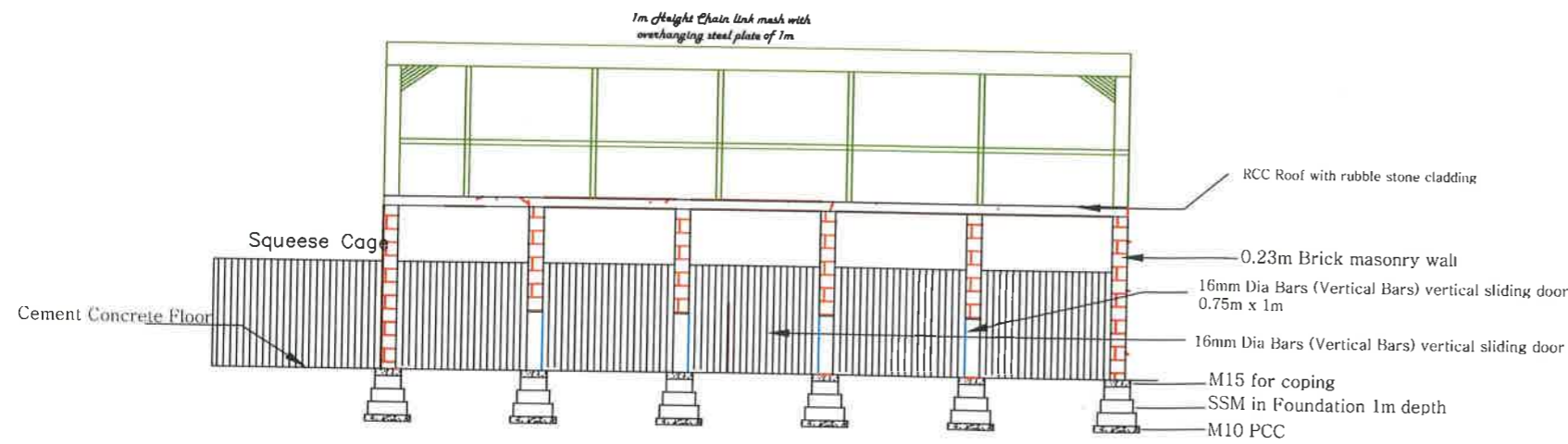

ANIMAL HOLDING HOUSE SECTION A-A

Details of Opening

Sl No.	Location	Opening Size	Shutter
1.	Service Door	1m x 2.1m	16mm Dia Bars (Vertical Bars) Slide hung
2.	Keepers gallery to cell	0.75m x 1.8m	16mm Dia Bars (Vertical Bars) vertical sliding door
3.	Cell to Cell	0.75m x 0.9m	16mm Dia Bars (Vertical Bars) vertical sliding door
4.	Cell to Arena	0.9m x 1m	16mm Dia Bars (Vertical Bars) vertical sliding door
5.	Ventilator at Animal holding house	0.6m x 0.3m	Wooden frame with 16mm Dia Bars
6.	Windows at Keepers passage	0.9m x 1.2m	Wooden frame and shutter with 16mm Dia Bars

D
Dr. D. N. SINGH, IFS
Member Secretary
Central Zoo Authority
Ministry of Environment, Forest & Climate Change
Govt. of India, New Delhi-110003
05/12/2018

CA
Addl. Principal Chief Conservator of Forests
(Wildlife) & Chief Wildlife Warden,
Karnataka, Bengaluru.

CA
Executive Director
Bannerghatta Biological Park
Bannerghatta, Bengaluru