

**EXTENSION PLAN OF EXISTING LEOPARD ENCLOSURE  
BHAGWAN BIRSA BIOLOGICAL PARK, ORMANJHI, RANCHI**

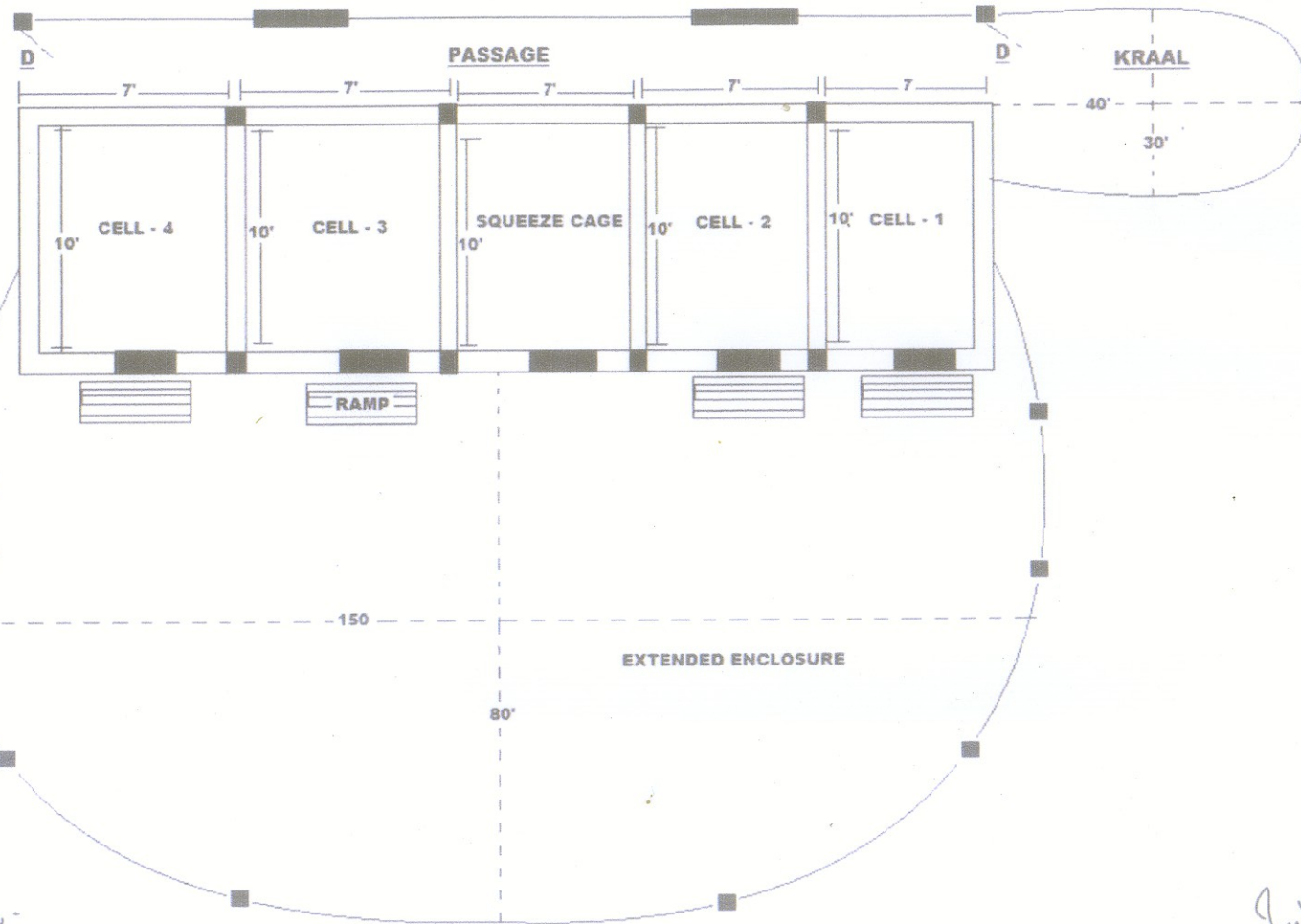

*Dr.*  
**Dr. D. N. SINGH, IFS**  
 Member Secretary  
 Central Zoo Authority  
 Ministry of Environment, Forest & Climate Change  
 Govt. of India, New Delhi-110003

*Asst. Secy*  
**Member Secretary**  
 Jharkhand Zoo Authority,  
 Chakia, Ormanjhi, Ranchi.

*Ashwin*  
**Assistant Conservator of Forest**  
 Bhagwan Birsa Biological Park  
 Ormanjhi, Ranchi



*Santhosh*  
 Range Forest Officer - 1  
 Bhagwan Birsa Biological Park  
 Ormanjhi.

Drawing on extension of existing enclosure for Leopard at the Bhagwan Birsa Biological Park, Ranchi is approved by the Expert Group on Zoo Designing, CZA in its 71<sup>st</sup> Meeting held on 17<sup>th</sup> January, 2017 vide agenda item No.3(A). While construction of enclosures, structural stability of the enclosures should be ensured by the concerned Structural Engineer.