

LEOPARD SAFARI ETAWAH  
LAYOUT PLAN

49

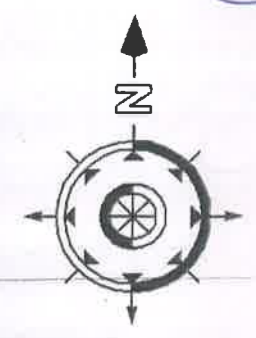

Approved by the Expert Group on Zoo Designing of the Central Zoo Authority in its 67<sup>th</sup> meeting held on 9<sup>th</sup> March, 2016 vide agenda item No.8.

*Dr. D. N. Singh*  
Dr. D. N. SINGH, IFS  
Member Secretary  
Central Zoo Authority  
Ministry of Environment, Forest & Climate Change  
Govt. of India, New Delhi-110003

*Dr. D. N. Singh*  
08/09/16

Architects:

Vishal & Associates  
3/77, Viraj khand,  
Gomti Nagar, Lucknow  
Ph: 9839447965, 9839097571

N.T.S.

*[Signature]*  
PCCF WILD LIFE  
UTTAR PRADESH LUCKNOW

*[Signature]*  
DIRECTOR,  
LEOPARD SAFARI PARK ETAWAH



# LEOPARD SAFARI ENCLOSURE, ETAWAH

## HOUSE 01

## HOUSE 02

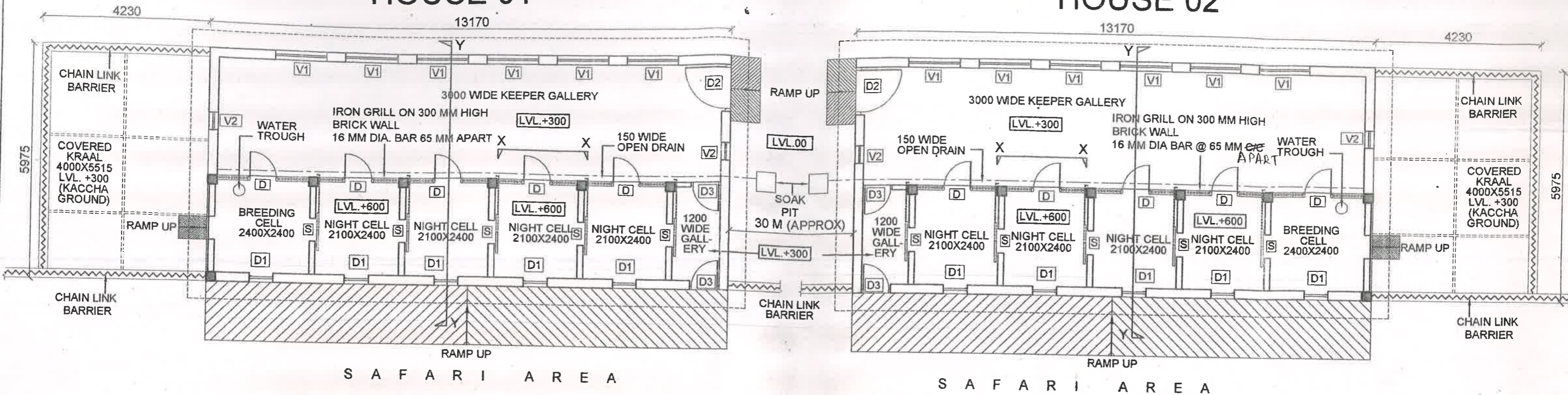

# GROUND FLOOR PLAN

For Vishal & Associates  
*[Signature]*  
 Partner

Drg. No.	ETAWAH/LEOPARD/AR/02		
Project:	LEOPARD SAFARI ENCLOSURE, ETAWAH		
Drg title:	GROUND FLOOR PLAN (WORKING DRAWING)		
Date:	29.04.16	Scale:	NTS
Drawn By:	Hari		North:
Concept:	Mr. R. S. BHADOURIA		
Construction Agency:	AWAS VIKAS, UTTAR PRADESH		
Architects:	Vishal & Associates 3/77, Viraj khand, Gomti Nagar, Lucknow Ph: 9839447965, 9839097571		

DOOR WINDOW SCHEDULE			
S.NO.	NAME	SIZE	TYPE
01	D	750 X 1200	HINGE DOOR (GRILL DOOR)
02	D1	600 X 900	DRAW UP DOOR (STEEL DOOR)
03	D2	1200 X 1800	HINGE DOOR (M.S. DOOR)
04	D3	900 X 1800	HINGE DOOR (M.S. DOOR)
05	S	600 X 900	SLIDE DOOR (STEEL DOOR)
06	V1	1300 X 900	VENTILATOR
07	V2	450 X 600	VENTILATOR

REVISIONS	
Date	Description

Approved by the Expert Group on Zoo Designing of the Central Zoo Authority in its 67<sup>th</sup> meeting held on 9<sup>th</sup> March, 2016 vide agenda item No.8.

*[Signature]*  
 Dr. [Name], IFS  
 Member Secretary  
 Central Zoo Authority  
 Ministry of Environment, Forest & Climate Change  
 Govt. of India, New Delhi-110003

*[Signature]*  
 डा0 रूपक डे  
 प्रधान मुख्य वन संरक्षक, वन्य जीव  
 उत्तर प्रदेश, लखनऊ