



केन्द्रीय चिड़ियाघर प्राधिकरण  
**Central Zoo Authority**  
(STATUTORY BODY UNDER THE MINISTRY OF ENVIRONMENT & FORESTS, GOVT. OF INDIA)

1 copy  
182  
8

Bikaner House, Annexe VI,  
Shahjahan Road, New Delhi - 110011  
website : <http://www.cza.nic.in>  
DATE: 22.7.2008

F. No. 19-99/92-CZA(250)(M)

To

The Principal Chief Conservator of Forests and Chief Wildlife Warden,  
Government of Tamil Nadu,  
1, Jeenis Road, Panagal Maaligai,  
Chennai - 15 (Tamil Nadu)

**Sub:- Development of Kurumbapatti Zoological Park, Salem - Regarding.**

Sir,

Please refer to your letter No. WL.25944/ 2007 dated 10.7.2008.

The proposed designs for the construction of animal enclosures at the Kurumbapatti Zoological Park, Salem were placed before the 5<sup>th</sup> Meeting of the Expert Group on Zoo Designing held on 15<sup>th</sup> July, 2008 and the following observations are being made:—

**(i) Revised design for the construction of enclosure for Spotted deer**

The design was approved subject to the condition that the cattle proof trench is found to be too narrow, therefore, the Spotted deer may escape from the enclosure. It is suggested that chain-link mesh fence of 2 meter high should be provided even on the visitors' side instead of cattle proof trench.

**(ii) Revised design for the construction of enclosure for Sambar**

As the Blackbuck are not in collection of the Kurumbapatti Zoo, the design was approved for housing the Sambar subject to the condition that the cattle proof trench is found to be too narrow, therefore, the Sambar may escape from the enclosure. It is suggested that chain-link mesh fence of 2 meter high should even be provided on the visitors' side instead of cattle proof trench.

**(iii) Revised design for the construction of enclosure for Marsh crocodile**

The design was approved.

Yours faithfully,  
sd/-  
(B. R. Sharma)  
Member Secretary

Copy to the District Forest Officer, Salem Forest Division, Salem - 636 007 for favour of information & necessary action.

131  
(B. R. Sharma)  
Member Secretary

AC  
...  
...

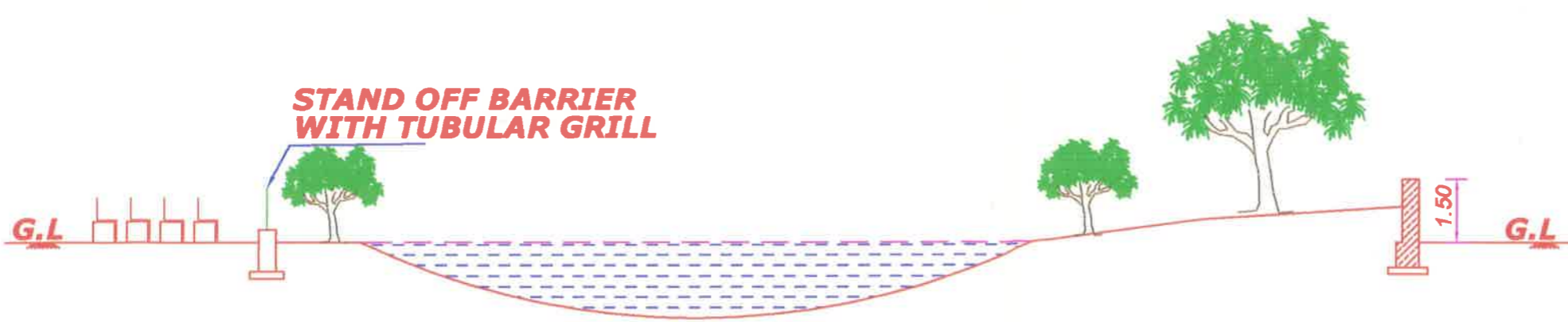
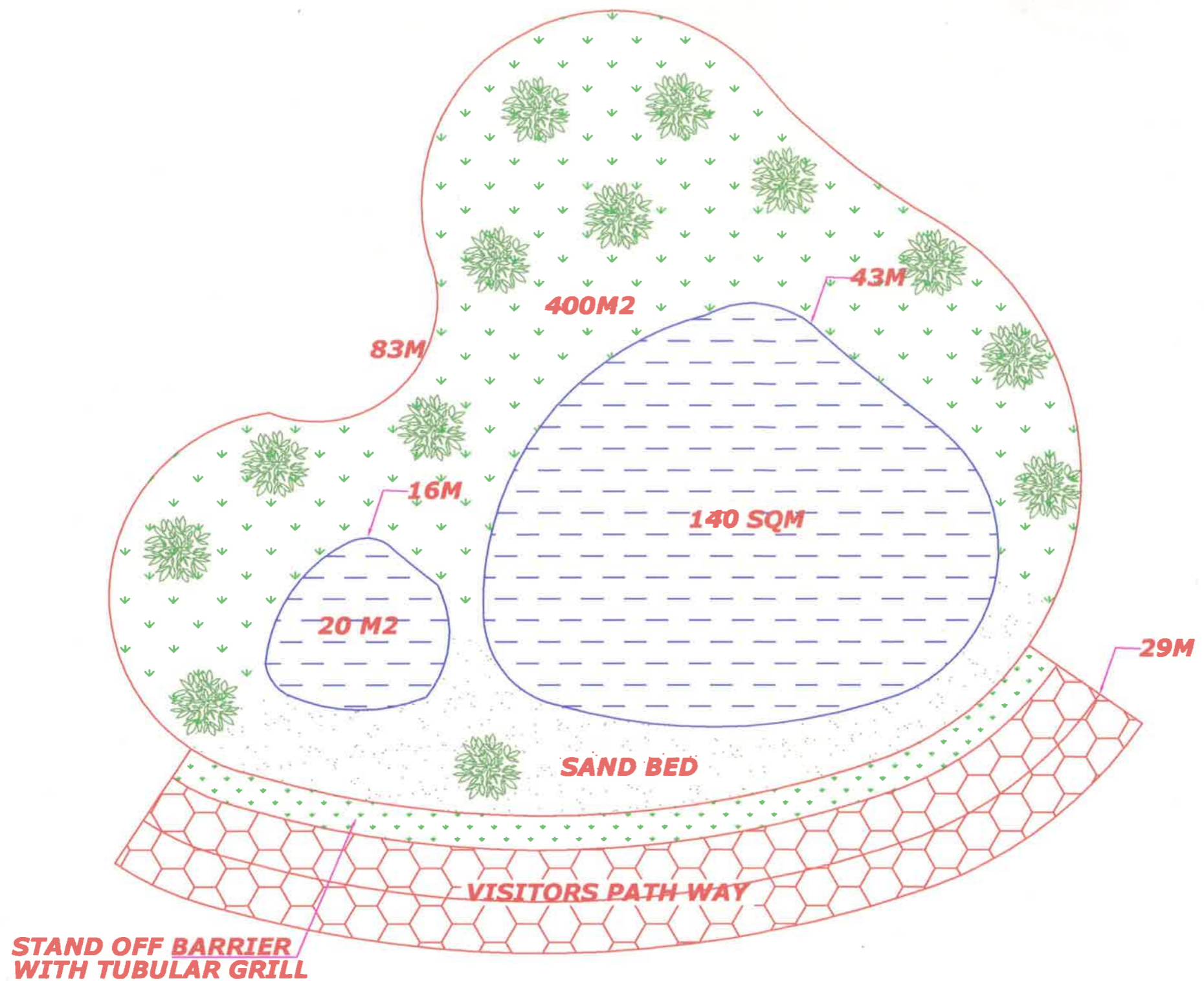

**CROSS SECTION**

**DRAWING NO:5  
PROPOSED ENCLOSURE FOR  
MARSH CROCODILE**

**KURUMBAPATTY MINI ZOO,  
SALEM DIVISION.**

**NOTE:  
ALL DIMENSION ARE  
IN METRES.**

**SCALE:- 1:100**

**ANIMAL SEX RATIO = 1 : 1**

**AREA DETAILS:**

	SQ.M
TOTAL AREA:	400
WATER BODY :	150

**STAND OFF BARRIER :  
WITH TUBULAR PIPES 1.M HT.**

**SPECIFICATION :  
P.C.C 1:4:8; FOR FOUNDATION.  
R.R.MASONRY IN C.M. 1:5.**

**RECYCLING PLANT  
TO BE PROVIDED**

*[Signature]*  
Principal Chief Conservator of Forests  
and  
Chief Wildlife Warden  
Chennai-600 015.

*[Signature]*  
FOREST RANGER  
Kurumbapatty Zoological Park  
SALEM.