



जहाँ है हरियाली।
वहाँ है खुशहाली।।



GOVERNMENT OF INDIA
MINISTRY OF ENVIRONMENT & FORESTS
Central Zoo Authority

162



Through Fax

F. No. 19-45/92-CZA(328)(Vol. V)(M)

DATE: 04.05.2010

To

The Director
Zoological Garden,
Alipore,
Kolkata - 700 027 (West Bengal).

39

Sub:- Construction of a Coast Crocodile Enclosure and Aviary at Zoological Garden, Alipore, Kolkata, West Bengal – Regarding.

Sir,

Reference is invited to your letter No. 6 dated 04.04.2010.

The designs of the construction of a Coast crocodile enclosure and Aviary at Zoological Garden, Alipore were placed before the 14th Meeting of the Expert Group of Zoo Designing held on 5th & 6th April, 2010.

The members approved the design of the proposed Coast Crocodile Enclosure. For the proposed Aviary, the proposed island to be created in the aviary is not necessary as the existing land mass is adequate to provide natural environment for the birds to be housed. This refers visit of Member Secretary, Central Zoo Authority and Evaluation & Monitoring Officer, Central Zoo Authority to the Alipore Zoo on 30.04.2010. The existing water body and natural features of the site should not be disturbed. Necessary precaution should be taken up on the structural stability of the aviary.

Yours faithfully,

sd/-

(B. S. Bonal)

Member Secretary

Copy to the Chief Wildlife Warden, Government of West Bengal, Kolkata for favour of information.

Dr. Brij Kishor Gupta

(Dr. Brij Kishor Gupta)
Evaluation & Monitoring Officer

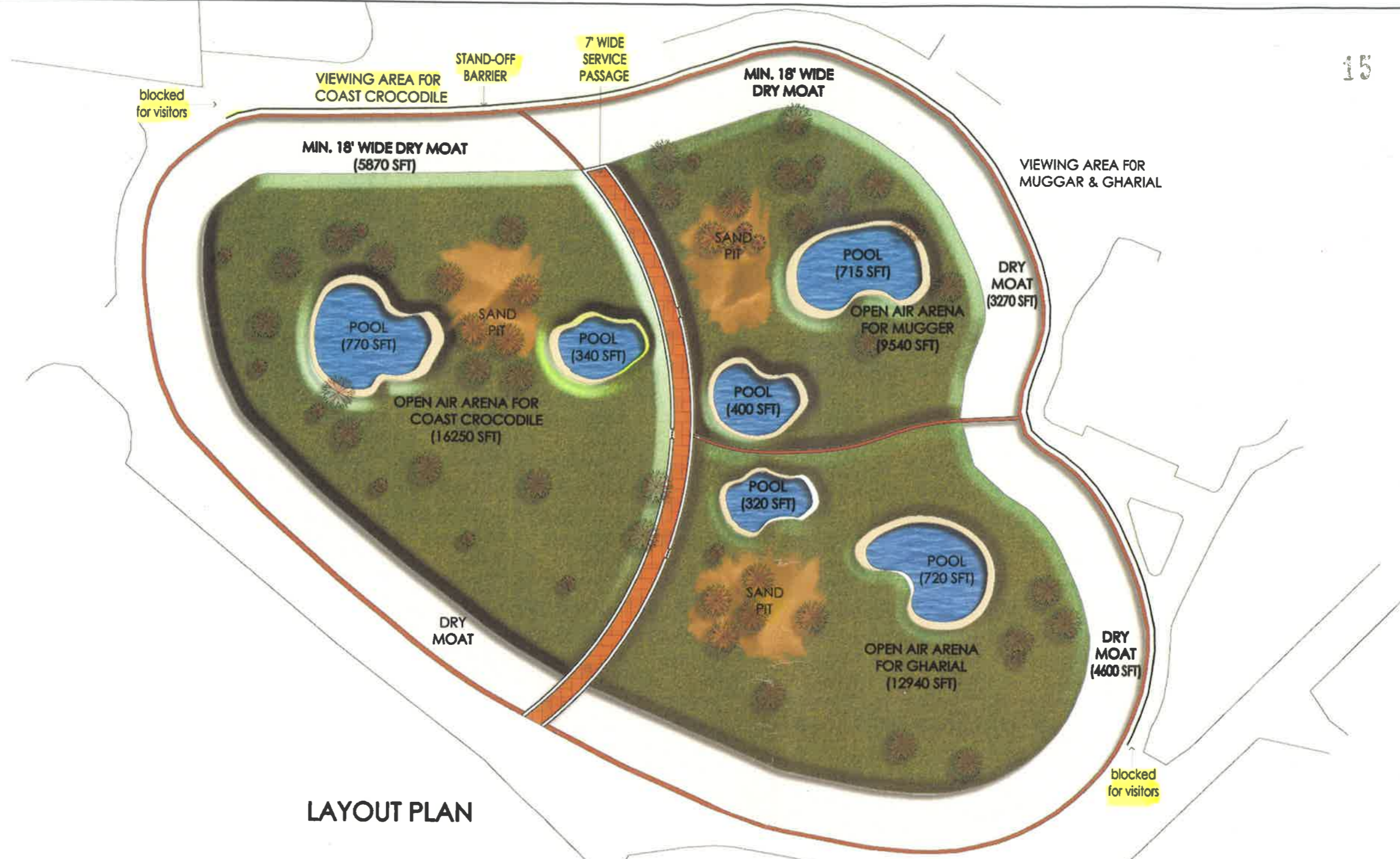

LAYOUT PLAN

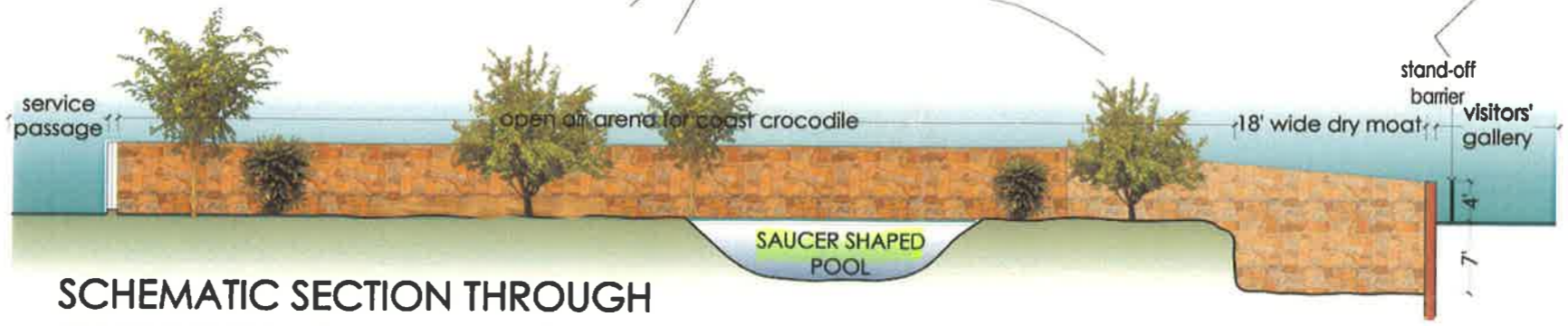

SCHEMATIC SECTION THROUGH ENCLOSURE FOR COAST CROCODILE

SCHEME PROPOSAL FOR DEVELOPMENT OF CROCODILE ISLAND
Alipore Zoological Garden, Kolkata

162/3

16

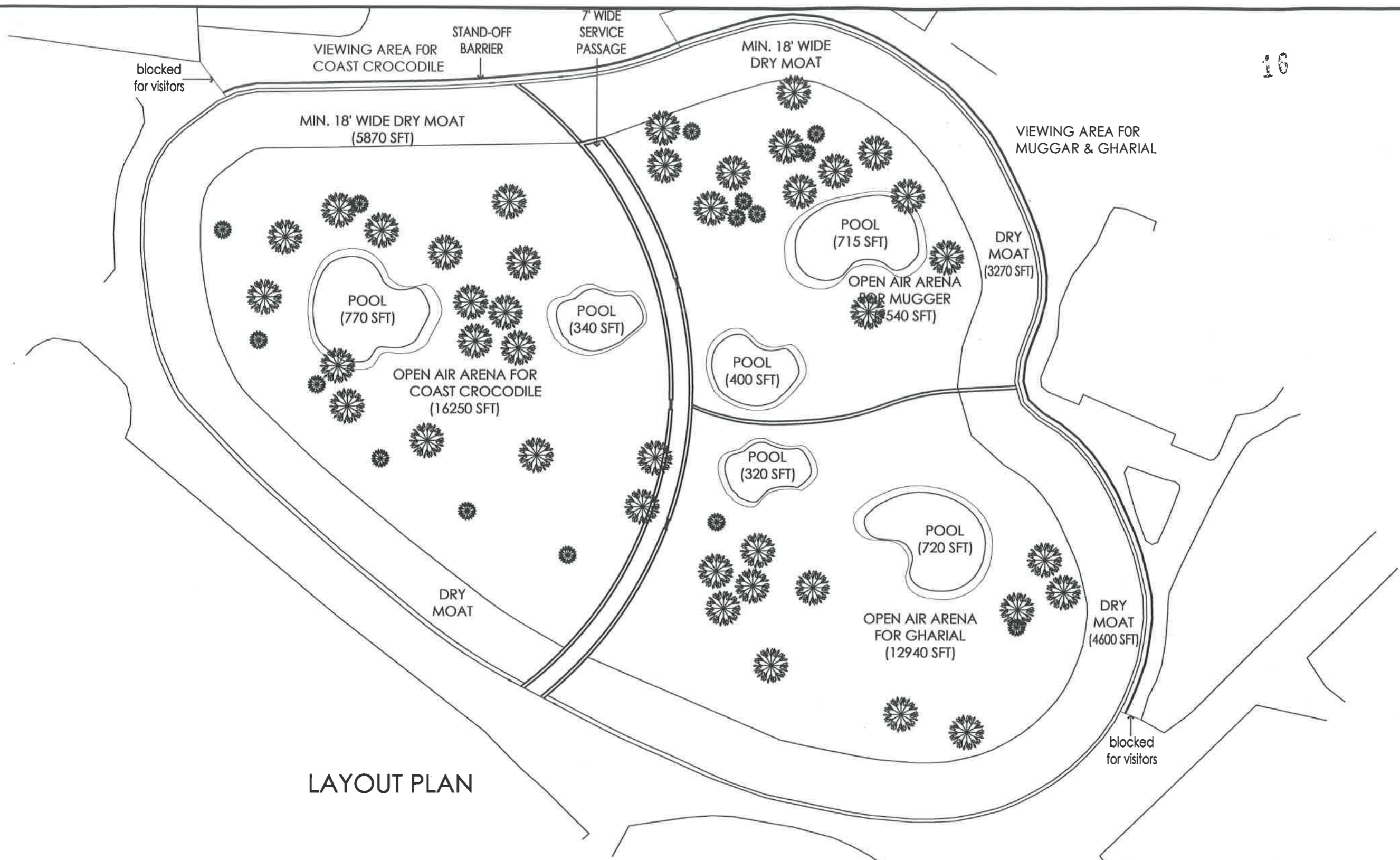

LAYOUT PLAN

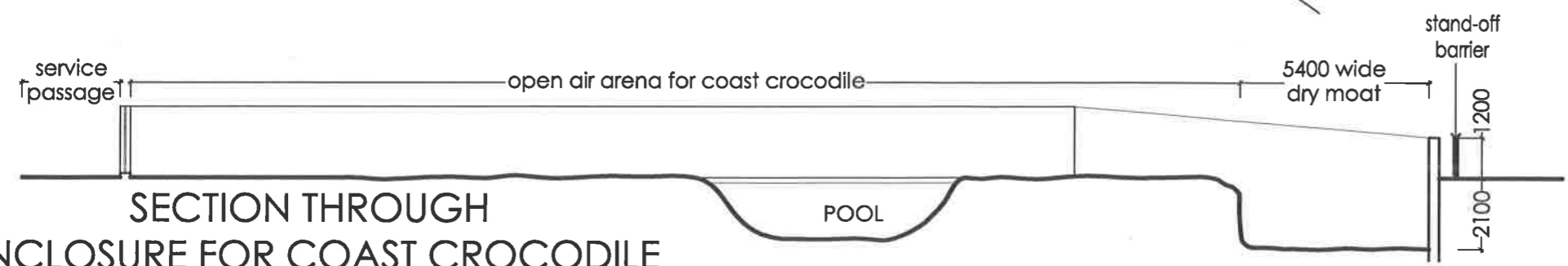

SECTION THROUGH ENCLOSURE FOR COAST CROCODILE

NOTE:
 1. ALL DIMENSIONS ARE IN MM. UNLESS STATED OTHERWISE.
 2. DIMENSIONS ARE TO BE READ, NOT TO BE MEASURED.
 3. ARCHITECTURAL DESIGN SCHEME AND STRUCTURAL DRAWINGS ARE TO BE REFERRED IN CONNECTION OF THIS DRAWING.