

V. **Himalayan Zoological Park, Gangtok, Sikkim**

Design for the construction of Rescue Centre at Himalayan Zoological Park, Gangtok

The design was scrutinized and not approved, however the following observations were made:-

- a) The species for which rescue centre is proposed to be mention.
- b) The design should have detail dimension.
- c) The rescue Centre should have provision of housing of animals only, rest of the facilities like healthcare, labs, store are not necessary. The zoo may use the existing facility at the zoo for the purpose.
- d) The design of rescue centre for leopards proposed at Malsi Deer Park, may be sent for the reference.

VI. **Jodhpur Zoo, Jodhpur, Rajasthan**

1. Porcupine

The design was scrutinized and approved subject to the condition that the floor of the exhibit should have enough soil and sand to meet the behavior requirement.

2. Spiny tail Lizard, Hedgehog, Monitor lizard and Smaller animal

The designs were scrutinized and not approved, however the following observations were made:-

- a) Instead of opening of Spiny tail lizard and Monitor lizard and hedgehog, it should be made in the form of reptile and nocturnal house covered on top.
- b) The reptile and nocturnal house should have proper ventilation, water circulation.
- c) Before preparing the design the zoo director may visit Kamla Nehru Zoological Garden, Ahmedabad to see the reptile house.

3. Desert cat, Desert fox, Common fox, Jungle cat, Jackal, Indian wolf, Bear and Striped hyena

All the design were scrutinized and approved subject to the following:

- a) Opening towards the keepers' gallery should be fully grilled and there should be no wall, including on the corners.
- b) Opening to paddock area through the sliding door.

122

Chain link Fence
50mm x50mmx8 g
(3 m high) on 375mm
th.& 600mm high Jodhpur
Stone Masonry wall with
60° inclined 1.5 m overhang
with MS sheet

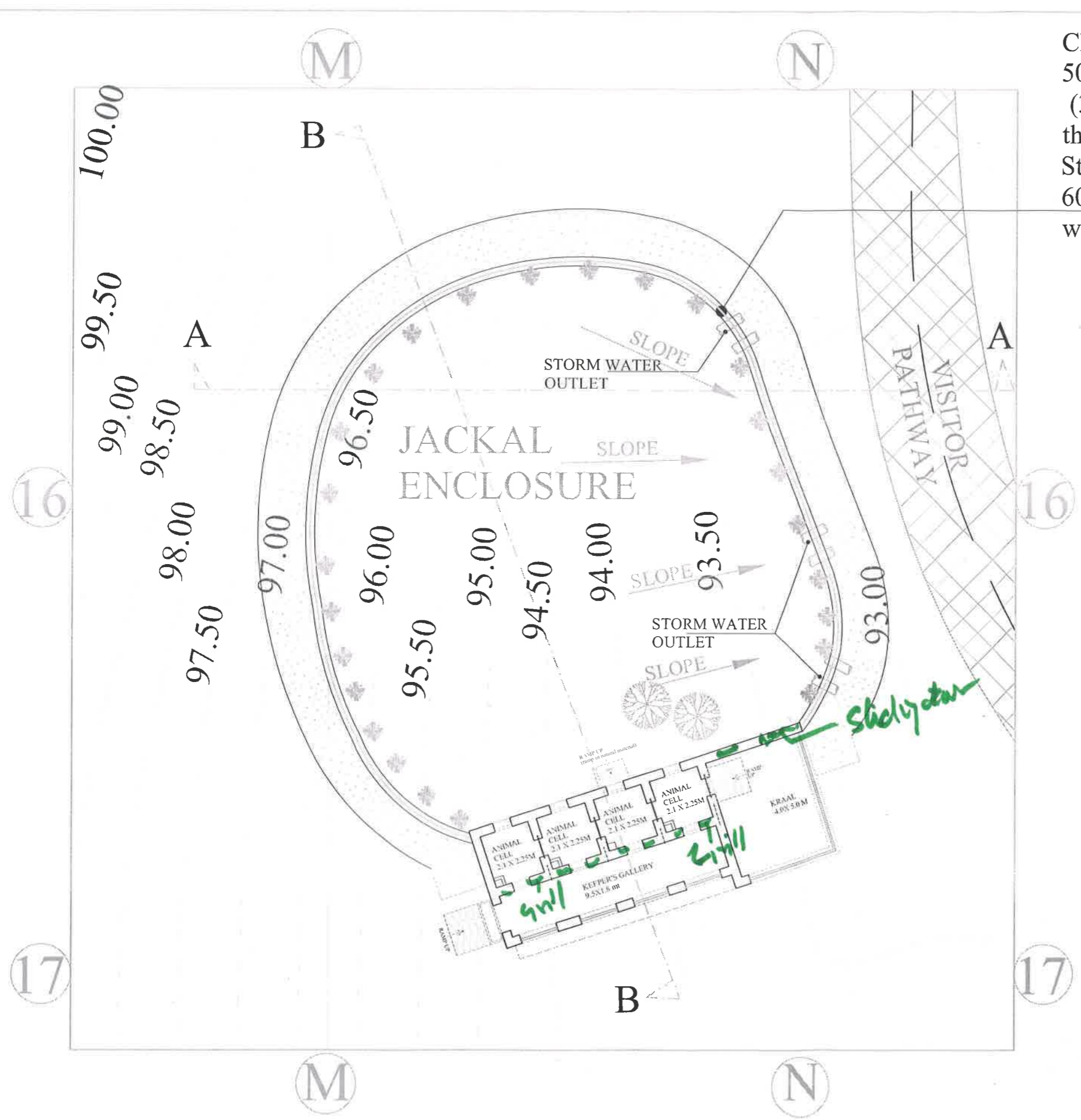

Handwritten notes in green ink:
Shelby
CAB 11 up to 6m on 2.0.1

Handwritten signature and stamp:
J. E.
P.M. Singhal
Project Officer
R.S.R.D.C. Ltd.
Unit-1 JODHPUR

P.M. JAIN
PROJECT DIRECTOR
RSRDC LTD,
JODHPUR
(एम.एस.राठीड)
वन वन संरक्षक
वन क्षेत्र, जोधपुर

PLAN GRID SIZE
20M X 20 M

AREA:- 394 SQ.MT.

JACKAL ENCLOSURE

PROJECT: PROPOSED SATELLITE MACHIA BIOLOGICAL PARK, JODHPUR	SHEET: RSRDC	NO. DATE REVISIONS 1 15/01/13 2 16/01/13 3 16/01/13 4 16/01/13 5 16/01/13 6 16/01/13 7 16/01/13 8 16/01/13	NO. DATE REVISIONS 1 16/01/13 2 16/01/13 3 16/01/13	PROPOSAL PLAN JACKAL ENCLOSURE	PREPARED BY: The FORMS, JAIPUR	DRAWN BY: POOJA SONI	PROJECTOR: Kavita Jain	ARCHITECT: The FORMS 4/11/13, 5/11/13, 6/11/13 7/11/13, 8/11/13, 9/11/13 10/11/13, 11/11/13, 12/11/13	ARCHITECTURAL CONSULTANT LANDSCAPE ARCHITECTURE	
	PREPARED BY: The FORMS, JAIPUR	DATE: 09 Jan, 2013	DRAWING NO.: Biopark Machia/JACKAL/01	SCALE: 1:100	PROJECTOR: Kavita Jain	ARCHITECT: The FORMS 4/11/13, 5/11/13, 6/11/13 7/11/13, 8/11/13, 9/11/13 10/11/13, 11/11/13, 12/11/13				

122

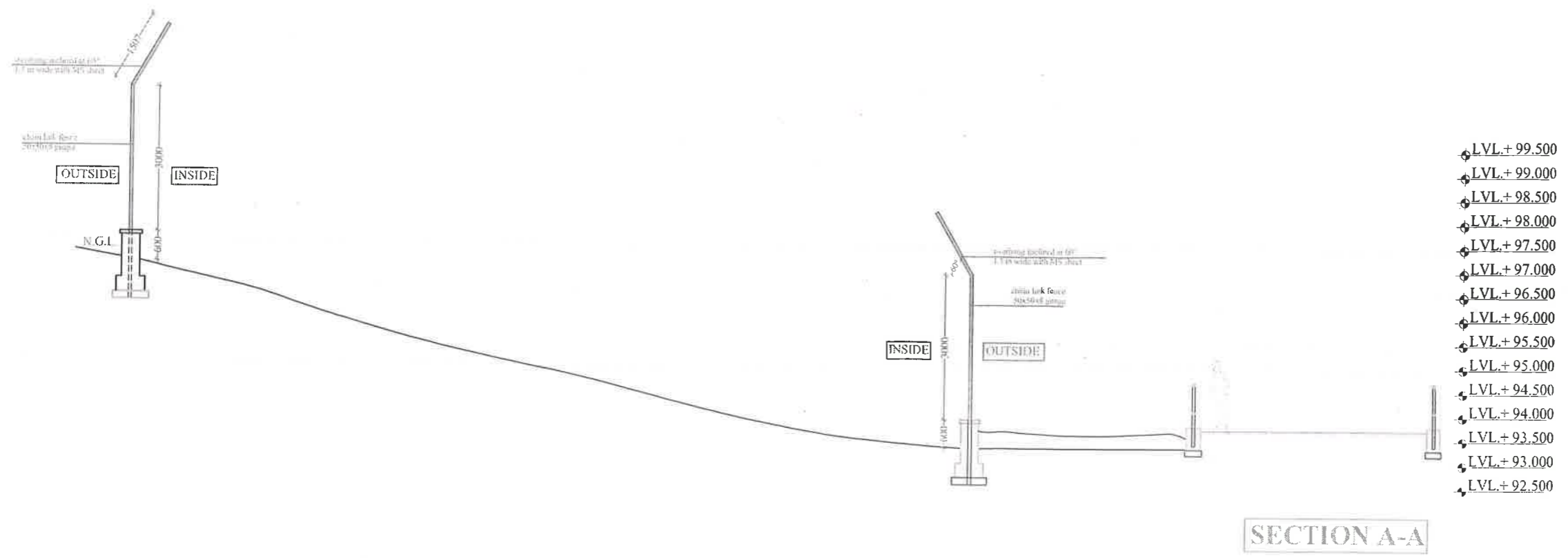

SECTION A-A

Handwritten signature and date: 2/2/14



SECTION B-B

(D.K. Singhal)
Project Officer
R.S.R.D.C. Ltd.
Unit -1 JODHPUR

(P.M. Jain)
PROJECT DIRECTOR
RSRDC LTD,
JODHPUR

(एम.एस.राठी)
छा वन संरक्षक
वन्य जीव, जोधपुर

JACKAL ENCLOSURE

PROPOSED SATELLITE MACHHA BIOLOGICAL PARK, JODHPUR	RSRDC	<table border="1"> <thead> <tr> <th>NO.</th> <th>DATE</th> <th>REVISIONS</th> </tr> </thead> <tbody> <tr><td>1</td><td>15.01.14</td><td>As per detail</td></tr> <tr><td>2</td><td>16.01.14</td><td>As per RSRDC approval</td></tr> <tr><td>3</td><td>18.01.14</td><td>As per RSRDC approval</td></tr> <tr><td>4</td><td>20.01.14</td><td>As per RSRDC approval</td></tr> <tr><td>5</td><td>03.01.15</td><td>As per RSRDC approval</td></tr> </tbody> </table>	NO.	DATE	REVISIONS	1	15.01.14	As per detail	2	16.01.14	As per RSRDC approval	3	18.01.14	As per RSRDC approval	4	20.01.14	As per RSRDC approval	5	03.01.15	As per RSRDC approval	<table border="1"> <thead> <tr> <th>NO.</th> <th>DATE</th> <th>REVISIONS</th> </tr> </thead> <tbody> <tr><td>1</td><td>20.01.14</td><td>As per RSRDC approval</td></tr> <tr><td>2</td><td>22.01.14</td><td>As per RSRDC approval</td></tr> <tr><td>3</td><td>24.01.14</td><td>As per RSRDC approval</td></tr> <tr><td>4</td><td>26.01.14</td><td>As per RSRDC approval</td></tr> <tr><td>5</td><td>28.01.14</td><td>As per RSRDC approval</td></tr> </tbody> </table>	NO.	DATE	REVISIONS	1	20.01.14	As per RSRDC approval	2	22.01.14	As per RSRDC approval	3	24.01.14	As per RSRDC approval	4	26.01.14	As per RSRDC approval	5	28.01.14	As per RSRDC approval	PROPOSAL SECTION: JACKAL ENCLOSURE Checked by: Kavita Jain DATE: 09 Jan 2013 Drawing No: Bhopur-Machha-FACTAL-02	JACKAL ENCLOSURE Made by: POJOA SONI SCALE: 1:100	CONSULTANT: Kavita Jain The 'FORMS' JODHPUR	Architecture Conservation Landscape Interiors	
	NO.	DATE	REVISIONS																																									
1	15.01.14	As per detail																																										
2	16.01.14	As per RSRDC approval																																										
3	18.01.14	As per RSRDC approval																																										
4	20.01.14	As per RSRDC approval																																										
5	03.01.15	As per RSRDC approval																																										
NO.	DATE	REVISIONS																																										
1	20.01.14	As per RSRDC approval																																										
2	22.01.14	As per RSRDC approval																																										
3	24.01.14	As per RSRDC approval																																										
4	26.01.14	As per RSRDC approval																																										
5	28.01.14	As per RSRDC approval																																										
The 'FORMS', JAIPUR																																												

Vertical Sliding Animal Cell Door
(750mm x 900mm) With
5mm M S Angle Frame with
25 mm Ø bars at 75mm c/c

RAMP UP
(ramp in natural material)

Vertical Sliding Animal Cell Door (750mm x
900mm) With 5mm M S Angle Frame with 25
mm Ø bars at 75mm c/c

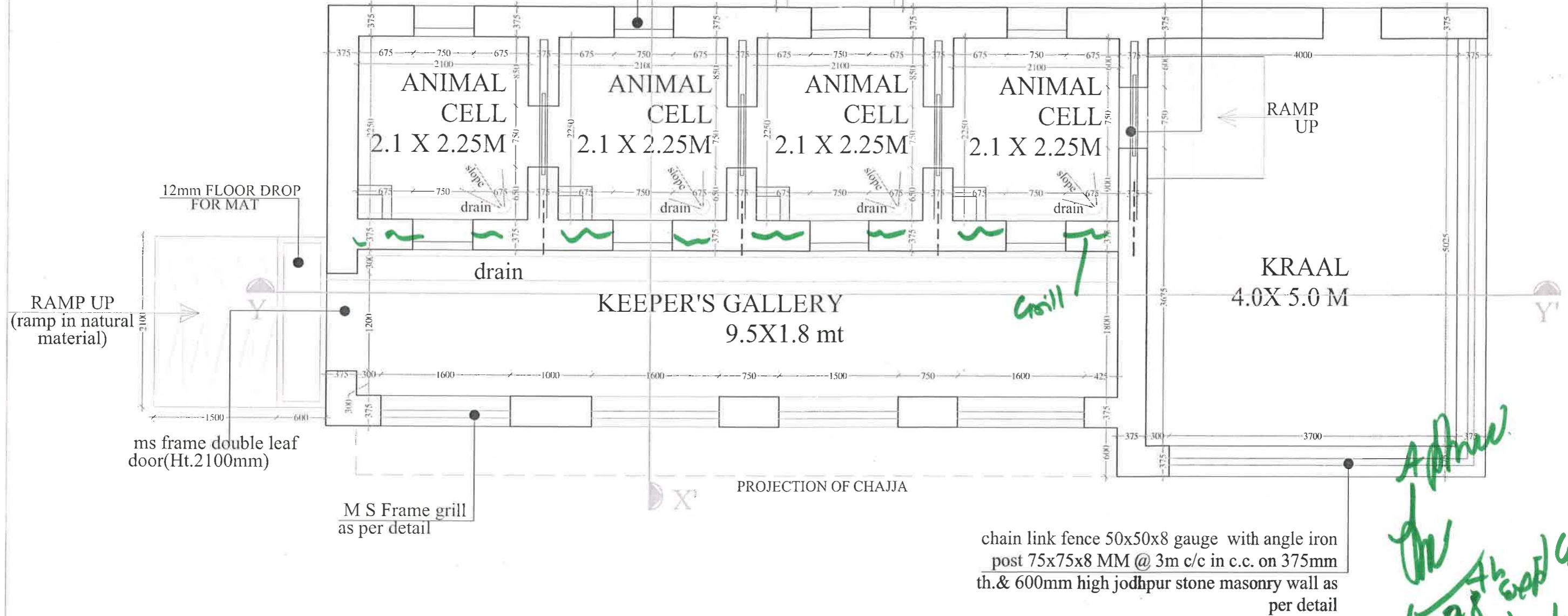

chain link fence 50x50x8 gauge with angle iron
post 75x75x8 MM @ 3m c/c in c.c. on 375mm
th. & 600mm high jodhpur stone masonry wall as
per detail

Aphar
Grill
(48' x 60' x 2')
3/2/14

Jitendra J. E.
(D.K. Singhal)
Project Officer
R.S.R.D.C. Ltd
Unit-1 JODHPUR

P.M. JAIN
PROJECT DIRECTOR
RSRDC LTD.
JODHPUR

(एन.एन.सतीश)
उप वन संरक्षक
वन्य जीव, जोधपुर

HOLDING AREA/NIGHT
SHELTER PLAN
JACKAL ENCLOSURE

PROJECT PROPOSED SATELLITE MACHHA BIOLOGICAL PARK, JODHPUR.	SHEETS RSDRC	PREPARED BY The 'FORMS', JAIPUR	NO.	DATE	REVISIONS	NO.	DATE	REVISIONS
			1	12.11.13	1	12.11.13	1	12.11.13
			2	12.11.13	2	12.11.13	2	12.11.13
			3	12.11.13	3	12.11.13	3	12.11.13
			4	12.11.13	4	12.11.13	4	12.11.13
			5	12.11.13	5	12.11.13	5	12.11.13
			6	12.11.13	6	12.11.13	6	12.11.13
			7	12.11.13	7	12.11.13	7	12.11.13
			8	12.11.13	8	12.11.13	8	12.11.13

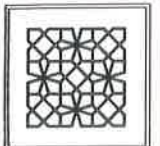

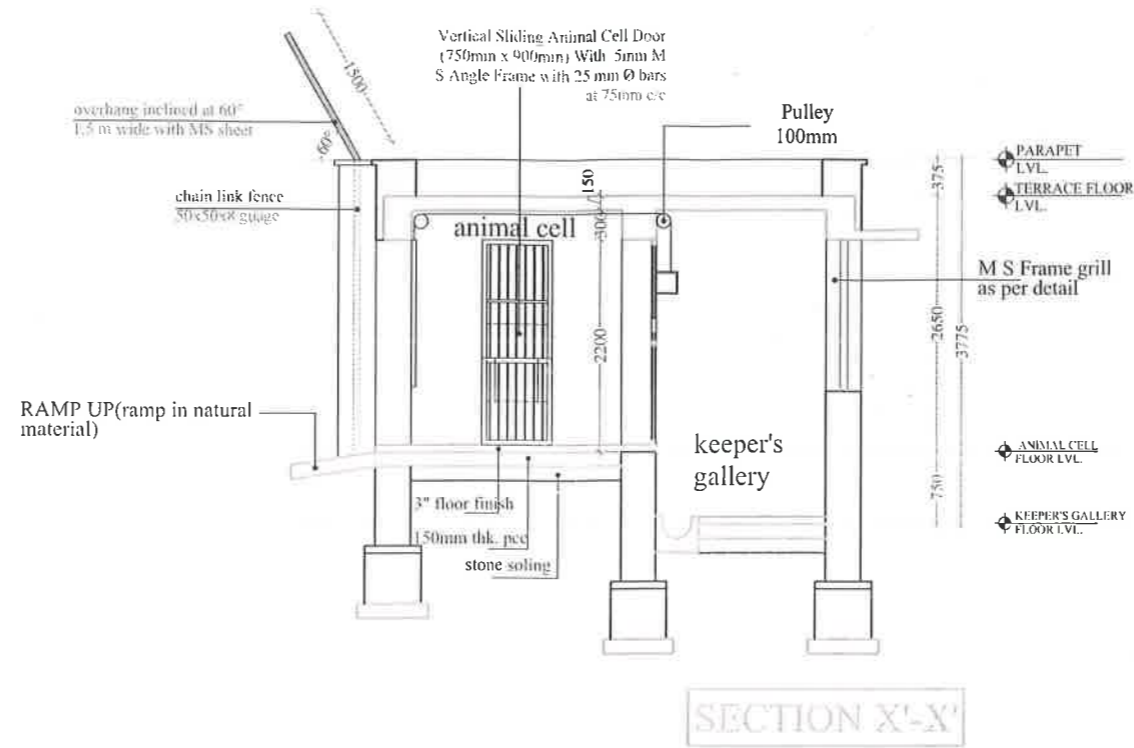

Handwritten signature in green ink.



Handwritten signature in purple ink.

Handwritten signatures and stamps:
 Jitendra J.C.
 P.M. JAIN PROJECT DIRECTOR RSRDC LTD, JODHPUR
 R.S.R.D.C. Ltd.

HOLDING AREA/NIGHT SHELTER SECTIONS JACKAL ENCLOSURE

PROPOSED SATELLITE MACHIA BIOLOGICAL PARK, JODHPUR RSRDC The 'FORMS', JAIPUR	NO. 1 DATE 11.01.19	REVISIONS 1. 11.01.19	BY J.C.	DATE 11.01.19	CHECKED BY P.M. JAIN	AREA/NIGHT SHELTER SECTIONS JACKAL ENCLOSURE Made by - POOJA SONI	PROJECT TITLE Kovita Jain THE FORMS RSRDC LTD, JODHPUR THE 'FORMS', JAIPUR	SCALE 1:75	DATE 09 Jan 2017	DRAWING NO. Bspark-Machia-JACKAL-04
	NO. 2 DATE 12.11.19	REVISIONS 2. 12.11.19	BY J.C.	DATE 12.11.19	CHECKED BY P.M. JAIN	AREA/NIGHT SHELTER SECTIONS JACKAL ENCLOSURE Made by - POOJA SONI	PROJECT TITLE Kovita Jain THE FORMS RSRDC LTD, JODHPUR THE 'FORMS', JAIPUR	SCALE 1:75	DATE 09 Jan 2017	DRAWING NO. Bspark-Machia-JACKAL-04

